

LIFT TYPE DISK HARROW

ATHENS MODEL 37

37

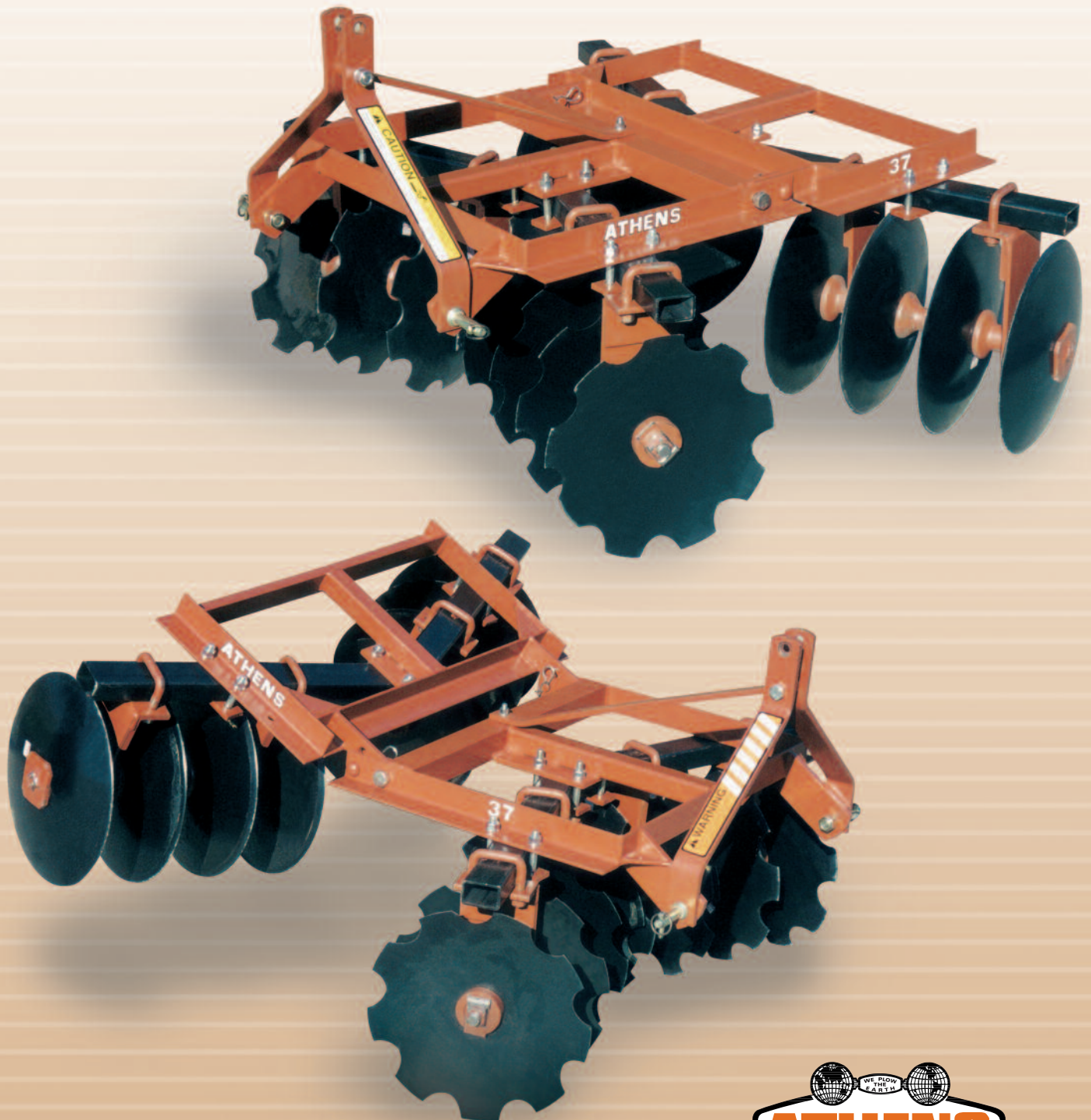

MODEL 37



"WE PLOW THE EARTH"

SPECIFICATIONS

WIDTH OF CUT	NUMBER OF DISCS	NUMBER OF BEARINGS	APPROX. WEIGHT (lbs.)	*APPROX. DBHP
5' 2"	16	8	640	22
6' 3"	16	8	670	25
6' 5"	18, 20	8	722	25

* Approximate DBHP is only given as a guide. Extremely hard, soft, hilly or boggy conditions will change these figures.



Weight per blade ranges from 35-42 pounds.
Above: The Rear Frame is pinned up to increase the weight on the front gangs for the initial pass.



The Athens Model 37 is ideal for orchards and vineyards. Its compact design allows easy lifting, straight pulling and excellent maneuverability in small fields and around close objects.

Standard Equipment

- Category I Hitch
- 1" Square C1045 Steel Axle
- Factory Assembled Disc Gangs
- Triple-Lip Sealed Ball Bearings
- Adjustable Angle of Cut, 4° or 19°

Optional Equipment

- 18" Disc Blades, Smooth or Cutout
- Disc Spacing, 7", 9", or 9" Front and 7" Rear

Features

Frame Design

The front and rear frame of the Athens 37 is constructed of angle and steel tubing, welded into a unitized assembly for strength and durability. The rear frame can be pinned in the up position to increase the weight on the front gangs for the initial pass.

Hitch

Category I Hitch is ideal for small tractors with 20-30 HP. The hitch is securely braced and rigidly connected to the frame.

Disc Gangs

Gangs are assembled in the factory and tightened to 750 foot pounds. Sturdy 2" x 3" steel tubing is used for the gang frames. Rigid bearing hangers hold bearings in perfect alignment and insure gang rigidity for free turning discs.

Disc Blades

The disc blades are made from the highest quality steel for strength and durability. Made in the USA.

ATHENS

MODEL 47

LIFT TYPE DISK HARROW

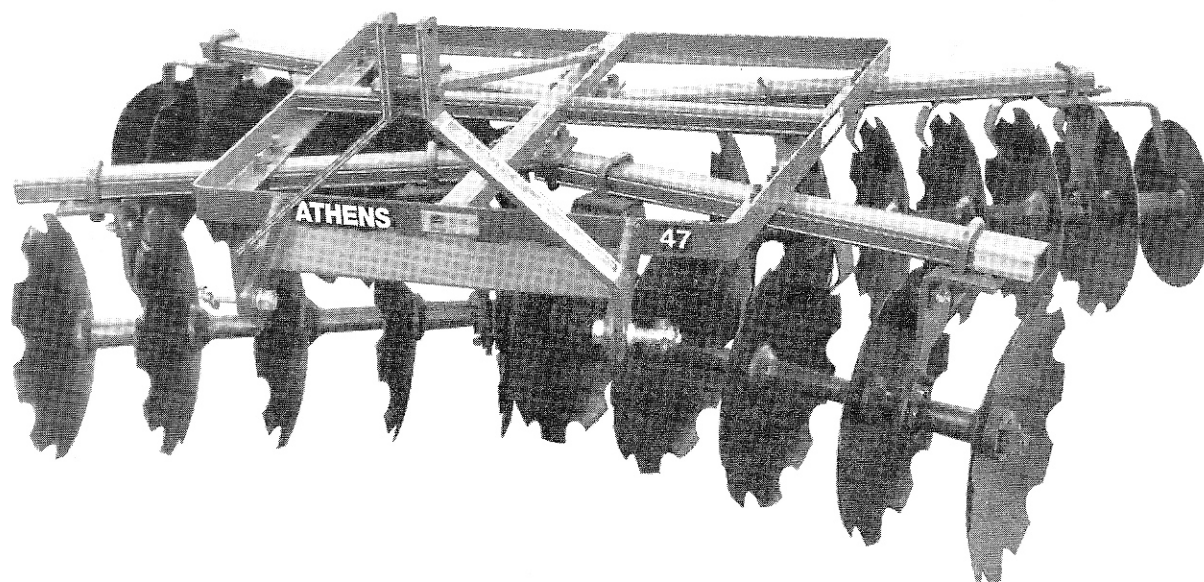

THE 47 IS THE NEWEST OF THE ATHENS THREE POINT DISKS. PROVEN AS A FINISHING, INCORPORATING, MULCHING AND FRESHENING HARROW, THE 47 IS IDEAL FOR WEEKENDERS, FARMERS, ORCHARDISTS, AND VINEYARDISTS. IT'S TOTALLY ATHENS IN EVERY SENSE OF THE WORD.



ATHENS PLOW COMPANY, INC.

P. O. BOX 609

ATHENS, TENNESSEE 37371-0609

47 LIFT TYPE DISK HARROW

SPECIFICATIONS

WIDTH OF CUT	NO. OF DISKS	NUMBER OF BRGS.	APPROX WEIGHT	DBHP
6'3"	16	8	692	25
6'5"	18, 20	8	735	25
7'6"	22, 24	8	812	30
7'9"	20	8	772	30

Number of disks vary with the combination of spacing. 7", 9", or 9" front 7" rear.

STANDARD EQUIPMENT:

CATEGORY 1 HITCH
1" SQUARE C1045 STEEL AXLE
FACTORY ASSEMBLED DISK GANGS
TRIPLE-LIP SEALED BALL BEARINGS
ADJUSTABLE ANGLE OF CUT

OPTIONAL EQUIPMENT:

18" OR 20" DISK BLADES, CUTOUT
OR SMOOTH
DISK SPACING, 7", 9" OR 9" FRONT
AND 7" REAR.

EXTRA EQUIPMENT:

DISK SCRAPERS

FEATURES

CATEGORY 1 HITCH WHICH IS BRACED
AND SECURED TO THE WELDED FRAME.

FACTORY ASSEMBLED GANGS.

STURDY 2"x3" STEEL TUBING USED FOR THE
GANG FRAMES. GANGS CAN BE ADJUSTED
FOR CUTTING ANGLES FROM 15° TO 20°.

ATHENS PLOW CO., INC. guarantees each piece of equipment
against defective materials and workmanship for a period of one
year from the date of delivery to the purchaser unless otherwise
specified.

ATHENS PLOW CO., INC. reserves the right to make changes
and/or improvements in design and construction of parts or ma-
chines without notice or obligation.

HEAVY-DUTY BEARING HANGERS.

RIGID BEARING HANGERS HOLD BEARINGS
IN **PERFECT** ALIGNMENT AND ASSURE GANG
RIGIDITY FOR FREE TURNING DISKS.

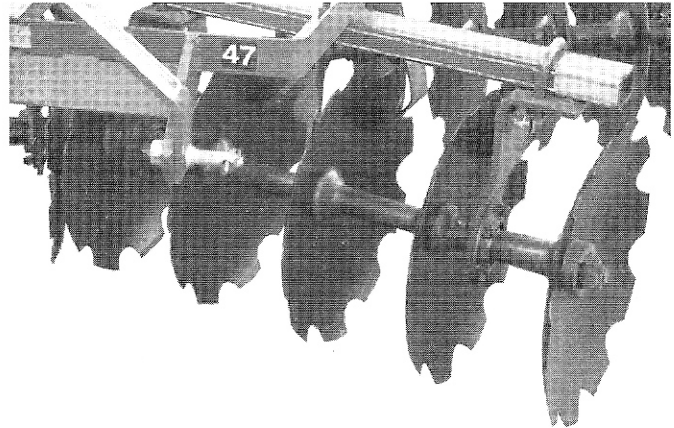

SELF-ALIGNING, FLANGETTE-MOUNTED,
SEALED BALL BEARINGS, FEATURE
TRIPLE-LIP SEALS THAT NEVER NEED
LUBRICATION AND PROVIDE LONG LIFE,
AND LOW MAINTENANCE.

FRAME DESIGN.

THE RUGGED FRAME OF THE ATHENS
47 IS CONSTRUCTED OF ANGLE AND
STEEL TUBING THAT IS WELDED INTO
A UNITIZED ASSEMBLY FOR STRENGTH
AND DURABILITY.

CHOICE OF DISKS.

18" OR 20" CUTOUT OR SMOOTH DISK
BLADES ARE SPACED 7", 9", OR
9" ON FRONT AND 7" ON REAR ARE
OFFERED ON THE MODEL 47. CAST
IRON SPACERS AND HALF SPACERS ARE
ARBOR-MACHINED ON BOTH ENDS
FOR A PRECISE FIT WITH THE DISKS
AND BEARINGS.

ATHENS PLOW COMPANY, INC.

P. O. BOX 609

ATHENS, TENNESSEE 37371-0609

ATHENS

MODEL 52



"WE PLOW THE EARTH"

The Athens Model 52 is the perfect choice for compact tractor owners, gardeners, weekenders, and small wildlife food plots. This lift-type tandem disc harrow is available in 6' 6", 7' 0", 7' 11", and 8' 2" widths and its compact design allows for easy lifting, straight pulling, and excellent maneuverability.

www.athensplowcompany.com

MODEL 52 SPECIFICATIONS

WIDTH OF CUT	NUMBER OF DISCS	DISC SPACING		NUMBER OF BEARINGS	*APPROX HP	APPROX WEIGHT (lbs.)
		FRONT	REAR			
6' 6"	16	9"	9"	8	35 - 40	868
7' 0"	18 20	9" 7 ½"	7 ½" 7 ½"	8	40 - 45	938
7' 11"	20	9"	9"	8	45 - 50	982
8' 2"	22 24	9" 7 ½"	7 ½" 7 ½"	8	45 - 55	1021

*Approximate Horse Power (HP) is only a guide. Extremely hard, soft, or boggy conditions will change these figures.

STANDARD EQUIPMENT

- Disc Blades, 18" or 20" Diameter
- Relube Quadriseal Ball Bearings
- 1 1/8" Square Cold Rolled Axle
- Spacing, 9", 7 ½", or 9" Front & 7 ½" Rear
- Adjustable Angle of Cut: 15° or 18°
- Gang Wrench
- Cat. I Hitch Free Link

OPTIONAL EQUIPMENT

- Scrapers
- Cover Discs
- Cat. II Hitch Free Link

DISC BLADES

Available in 18" and 20" diameter sizes. Choose between Smooth or Cutout. Smooth Blades are best utilized in normal field conditions. They are more economical, last longer, weigh more, and wear more evenly, thus staying sharper longer. Cutout blades are more aggressive and trap residue better than smooth blades.



FEATURES

The Main Frame is constructed of ¼" thick steel tubing and ½" thick angle which is truss-braced and reinforced to resist twisting and bending. Compact design allows for easy lifting, straight pulling, and excellent maneuverability in small fields and around close obstacles.

Axles are made from 1 1/8" square cold rolled steel to insure straightness and to keep bearings and disc in alignment.

Gang Frames are constructed from 3 x 3 x ¼" structural steel tubing.

Flangette Ball Bearings on the 52 are greaseable and have triple lip seals.

Angle of Cut adjustments can be made from 15° to 18° depending on your need for penetration and aggression.



Athens Plow Co., Inc. guarantees each piece of equipment against defective materials and workmanship for a period of one year from the date of delivery to the purchaser unless otherwise specified. Athens Plow Co., Inc. reserves the right to make changes and/or improvements in design and construction of parts or machines without notice or obligation.

Athens Plow Company, Inc. • PO Box 609 • Athens, TN 37371-0609

ATHENS

MODEL 55 MOUNTED DISK HARROW

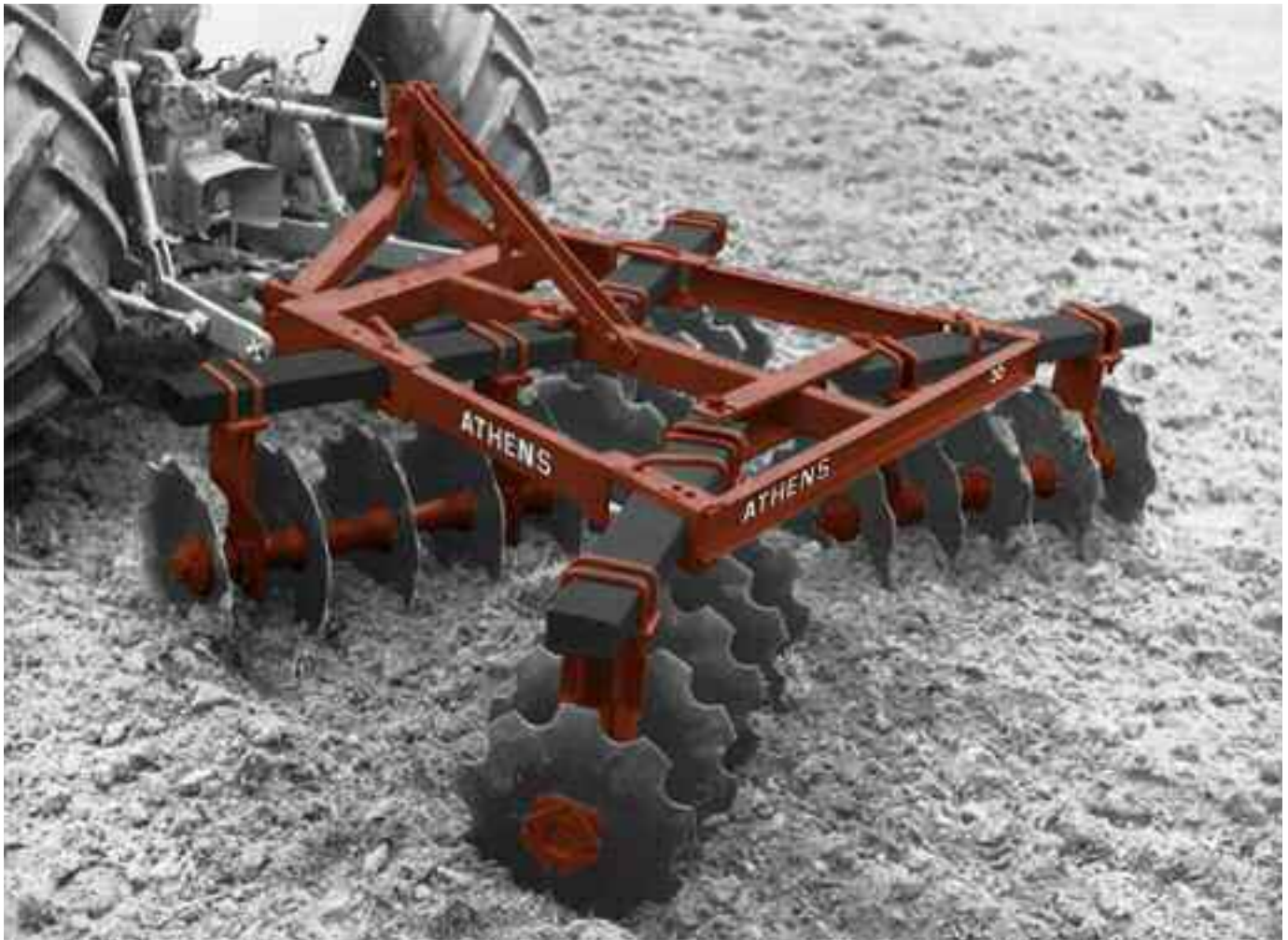

When it comes to rugged dependability and unsurpassed field performance, the Athens "55" is tops in its class!

This brawny, fully-mounted tandem has the weight (average 55# per disk) and strength to chop through stalks and stubble with ease...Plus quick and easy adjustments to provide excellent incorporation and seedbed finishing.



ATHENS PLOW COMPANY, INC.

P.O. BOX 609

ATHENS, TENNESSEE 37371-0609

WWW.ATHENSPLOWCOMPANY.COM

55 MOUNTED DISK HARROWS



SPECIFICATIONS

Width of Cut	No. of Disks *	Approx. Weight
6' 6"	16	1104
7' 0"	18/20*	1188
7' 11"	20	1242
8' 2"	22/24*	1321
9' 4"	24/26/28*	1456

* Number of disks vary with the combination of spacing 7½", 9", or 9" front and 7½" rear.

STANDARD EQUIPMENT:

- Category II Hitch
- 1 ⅝" Cold Rolled Square Steel Axle
- Disk Gang Wrench
- Tapered Outside Rear Disk Gangs
- Adjustable Angle of Cut
- Flangette Bearing Hangers
- Relube Ball Bearings

OPTIONAL EQUIPMENT:

- Category I or II Hitch
- 20" or 22" Disk Blades Cut Out or Smooth
- Disk Spacing—7½", 9" or 9" Front and 7½" Rear

EXTRA EQUIPMENT:

- Heavy Duty Scraper Blades
- Balk Buster
- Cover Disk

FEATURES

RUGGED 3" x 5" GANG FRAME TUBES.
Provides rigid support for bearing hangers and gang components.

HEAVY-DUTY BEARING HANGERS.
Rigid bearing hangers hold bearings in PERFECT alignment and assure gang rigidity for free turning disks. Hangers are secured to gang frames with heavy duty ⅝" U bolts.

RELUBE BALL BEARINGS.

The bearings are shroud protected, heavy-duty, flangette type and have triple lip seals.

FACTORY ASSEMBLED GANGS.

Gangs are tightened to 750 foot pounds, and locked securely with slotted nuts and cotter pins.

ADJUSTING ANGLE OF CUT.

Adjusting is fast and easy from 13° to 21° in 4° increments to provide deeper penetration and more aggressive cutting and mixing action. Gangs adjust individually without tools by removing only one pin per gang. Disk gangs can be shim-leveled individually side-to-side.

CHOICE OF DISKS.

You may chose from 20" or 22" disk blades in either smooth or cut out. All are high quality alloy steel for long life.

SPACER AND BEARING SPOOLS.

Made from high strength cast iron to exacting specifications. The large flanged ends support more disk area and are arbor machined to assure a snug fit and precise bearing alignment.

FRAME DESIGN.

Compact, close-coupled design allows easy lifting, straight pulling, and excellent maneuverability in small fields and around close obstacles.

EXTRA EQUIPMENT FEATURES SCRAPERS.

Heavy-duty scraper arms and knife-type blades provide maximum cleaning and clearance of trash.

COVER DISKS.

Easily bolts on to outside rear gangs to remove ridges and furrows left by the front gang.

BALK BUSTER.

Bolts on to main frame between the front gangs to cut out the ridge normally left between the front gangs. Made of ¾" x 2" alloy steel.

UNITIZED FRAME.

Constructed from 4" channel and 4" x 4" steel tubing. Reinforced and truss braced to resist twisting and bending loads.

ATHENS PLOW CO., INC. guarantees each piece of equipment against defective materials and workmanship for a period of one year from the date of delivery to the purchaser unless otherwise specified.

ATHENS PLOW CO., INC. reserves the right to make changes and/or improvements in design and construction of parts or machines without notice or obligation.

ATHENS PLOW COMPANY, INC.

P.O. BOX 609

ATHENS, TENNESSEE 37371-0609

WWW.ATHENSPLOWCOMPANY.COM

ATHENS

MODEL 65



The Model 65 is ideal for wildlife applications and management. This lift-type tandem disc harrow is available in 8' 0", 8' 4", and 9' 6" widths making it the perfect choice for plantations and ranches.



"WE PLOW THE EARTH"



STANDARD EQUIPMENT

- Disc Blades, 22" or 24" Diameter
- Relube Quadraseal Ball Bearings
- Rigid Bearing Hangers with Wear Plates
- 1.25" Square Cold Rolled Axle
- Spacing, 9" or 9" Front & 7.5" Rear
- Adjustable Angle of Cut: 15°, 18° or 21°
- Gang Wrench

OPTIONAL EQUIPMENT

- Spring Bearing Hangers with Wear Plates
- Scrapers
- Cover Discs
- Balk Buster

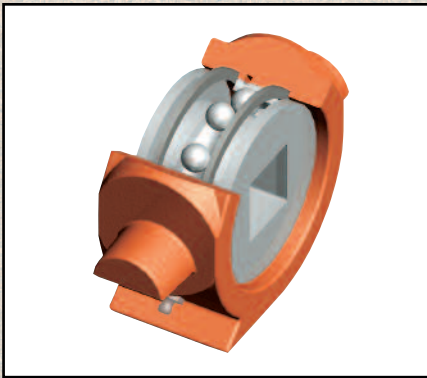

Quadraseal Ball Bearings

Strong relube QUADRASEAL ball bearings on the Model 65 mean long life and less downtime.

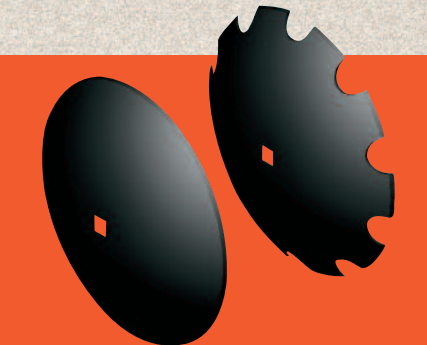

DISC BLADES

Available in 22 and 24 inch sizes. Athens Plow offers tailored solutions to meet your disking needs.

Smooth blades are best utilized in normal field conditions. They are more economical, wear longer, weigh more than cutout blades, and cut crop residue evenly.

Cutout blades are more aggressive and trap residue better than smooth blades.

MODEL 65 SPECIFICATIONS

WIDTH OF CUT	NUMBER OF DISCS	DISC SPACING		NUMBER OF BEARINGS	*APPROX. DBHP	APPROX. WEIGHT (lbs.)
FRONT	REAR					
8' 0"	20	9"	9"	8	70	1,700
8' 4"	22	9"	7.5"	8	75	1,800
9' 6"	24	9"	9"	8	85	2,000
	26	9"	7.5"			

*Approximate Draw Bar Horse Power is only a guide. Extremely hard, soft, hilly or boggy conditions will change these figures.



Versatility: The Hitch on the Model 65 is designed to adapt to a Category II Free Link or a Category II Quick Hitch.



The Rigid Bearing Hanger

features a **Wear Plate** that bolts onto the front-side of the Bearing Hanger adding extra protection to the front and bottom of the Bearing Housing.

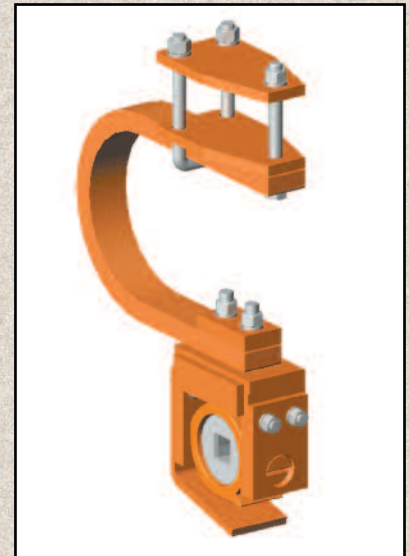

The Spring Bearing Hanger

provides maximum strength without sacrificing flexibility. It also features a **Wear Plate** which protects the front and bottom of the Bearing Housing.

Athens Plow Co., Inc. guarantees each piece of equipment against defective materials and workmanship for a period of one year from the date of delivery to the purchaser unless otherwise specified. Athens Plow Co., Inc. reserves the right to make changes and/or improvements in design and construction of parts or machines without notice or obligation.

ATHENS

MODEL 66

MOUNTED DISK HARROW

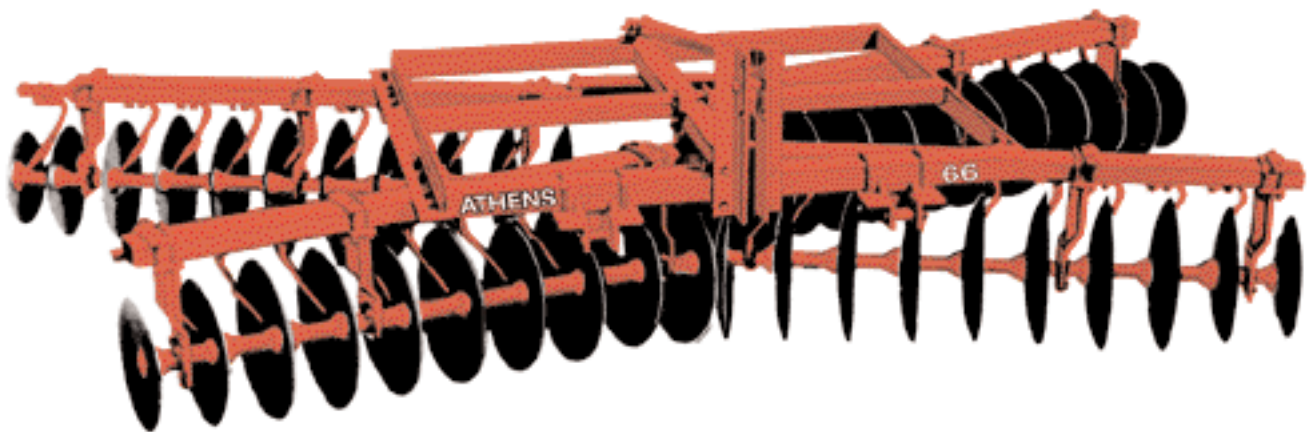

for
Sandy Soil

ATHENS PLOW COMPANY, INC.
P.O. BOX 609
ATHENS, TENNESSEE 37371-0609



66 MOUNTED DISK HARROW

SPECIFICATIONS

WIDTH OF CUT	NO. OF BLADES	NO. OF BEARINGS	DBHP *		APPROX. WEIGHT
			MIN.	MAX.	
12' 2"	32	8	60	85	2067
12' 11"	36, 40	8	65	90	2149
13' 6"	36	10	65	100	2254
14' 1"	40, 44	12	70	100	2515
15' 0"	40	12	75	110	2565
15' 3"	44, 48	14	75	110	2636

* Maximum Recommended DBHP. Approximate DBHP is only a guide. Extremely hard, soft, hilly, or boggy conditions will change these figures. DBHP in excess of the maximum recommended will void all warranty provisions.

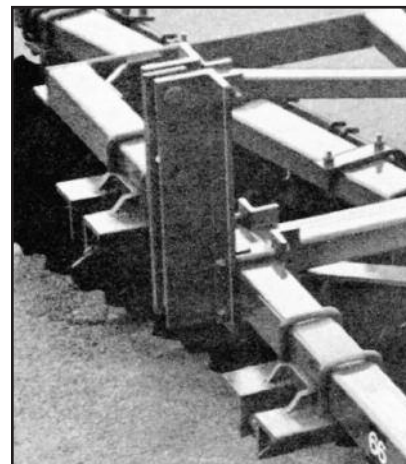

STANDARD EQUIPMENT

- 1 1/8" COLD ROLLED SQUARE AXLES
- RELUBE BALL BEARINGS
- FLANGETTE BEARING HANGERS
- ADJUSTABLE ANGLE OF CUT 16° TO 21°
- FACTORY ASSEMBLED TAPERED GANGS
- CAT II OR III HITCH, FREE LINK OR QUICK COUPLER
- 7 1/2", 9", OR COMBINATION SPACING
- 20" OR 22", CUTOUT OR SMOOTH BLADES

EXTRA EQUIPMENT

- BALK BUSTER
- COVER DISK
- HEAVY DUTY SCRAPERS

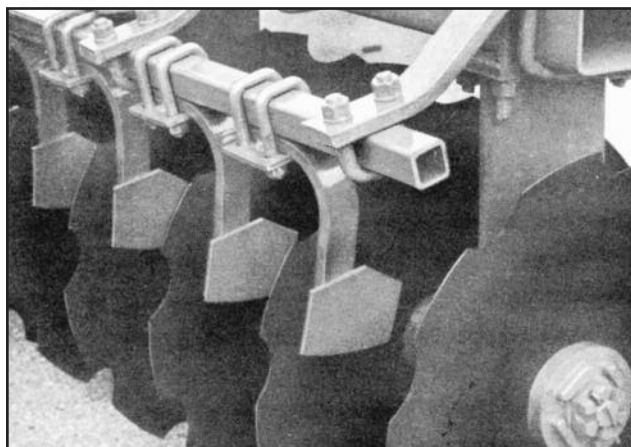

ATHENS PLOW CO., INC. guarantees each piece of equipment against defective materials and workmanship for a period of one year from the date of delivery to the purchaser unless otherwise specified. ATHENS PLOW CO., INC. reserves the right to make changes and/or improvements in design and construction of parts or machines without notice or obligation.

FEATURES

- **FRAME**
THE FRAME IS CONSTRUCTED FROM 4x4 AND 4x3 STRUCTURAL TUBING WHICH IS TRUSS BRACED AND REINFORCED TO RESIST TWISTING AND BENDING.
- **GANGS**
RUGGED 3x5 TUBULAR GANG FRAMES PROVIDE RIGID SUPPORT FOR GANG COMPONENTS. GANGS ARE FACTORY ASSEMBLED TO 750 FOOT POUNDS AND LOCKED SECURELY WITH SLOTTED NUTS.
- **AXLES**
AXLES ARE MADE FROM 1 1/8" COLD ROLLED SQUARE STEEL TO INSURE STRAIGHTNESS AND TO KEEP BEARINGS AND DISKS IN ALIGNMENT.
- **ANGLE OF CUT**
ADJUSTMENTS FROM 16° TO 21° ARE FAST AND EASY. GANGS ADJUST INDIVIDUALLY.
- **DISK BLADES**
BLADES ARE MADE FROM THE HIGHEST QUALITY STEEL FOR DURABILITY AND STRENGTH.

ATHENS PLOW COMPANY, INC.

P. O. BOX 609

ATHENS, TENNESSEE 37371-0609

ATHENS

MODEL 97



The Model 97 is ideal for wildlife applications and management. This lift-type offset disc harrow is available in widths from 6' 2" to 9' 0", making it the perfect choice for plantations and ranches.



"WE PLOW THE EARTH"



www.athensplowcompany.com

STANDARD EQUIPMENT

- Disc Blades, 22" or 24" Diameter
- 9" Spacing
- Relube Quadraseal Ball Bearings
- Rigid Bearing Hangers with Wear Plates
- 1.25" Square Cold Rolled Axle
- Adjustable Angle of Cut: 18° or 21°
- Gang Wrench

OPTIONAL EQUIPMENT

- Spring Bearing Hangers with Wear Plates
- Scrapers
- Cover Discs

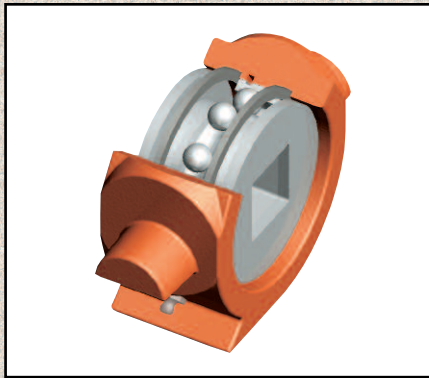

Quadraseal Ball Bearings

Strong relube QUADRASEAL ball bearings on the Model 97 mean long life and less downtime.



DISC BLADES

Available in 22 and 24 inch sizes. Athens Plow offers tailored solutions to meet your disking needs.

Smooth blades are best utilized in normal field conditions. They are more economical, wear longer, weigh more than cutout blades, and cut crop residue evenly.

Cutout blades are more aggressive and trap residue better than smooth blades.

MODEL 97 SPECIFICATIONS

WIDTH OF CUT	NUMBER OF DISCS	NUMBER OF BEARINGS	*APPROX. HORSE POWER	APPROX. WEIGHT (lbs.)
6' 2"	16	6	50 - 60	1,385
6' 10"	18	8	60 - 70	1,565
7' 6"	20	8	70 - 80	1,672
WIDE MAIN FRAME - CAT. II/III HITCH				
8' 4"	22	8	80 - 90	1,798
9' 0"	24	8	90 - 100	1,898

*Approximate Horse Power is only a guide. Extremely hard, soft, hilly or boggy conditions will change these figures.



The Top-Hitch Brace

on the Model 97 adds strength and durability to the hitch. Designed with a 1.5" diameter rod and a heavy duty spring, this brace is built to last.



The Rigid Bearing Hanger

features a **Wear Plate** that bolts onto the front-side of the Bearing Hanger adding extra protection to the front and bottom of the Bearing Housing.

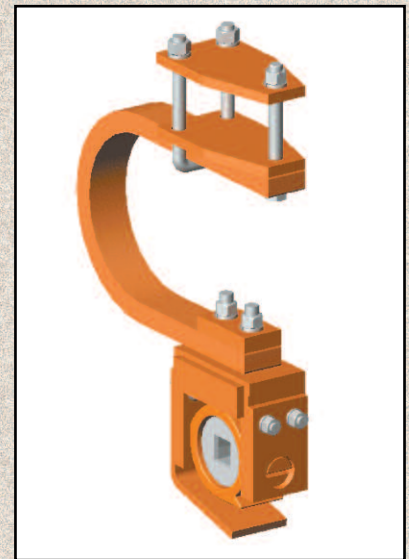

The Spring Bearing Hanger

provides maximum strength without sacrificing flexibility. It also features a **Wear Plate** which protects the front and bottom of the Bearing Housing.

Athens Plow Co., Inc. guarantees each piece of equipment against defective materials and workmanship for a period of one year from the date of delivery to the purchaser unless otherwise specified. Athens Plow Co., Inc. reserves the right to make changes and/or improvements in design and construction of parts or machines without notice or obligation.

ATHENS

MODEL BBD5

Blueberry Disc 5'



"WE PLOW THE EARTH"

The Model BBD5 is primarily designed for re-establishing the row middles of the blueberry bushes, rebuilding the beds, and is also ideal for weed cultivation. The 5' working width makes it the perfect choice for blueberry bush rows on 9' centers.

www.athensplowcompany.com

STANDARD EQUIPMENT

- 1 1/4" Cold Rolled Square Gang Axle
- Relube Quadraseal Ball Bearings
- Rigid Bearing Hangers with Wear Plates
- Spacing, 9"
- Tapered Disc Gang, 22" - 16" C/O or SM
- Adjustable Angle of Cut: 15° or 18°
- Cat. II Free Link or Quick Coupler
- Balk Buster with 9" Sweep
- Gang Wrench

OPTIONAL EQUIPMENT

- Scrapers

FEATURES

Quadraseal Ball Bearings

Strong relube QUADRASEAL Ball Bearings on the Model BBD5 mean long life and less downtime.

The Rigid Bearing Hanger

features a Wear Plate that bolts onto the front-side of the bearing hanger adding extra protection to the front and bottom of the bearing housing.

The Main Frame is constructed of 1/4" thick steel tubing which is trussed braced to resist twisting and bending.

Gang Frames are constructed from 3" x 5" heavy wall structural steel tubing.

Angle of Cut

Adjustments from 15° to 18° are made without tools by removing only one pin per disc gang.

Vertical Flexibility

The Spring Leveling Rod Assembly allows the disc gangs to adjust and flex with the contour of the land between the rows.

MODEL BBD5 SPECIFICATIONS

WIDTH OF CUT	NUMBER OF DISCS	NUMBER OF BEARINGS	*APPROX. HP	APPROX. WEIGHT (lbs)
5' 0"	8	4	45	985
6' 6"	10	8	40-80	1048

*Approximate Horse Power (HP) is only a guide. Extremely hard, soft, or boggy conditions will change this figure.



DISC BLADES

The disc gangs are tapered from the inside-out starting with 22" diameter discs tapering down to 16" diameter discs. Available in Cutout or Smooth.

Smooth blades are best utilized in normal field conditions. They are more economical, wear longer, weigh more, and wear more evenly, thus staying sharper longer.

Cutout blades have an aggressive edge that trap and cut residue better than smooth blades.

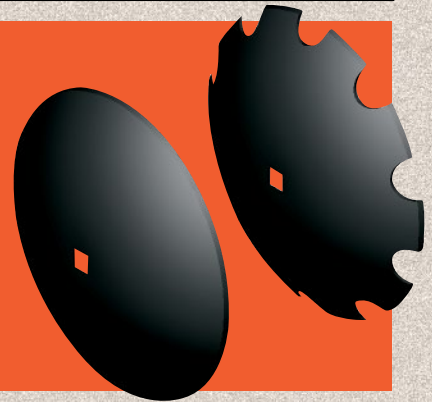

Athens Plow Co., Inc. guarantees each piece of equipment against defective materials and workmanship for a period of one year from the date of delivery to the purchaser unless otherwise specified. Athens Plow Co., Inc. reserves the right to make changes and/or improvements in design and construction of parts or machines without notice or obligation.

ATHENS

MODEL 62



The Model 62 is the ideal Tandem Disk Harrow for those who need to pass through lanes and narrow gates while still providing the performance of wider disks. The Model 62 is available in widths from 7'11" to 12'11" making it the perfect choice for smaller farms, plantations and ranches.



"WE PLOW THE EARTH"



www.athensplowcompany.com

MODEL 62 SPECIFICATIONS

WIDTH OF CUT	NUMBER OF DISCS	DISC SPACING		NUMBER OF BEARINGS	*APPROX. DBHP	APPROX. WEIGHT (lbs.)
		FRONT	REAR			
7'11"	20	9"	9"	8	40-50	1,646
8'2"	22	9"	7½"	8	45-55	1,768
	24	7½"	7½"			
9'4"	24	9"	9"	8	50-60	1,874
	26	9"	7½"			
	28	7½"	7½"			
10'6"	30	9"	7½"	8	55-65	2,088
	32	7½"	7½"			
10'9"	28	9"	9"	8	55-65	2,026
12'2"	32	9"	9"	12	65-75	2,336
12'11"	36	9"	7½"	12	70-80	2,526
	40	7½"	7½"			

*Approximate Draw Bar Horse Power is only a guide.
Extremely hard, soft, hilly or boggy conditions will change these figures.

STANDARD EQUIPMENT

- Disc Blades, 20" or 22" Diameter
- Relube Quadriseal Ball Bearings
- Rigid Flangette Bearing Hangers
- 1½" Square Cold Rolled Axle
- Hydraulics Complete
- 15", 5 Lug Wheels with Quadriseal Hubs
- Spacing: 7½", 9" or 9" Front & 7½" Rear
- Angle of Cut: 13°, 17° or 21°
- Gang Wrench

OPTIONAL EQUIPMENT

- Scrapers
- Cover Discs
- Balk Buster

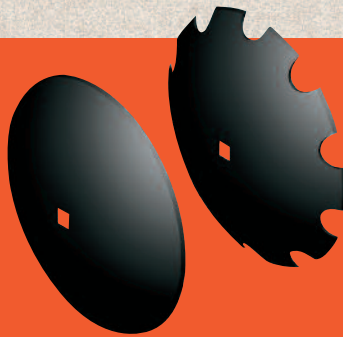

DISC BLADES

Available in 20 and 22 inch sizes. Athens Plow offers tailored solutions to meet your disking needs.

Smooth blades are best utilized in normal field conditions. They are more economical, wear longer, weigh more than cutout blades, and cut crop residue evenly.

Cutout blades are more aggressive and trap residue better than smooth blades.

FEATURES

FRAME

The Main Frame is constructed of 4"x4" square tubing and 4" structural channel which is trussed braced and reinforced to resist twisting and bending.

GANGS

Rugged 3"x5" gang frame tubes provide rigid support for gang components. Gangs are factory assembled to 750 ft. lbs. and locked securely with slotted nuts.

AXLES

Axles are made from 1½" square cold rolled steel to insure straightness and to keep bearings and discs in alignment.

ANGLE OF CUT

Adjustments from 13° to 21° in 4° increments are made without tools by removing only one pin per gang.

VERSATILITY

The Tongue Clevis height can be adjusted to match the draw-bar height on the Tractor.



The Quadriseal Wheel Hubs

are an exclusive ATHENS PLOW design for increased Bearing life and reduction of downtime. Our QUADRASEAL Wheel Hubs offer maximum protection from dirt and trash by combining a triple lip seal with a press fitted external trash flinger.

www.athensplowcompany.com

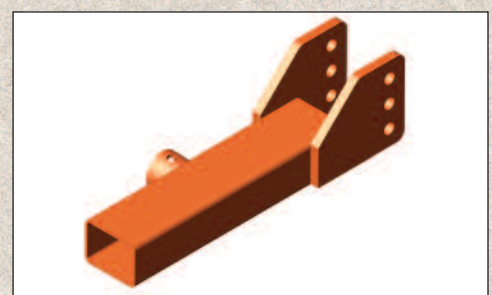

Athens Plow Co., Inc. guarantees each piece of equipment against defective materials and workmanship for a period of one year from the date of delivery to the purchaser unless otherwise specified. Athens Plow Co., Inc. reserves the right to make changes and/or improvements in design and construction of parts or machines without notice or obligation.

ATHENS

MODEL 93



The Model 93 is the ideal Disk for smaller farms, plantations, and ranches. This rugged Tandem Disk Harrow is available in widths from 9'4" to 15'3", making it the perfect choice for pasture land renovation, firebreaks, and food-plots.



" WE PLOW THE EARTH "

www.athensplowcompany.com



DISC BLADES

Available in 22 and 24 inch sizes. Athens Plow offers tailored solutions to meet your disking needs.

Smooth blades are best utilized in normal field conditions. They are more economical, wear longer, weigh more than cutout blades, and cut crop residue evenly.

Cutout blades are more aggressive and trap residue better than smooth blades.

CUTOUT OR SMOOTH

STANDARD EQUIPMENT

- Disc Blades, 22" or 24"
- Spacing: 9", 7 1/2", or 9" Front and 7 1/2" Rear
- Adjustable Cutting Angle: 15° or 19°
- Relube Quadraseal Ball Bearings
- Rigid Bearing Hangers with Wear Plates
- 1 1/4" Square Cold Rolled Axle
- Tapered Outside Front & Rear Gangs
- Heavy-Duty Scrapers
- Cover Discs with Scrapers
- Self Leveling Frame
- Gang Wrench and Tongue Jack
- Reversible Tongue Clevis
- 15" - 5 Lug Wheel Hubs and Rims
- Dual Wheels on 15' and 15'3"
- Lifting Hydraulics Complete
- Mechanical Transport

OPTIONS

- Dual Wheels on 9' 4" - 14' 1"
- Spring Bearing Hangers with Wear Plates
- Balk Buster

Athens Plow Co., Inc. guarantees each piece of equipment against defective materials and workmanship for a period of one year from the date of delivery to the purchaser unless otherwise specified. Athens Plow Co., Inc. reserves the right to make changes and/or improvements in design and construction of parts or machines without notice or obligation.

MODEL 93 SPECIFICATIONS

WIDTH OF CUT	NUMBER OF DISCS	NUMBER OF BEARINGS	**APPROX. DBHP	APPROX. WEIGHT (lbs.)
9' 4"	24, 26, 28	8	60 - 75	2,898
10' 6"	28, 30, 32	8	70 - 85	3,123
12' 2"	32	12	85 - 95	3,493
12' 11"	36, 40	12	90 - 100	3,569
13' 6"	36	12	95 - 110	3,707
14' 1"	40, 44	12	100 - 120	3,754
15' 0"	40	16	100 - 125	4,751
15' 3"	44, 48	16	100 - 130	5,642

** Approximate Draw Bar Horse Power (DBHP) is only a guide. Extremely hard, soft, hilly or boggy conditions will change these figures.

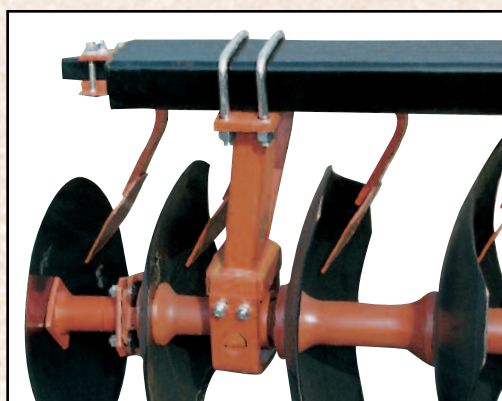

The Rigid Bearing Hanger features a **Wear Plate** that bolts onto the front-side of the Bearing Hanger adding extra protection to the front and bottom of the Bearing Housing.



The Spring Bearing Hanger provides maximum strength without sacrificing flexibility. It also features a **Wear Plate** which protects the front and bottom of the Bearing Housing.

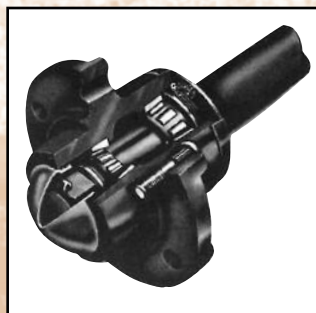

The Quadraseal Wheel Hubs

are an exclusive ATHENS PLOW design for increased Bearing life and reduction of downtime. Our QUADRASEAL Wheel Hubs offer maximum protection from dirt and trash by combining a triple lip seal with a press fitted external trash flinger. The QUADRASEAL Bearings give added bearing life.



The Quadraseal Double Tapered Roller Bearings

provide the most capacity in the industry. With this added capacity, the probability of overloading is virtually eliminated. The double tapered roller bearing has a triple-lip seal that runs on a hardened, polished surface and is protected by a heavy steel washer to avoid damage from wire and trash. Between the washer and the seal is a cavity filled with grease — an additional sealing element against dirt.

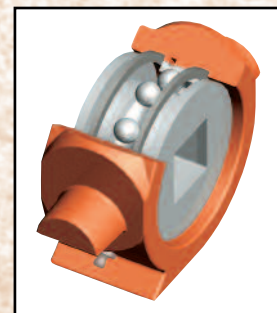

Quadraseal Ball Bearings

Strong relube QUADRASEAL ball bearings on the 93 cutout or smooth disc blades mean long life and less downtime.



ATHENS

MODEL 153

153



The Model 153 is ideal for smaller farms, plantations and ranches. This heavy-duty Tandem Disc Harrow is available in 9' 6", 11' and 12' 6" widths, making it the perfect choice for pasture land renovation, firebreaks, and wildlife food plots.



"WE PLOW THE EARTH"

STANDARD EQUIPMENT

- 1½" Cold Rolled Square Gang Axle
- Double Tapered Roller Bearings
- Rigid or Spring Bearing Hangers with Wear Guards
- Disc Blades, 24" Diameter C/O or SM
- Disc Spacing, 9½"
- Dual Wheels
- Lifting Hydraulics
- Heavy-Duty Tube Mounted Scrapers
- Cover Discs with Scrapers
- Self-Leveling Frame
- Mechanical Transport
- Reversible Tongue Clevis
- Gang Wrench and Tongue Jack

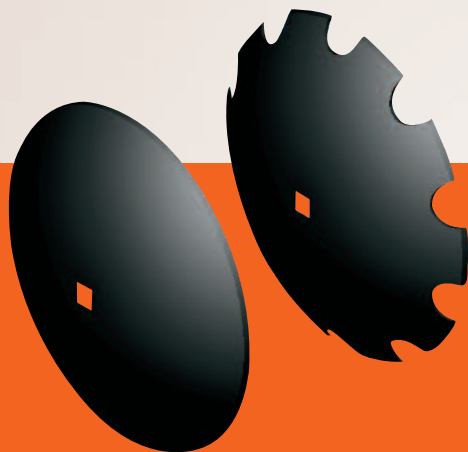

Disc Blades

Smooth blades are best utilized in normal field conditions. They are more economical, wear longer, weigh more than cutout blades, and cut crop residue evenly.

Cutout blades are more aggressive and trap residue better than smooth blades.

Athens Plow Co., Inc. guarantees each piece of equipment against defective materials and workmanship for a period of one year from the date of delivery to the purchaser unless otherwise specified. Athens Plow Co., Inc. reserves the right to make changes and/or improvements in design and construction of parts or machines without notice or obligation.

MODEL 153 SPECIFICATIONS

WIDTH OF CUT	NUMBER OF DISCS	NUMBER OF BEARINGS	*APPROX. DBHP	APPROX. WEIGHT (lbs.)
9' 6"	24	8	75-95	4,295
11' 0"	28	10	85-110	4,643
12' 6"	32	12	100-125	5,290

*Approximate Draw Bar Horse Power (DBHP) is only a guide. Extremely hard, soft, hilly or boggy conditions will change these figures.



The Spring Bearing Hanger on the 153 provides maximum strength without sacrificing flexibility. It also features a **Wear Plate** which protects the front and bottom of the Bearing Housing.



The Rigid Bearing Hanger on the 153 features a **Wear Plate** that bolts onto the front-side of the Bearing Hanger adding extra protection to the front and bottom of the Bearing Housing.



The Quadraseal Double Tapered Roller Bearings

provide the most capacity in the industry. With this added capacity, the probability of overloading is virtually eliminated. The double tapered roller bearing has a triple-lip seal that runs on a hardened, polished surface and is protected by a heavy steel washer to avoid damage from wire and trash. Between the washer and the seal is a cavity filled with grease – an additional sealing element against dirt.

The Quadraseal Wheel Hubs

are an exclusive ATHENS PLOW design for increased Bearing life and reduction of down-time. Our QUADRASEAL Wheel Hubs offer maximum protection from dirt and trash by combining a triple lip seal with a press fitted external trash flinger. The QUADRASEAL Bearings give added bearing life.



ATHENS

MODEL 76/77



The Model 76/77 has been designed for faster and more uniform incorporation, better seedbeds, and less time in the field. The advanced double offset design allows you to disk at faster speeds. The 76/77 follows the contour of the field leaving a uniform level seedbed behind.



"WE PLOW THE EARTH"



MODEL 76 SPECIFICATIONS

WIDTH OF CUT	NUMBER OF DISCS	NUMBER OF BEARINGS	*APPROX. DBHP	APPROX. WEIGHT (lbs.)
8' 10"	24, 26, 28	8	60 - 70	2,900
10' 3"	28, 30, 32	8	70 - 80	3,200
11' 1"	34, 36	12	75 - 85	3,500
11' 8"	32	12	75 - 90	3,400
13' 1"	36	12	90 - 100	3,700
13' 5"	40, 44	12	90 - 110	3,800
14' 6"	40	12	95 - 115	3,900
15' 1"	44, 48	12	100 - 120	4,200

*Approximate Draw Bar Horse Power is only a guide. Extremely hard, soft, hilly or boggy conditions will change these figures. D.B.H.P. in excess of the recommended will void all warranty provisions.

STANDARD EQUIPMENT

- 1 1/4" Cold Rolled Square Gang Axles
- Quadraseal Ball Bearings
- Disk Blades, 22" or 24" Cutout or Smooth
- Spacing 7 1/2", 9" or 9" Front and 7 1/2" Rear
- Tapered Front and Rear Gangs
- Self Leveling Frame
- Reversible Tongue Clevis
- Adjustable Angle of Cut: 15° or 18°
- Split Wheel Carriages
- Wheel Hubs and Rims
- Dual Wheels on all 77's and on 76's from 14'6" to 15'1"
- Lifting Hydraulics
- Heavy Duty Tube Mounted Scrapers
- Cover Discs with Scrapers
- Gang Wrench and Tongue Jack

OPTIONAL EQUIPMENT

- Rigid or Spring Bearing Hangers

EXTRA EQUIPMENT

- Dual Wheels – on 76's, 8'10" to 13'5"

FEATURES

The MAINFRAMES of the 76/77 combine structural steel tubing and high strength angle welded and reinforced for maximum strength. Structural angle is used for the side members allowing the frame to flex so it can follow the contour of the field ... This feature reduces the stress on the frame and lengthens the life of the components.

The TONGUE is designed like a narrow "A" frame permitting shorter turns in the field. It is fitted with a balanced reversible clevis to accommodate a variety of drawbars.

GANG FRAMES are constructed from 3" x 5" heavy wall structural steel tubing.

DISC GANGS start with an axle made from 1 1/4" cold rolled square steel. The spacers are arbor machined to keep the gang components in perfect alignment. Tapered gangs front and rear reduce furrows and ridges leaving a smooth seedbed even at faster speeds. Spacing is available in 7 1/2", 9", or a combination of 9" front and 7 1/2" rear.



TWO STAGE LEVELING keeps the frame level in the field and in transport. After hitching the clevis to the tractor, the turnbuckle adjusts the tongue position to level the disk frame in transport. In the field, a leveling screw that connects the tongue to the wheel carriages is adjusted for field conditions and discing speed desired. After initial adjustment, the frame remains level while being lifted and lowered. A TURNBUCKLE connects the wheel carriages for precise side-to-side leveling.



The Rigid Bearing Hanger

features a **Wear Plate** that bolts onto the front-side of the Bearing Hanger adding extra protection to the front and bottom of the Bearing Housing.



DISC BLADES

Available in 22 and 24 inch sizes. Athens Plow offers tailored solutions to meet your discing needs.

Smooth blades are best utilized in normal field conditions. They are more economical, wear longer, weigh more than cutout blades, and cut crop residue evenly.

Cutout blades are more aggressive and trap residue better than smooth blades.

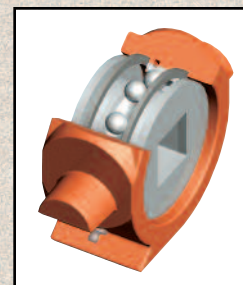

Quadraseal Ball Bearings

Strong relube QUADRASEAL ball bearings on the Model 76/77 mean long life and less downtime.

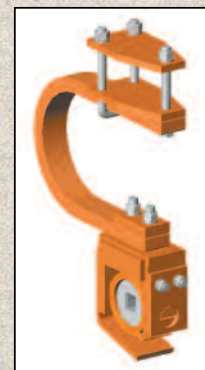

The Spring Bearing Hanger

provides maximum strength without sacrificing flexibility. It also features a **Wear Plate** which protects the front and bottom of the Bearing Housing.

Athens Plow Co., Inc. guarantees each piece of equipment against defective materials and workmanship for a period of one year from the date of delivery to the purchaser unless otherwise specified. Athens Plow Co., Inc. reserves the right to make changes and/or improvements in design and construction of parts or machines without notice or obligation.

Athens Plow Company, Inc.
PO Box 609 • Athens, TN 37371-0609

STANDARD EQUIPMENT

- Model 116/119: Square Blades
- Double Tapered Roller Bearings
 - Disc Blades, 24” Square
 - Rigid Bearing Hangers with Wear Plates (116)
 - Spring Bearing Hangers with Wear Plates (119)
 - 1 1/4” Cold Rolled Square Gang Axle
 - Spacing, 9”
 - Single Tapered Disc on Front
 - Double Tapered Discs on Rear
 - Adjustable Cutting Angle, 15° or 19°
 - Cover Discs with Scrapers
 - Six Lug Wheel Hubs and Rims
 - Self Leveling Frame
 - Lifting and Folding Hydraulics
 - Reversible Tongue Clevis
 - Gang Wrench and Tongue Jack

- Model 116: Cutout & Smooth
- Quadraseal Ball Bearings
 - Rigid Bearing Hangers with Wear Guards
 - Disc Blades, 22” or 24” Smooth or Cutout
 - 1 1/4” Cold Rolled Square Gang Axle
 - Spacing, 7 1/2”, 9”, or 9” Front and 7 1/2” Rear
 - Single Tapered Disc on Front
 - Double Tapered Discs on Rear
 - Adjustable Cutting Angle, 15° or 19°
 - Cover Discs with Scrapers
 - Six Lug Wheel Hubs and Rims
 - Self Leveling Frame
 - Lifting and Folding Hydraulics
 - Reversible Tongue Clevis
 - Gang Wrench and Tongue Jack

- Model 119: Cutout & Smooth
- Double Tapered Roller Bearings
 - Spring Bearing Hangers with Wear Plates
 - Disc Blades, 22” Smooth or Cutout
 - 1 1/4” Cold Rolled Square Gang Axle
 - Spacing, 9”
 - Single Tapered Disc on Front
 - Double Tapered Discs on Rear
 - Adjustable Cutting Angle, 15° or 19°
 - Cover Discs with Scrapers
 - Six Lug Wheel Hubs and Rims
 - Self Leveling Frame
 - Lifting and Folding Hydraulics
 - Reversible Tongue Clevis
 - Gang Wrench and Tongue Jack

SQUARE BLADE MODEL 116/119							
NARROW MAIN FRAME							
MODEL NUMBER	WIDTH OF CUT	*NUMBER OF DISCS	APPROX. WT. (lbs.)	TRANSPORT WIDTH	TRANSPORT HEIGHT	NUMBER OF BEARINGS	**APPROX. DBHP
116 ONLY	16’ 8”	46	7,775	11’ 6”	8’ 8”	18	150
116/119	19’ 4”	54	8,225	11’ 6”	10’ 3”	18	175
116/119	22’	58	8,605	11’ 6”	11’ 6”	18	200
116/119	23’ 4”	62	9,087	11’ 6”	12’ 6”	22	210
WIDE MAIN FRAME							
116/119	26’	70	10,796	13’	12’ 6”	24	225
116/119	28’ 8”	78	11,309	13’	14’	24	265

* Includes Cover Discs
** Approximate DBHP is only given as a guide. Extremely hard, soft, hilly or boggy conditions will change these figures.

MODELS 116/119: Cutout and Smooth Blades							
NARROW MAIN FRAME							
WIDTH OF CUT	*NUMBER OF DISCS	APPROX. WEIGHT (lbs.)	TRANSPORT WIDTH	TRANSPORT HEIGHT	NUMBER OF BEARINGS	**APPROX. DBHP	
16’ 8”	44, 48, 52	7,390	11’ 4”	8’ 8”	16	120	
19’ 6”	52, 56, 60	7,790	11’ 4”	10’ 3”	16	140-150	
21’ 5”	56, 62, 68	8,047	11’ 4”	11’ 6”	16	150-160	
22’ 9”	60, 66, 72	8,711	11’ 4”	12’ 6”	20	165	
25’ 5”	68, 74, 80	9,234	11’ 4”	14’	20	180	
WIDE MAIN FRAME							
26’	70*	9,806	13’	12’ 6”	24	225	
28’ 8”	78*	10,278	13’	14’	24	265	

Athens Plow Co., Inc. guarantees each piece of equipment against defective materials and workmanship for a period of one year from the date of delivery to the purchaser unless otherwise specified. Athens Plow Co., Inc. reserves the right to make changes and/or improvements in design and construction of parts or machines without notice or obligation.



Athens Plow Company, Inc. • PO Box 609 • Athens, TN 37371-0609

ATHENS

MODELS 116 / 119

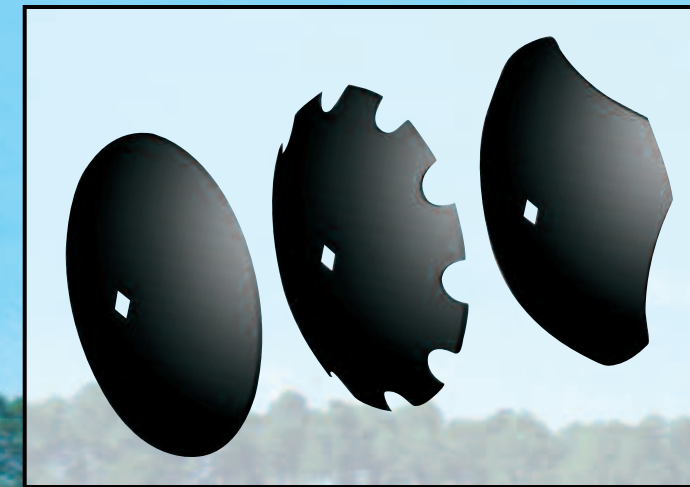

*Athens...
Tailoring Solutions
to Meet Your Needs*



“ WE PLOW THE EARTH ”

ATHENS PLOW COMPANY



ATHENS MODEL 116



ATHENS MODEL 119

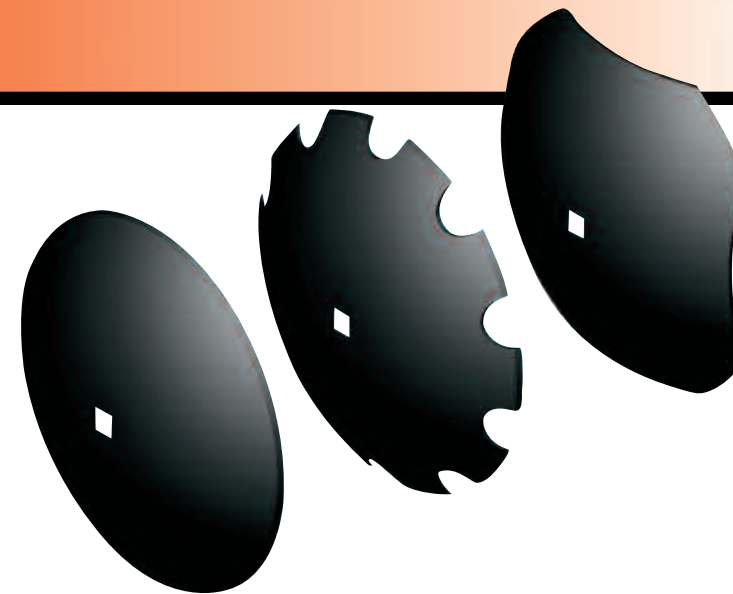

DISC BLADES

Available in 22 and 24 inch sizes. Athens Plow offers tailored solutions to meet your disking needs.

Smooth blades are best utilized in normal field conditions. They are more economical, wear longer, weigh more than cutout blades, and cut crop residue evenly.

Cutout blades are more aggressive and trap residue better than smooth blades.

Square blades are offset 45° from one another. This staggered arrangement allows the total weight of the disk harrow to be distributed on every other blade, resulting in considerably more pounds per square inch and, therefore, better penetration.



The Quadraseal Wheel Hubs

are an exclusive ATHENS PLOW design for increased Bearing life and reduction of downtime. Our QUADRASEAL Wheel Hubs offer maximum protection from dirt and trash by combining a triple lip seal with a press fitted external trash flinger. The QUADRASEAL Bearings give added bearing life.



The Quadraseal Double Tapered Roller Bearings

provide the most capacity in the industry. With this added capacity, the probability of overloading is virtually eliminated. The double tapered roller bearing has a triple-lip seal that runs on a hardened, polished surface and is protected by a heavy steel washer to avoid damage from wire and trash. Between the washer and the seal is a cavity filled with grease – an additional sealing element against dirt.

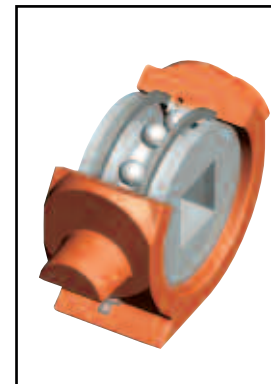

Quadraseal Ball Bearings

Strong relube QUADRASEAL ball bearings on the 116 cutout or smooth disc blades mean long life and less downtime.

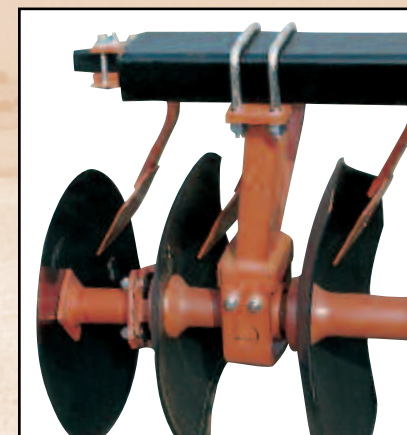

The Rigid Bearing Hanger on the 116 features a **Wear Plate** that bolts onto the front-side of the Bearing Hanger adding extra protection to the front and bottom of the Bearing Housing.



Narrow Transport

The Wings on the Athens 116/119 hinge from the Main Frame, resulting in narrower transport width and better flotation. The folding width is 11' 6" (on 16' 8" – 23' 4" models) and 13' (on the 26' and 29' models).

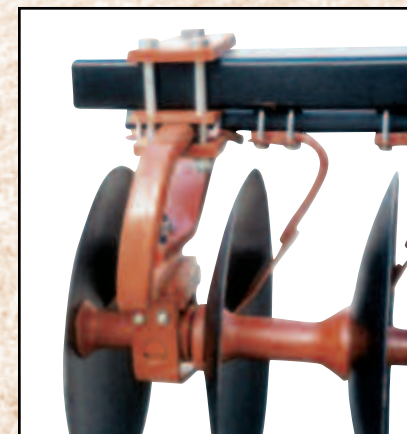

The Spring Bearing Hanger on the 119 provides maximum strength without sacrificing flexibility. It also features a **Wear Plate** which protects the front and bottom of the Bearing Housing.

ATHENS

MODEL 127/167

127
167



"WE PLOW THE EARTH"

The Athens Model 127 and 167 Offset Disk Harrows have the features, sizes, and weights to handle nearly any disking job on the farm. They can easily plow through stalks and stubble, prepare seedbeds, or incorporate chemicals. The Model 127 and 167 make operation a breeze with standard equipment like hydraulic leveling. These offsets are durable and dependable, making Athens the best choice for finishing or primary tillage.

www.athensplowcompany.com

STANDARD EQUIPMENT

- Extra Disc on Right Rear
- Cover Disc with Scraper
- Reversible, Balanced Clevis
- 1½" Cold Rolled Square Steel Axles with Wrench
- Heavy Duty Tongue with Jack
- Complete Hydraulics - Lifting and Leveling
- Heavy Duty Scrapers
- Adjustable Angle of Cut
- Rigid Bearing Hangers with either Trunion Mounted Ball Bearings or Relube Quadriseal Tapered Roller Bearings

OPTIONAL EQUIPMENT

- Manual Leveling
- Spring Bearing Hangers w/Quadriseal Tapered Roller Bearings

EXTRA EQUIPMENT

- Dual Wheels



The Rigid Bearing Hanger

on the 127/167 features a Wear Plate that bolts onto the front-side of the Bearing Hanger adding extra protection to the front and bottom of the Bearing Housing.



The Spring Bearing Hanger

on the 127/167 provides maximum strength without sacrificing flexibility. It also features a Wear Plate which protects the front and bottom of the Bearing Housing.

MODEL 127/167 SPECIFICATIONS

MODEL 127

9½" Disk Spacing Narrow Frame with 15"x6½" Five-lug Wheels

WIDTH OF CUT	NO. OF DISCS	APPROX. WEIGHT*	APPROX. DBHP**
6' 6"	17	2714	60 - 75
7' 3"	19	2883	65 - 75
8' 0"	21	3055	70 - 90
8' 9"	23	3296	70 - 90

Wide frame with 15" x 8", six-lug wheels

9' 6"	25	3459	75 - 100
11' 0"	29	4347	90 - 120
12' 6"	33	4870	100 - 140

MODEL 167

10½" Disk Spacing Narrow Frame with 15"x6½" Five-lug Wheels

WIDTH OF CUT	NO. OF DISCS	APPROX. WEIGHT*	APPROX. DBHP**
7' 1"	17	3115	65 - 85
8' 0"	19	3297	75 - 100
8' 9"	21	3485	80 - 100

Wide frame with 15" x 8", six-lug wheels

9' 7"	23	4185	85 - 115
10' 5"	25	4388	95 - 125
12' 1"	29	4843	100 - 140

*Approximate weights include Quadriseal double row disk gang bearings, hydraulics complete, four 15" x 8", six-lug wheels, tapered discs, and reversible clevis.

**Maximum Recommended DBHP. Approximate DBHP is only a guide. Extremely hard, soft, hilly, or boggy conditions will change these figures. DBHP in excess of the maximum recommended will void all provisions.



The Quadriseal Double Tapered Roller Bearings

provide the most capacity in the industry. With this added capacity, the probability of overloading is virtually eliminated. The double tapered roller bearing has a triple-lip seal that runs on a hardened, polished surface and is protected by a heavy steel washer to avoid damage from wire and trash. Between the washer and the seal is a cavity filled with grease – an additional sealing element against dirt.

FEATURES

The 127 Offset Disk is available in 6' 6" to 12' 6" cutting widths with 9½" spacing and 24" x ¼" Cut-out or Smooth Discs.

The 167 Offset Disk is available in 7' 1" to 12' 1" widths with 10½" spacing, 26" x ¼" Cut-out or Smooth Discs.

Hydraulic Leveling from the tractor seat provides positive control for front-to-rear leveling in varying conditions.

Adjustable Angle of Cut. Angle of cut can be quickly and easily adjusted for more aggressive cutting and mixing action. Front gangs adjust from 16 degrees to 25 degrees. Rear gangs from 19 to 28 degrees.

Athens Plow Co., Inc. guarantees each piece of equipment against defective materials and workmanship for a period of one year from the date of delivery to the purchaser unless otherwise specified. Athens Plow Co., Inc. reserves the right to make changes and/or improvements in design and construction of parts or machines without notice or obligation.

ATHENS

MODEL 137-187

OFFSET DISKS



These ATHENS 137 and 187 Offset Disks are designed and built to do things that Offset Disk Harrows don't usually do. They TRAIL STRAIGHT without any side draft and finish smoothly going **around** the field. They will plow up and down rows, or diagonally ACROSS ROWS—leaving uniformly leveled soil across the entire width of cut. There will be no outside furrows to interfere with planting, harvesting, or irrigation.

These units are built so one person can easily hitch up by himself to the reversible, balanced swivel tongue Clevis using the tongue jack.

The ATHENS 137 and 187 Offsets are built to last LONGER. They are manufactured using heavy steel tubes which have a 300% built in Safety Margin against twisting, bending, and breakage. To assure you of unsurpassed performance, long life, and trouble free service, the 137 and 187 were put through a tough field testing program—under severe conditions, not just by our engineers, but by farmers like you and under **your** conditions.

ATHENS PLOW COMPANY, INC.
P.O. BOX 609
ATHENS, TENNESSEE 37371-0609



137-187 OFFSET DISK HARROWS

SPECIFICATIONS

137 OFFSET DISK					187 OFFSET DISK				
1-½" Square axle, 9-½" Disk spacing and 24" x ¼" smooth or cutout disks					1-½" Square axle, 10-½" Disk spacing, and 26" x ¼" smooth or cutout Disks				
Width of Cut	No. of Disk	* Approx Weight	DBHP** (Maximum Recommended)	No. of Bearings	Width of Cut	No. of Disks	* Approx. Weight	DBHP** (Maximum Recommended)	No. of Bearings
12' 6"	33	5367	90-135**	8	12' 1"	29	5693	95-145**	8
14' 0"	37	5734	100-165**	9	13' 9"	33	6373	105-165**	12
15' 6"	41	6373	110-170**	12	15' 5"	37	7031	125-185**	12
17' 0"	45	6734	120-185**	12	17' 1"	41	7365	140-200**	13
18' 6"	49	7076	130-200**	12					

* Approximate weights include QUADRASEAL double row Disk gang Bearings, Hydraulics complete, Four 15 x 8, six lug wheels, Tapered Disks, and reversible Clevis.

** Maximum Recommended DBHP. Approximate DBHP is only a guide. Extremely hard, soft, hilly, or boggy conditions will change these figures. DBHP in excess of the maximum recommended will void all warranty provisions.

STANDARD EQUIPMENT:

- Cover disk w/scraper
- Reversible, balanced clevis
- 1½" cold rolled square steel axles w/wrench
- Dual 15" 6 lug Wheels with QUADRASEAL hubs
- Heavy duty Scrapers
- Complete hydraulics, lifting and leveling
- Tapered Disk on right rear
- Adjustable angle of cut
- Rigid bearing hangers with either trunion mounted ball bearings or Relube QUADRASEAL tapered roller bearings
- Dual Wheels

OPTIONAL EQUIPMENT:

- Manual leveling
- Spring Bearing hangers w/QUADRASEAL tapered roller bearings

FEATURES

These brawny offsets are tough enough to chew up just about anything that gets in their way—heavy stalk, pasture sods, or easy to plow soils. And they're versatile enough to handle everything from primary tillage to chemical incorporation. They can be quickly and easily adjusted for deep plowing or for smooth, shallow finishing in a matter of minutes.

ADJUSTABLE ANGLE OF CUT. Angle of cut can be quickly and easily adjusted for more aggressive cutting and mixing action. Front gangs adjust from 13° to 25°. Rear gangs, from 16° to 28°.

Athens Plow Co., Inc. guarantees each piece of equipment against defective materials and workmanship for a period of one year from the date of delivery to the purchaser unless otherwise specified. Athens Plow Co., Inc. reserves the right to make changes and/or improvements in design and construction of parts or machines without notice or obligation.

The **ATHENS 137** has the ideal weight and size for general purpose usage. It has the size (12' 6" — 18' 6") and weight (137 pounds per blade, average) to penetrate deep and cover a lot of ground quickly—even in hard-to-plow soils. 24" disks with 9½" spacing standard.

The **ATHENS 187** is nearly 27% heavier than the 137. With 12' 1" thru 17' 1" cutting width and an average 187 pounds per blade, it will handle the tougher soils and trashier conditions, and give you the kind of results you want with every pass. 26" disks with 10½" spacing standard.



HYDRAULIC LEVELING from the tractor seat provides effortless LEVEL FOR TRANSPORT and adjustment for EXACT TRAILING.

AMPLE TRASH CLEARANCE. Wide open spaces between spacer spools and gang frames, plus narrow—but strong—bearing hangers, provide plenty of trash clearance. Heavy trash passes through cleanly and is worked deep into the soil for fast decomposition.



THE QUADRASEAL double-row tapered roller Bearings provide the most capacity in the industry. With this extra capacity, the probability of over-loading...even when disking at maximum angle...is virtually eliminated. The double tapered roller bearing has a triple-lip Seal that runs on a hardened, polished surface and is protected by a heavy steel Washer to avoid damage from wire and trash. Between the steel Washer and the Seal is a cavity filled with grease...an additional sealing element against dirt.

OPTIONAL DISK GANG BEARINGS:

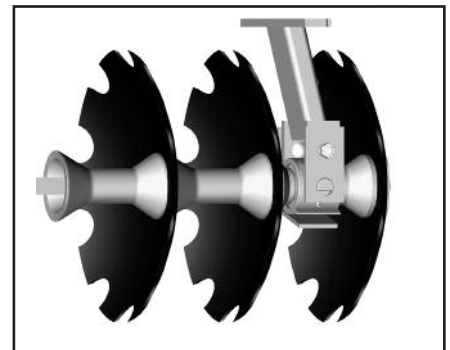

Relube Trunion mounted ball bearings provide economy with dependability. Rigid QUADRASEAL tapered roller bearings give added capacity and increased life.

Both Rigid and Spring Bearing Hangers feature a Wear Plate which protects the front and bottom of the bearing hanger.

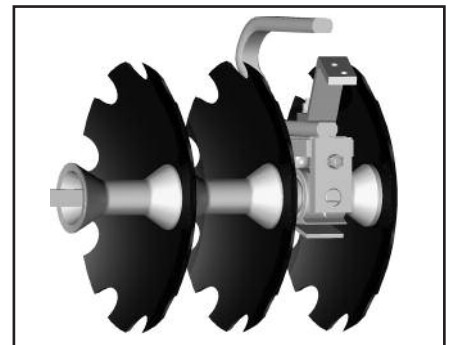

QUADRASEAL tapered roller bearings with spring bearing hangers provide maximum flexibility in rocky and uneven land.

ATHENS

MODEL 287

OFFSET DISK HARROW

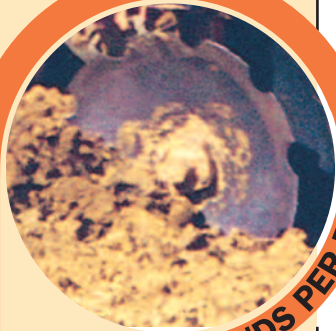

POUNDS PER BLADE

The weight per blade ranges from (287-340) pounds per blade on the narrow frame units (8', 9', and 10'). The weight on the wide frame units (12', 14', and 16') ranges from (300-350) pounds per blade.



Athens Plow Company, Inc.
PO Box 609
Athens, TN 37371-0609



MODEL 287

OFFSET DISK HARROW

STANDARD EQUIPMENT

- 2" Cold Rolled Square Steel Axle
- Complete Lifting Hydraulics
- Complete Leveling Hydraulics
- 28" or 32" Cutout Disk Blades
- Heavy Duty Relube Ball Bearings
- Dual Wheels
- 15' x 8" Lug Wheels
- Adjustable Angle of Cut (15°, 17°, 21°, and 25°)
- Tapered Rear Gang
- Reversible Clevis
- Heavy Duty Scrapers
- Cover Disk with Scraper

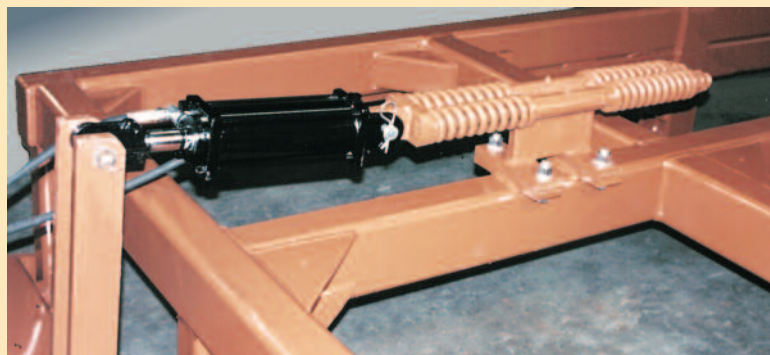

HYDRAULIC LEVELING from the tractor seat provides positive control for varying conditions. A set of four strong leveling springs takes the shock out of the leveling mechanism. Whether in transport or operation, front to rear leveling is controlled at your fingertips. (wide frame shown)



DISK BLADES on the 287 are supported by a four inch square boss on the spacer spools rather than riding on the axle. This extra area adds strength and durability.

DISK GANGS use a Heavy Duty Relube Ball Bearing which is Pillow Block Mounted to provide exceptional strength and dependability. The 287 has an adjustable angle of cut which ranges from 15° to an aggressive 25°.

TWO MAINFRAMES are available for the ATHENS 287 to match different widths and weight. The narrow frame shown here carries the 8', 9', and 10' gangs. The 8', 9', and 10' units have an average weight of (287-340) pounds per blade.



SPECIFICATIONS

WIDTH OF CUT	NUMBER OF DISKS	APPROXIMATE WEIGHT (lbs.)	NUMBER OF BEARINGS	**APPROXIMATE DBHP
8' 0"	17	5,750	8	120
9' 0"	19	6,165	8	135
10' 0"	21	6,505	8	150
WIDE FRAME				
12' 0"	25	8,710	8	180
14' 0"	29	9,473	8	210
16' 0"	33	10,005	12	240
*Approximate weight is given using 32" Disk Blades.				
** Recommended DBHP. Approximate DBHP is only a guide. Extremely hard, soft, hilly, or boggy conditions will change this figure. Approximate DBHP recommended is 15 HP per foot of cut.				
2" Square Axle, 12" Disk Spacing, and 28" x 32" Cutout Disk Blades				

ATHENS PLOW CO., INC. guarantees each piece of equipment against defective materials and workmanship for a period of one year from the date of delivery to the purchaser unless otherwise specified. ATHENS PLOW CO., INC. reserves the right to make changes and/or improvements in design and construction of parts or machines without notice or obligation.

ATHENS

MODEL 156



The Model 156 Chisel Plow has the quality and performance you are looking for in a chisel plow.



Designed for primary tilling, breaking hard pan for water filtration, plowing heavy crop stubble, or fallow plowing. Available in 3-point-lift models with plowing widths ranging from 5' to 16'. The 156 features rigid or spring mounted tines with 26" or 32" clearance. They can be equipped with a variety of ground engaging tools.

www.athensplowcompany.com

"WE PLOW THE EARTH"

STANDARD EQUIPMENT

- Tine Size – See Optional Equipment
- Tine Spacing - 12"
- Chisel Points - 5/8"
- Clearance, Frame to Point - 26" or 32"
- 2 Bar Extension Widths - 2' or 4'
- 3 Bar Extension Widths - 2', 4', or 6'
- Hitch – Category I, II, or III

OPTIONAL EQUIPMENT

- Tines:
1" x 2" x 26"
1" x 2" x 32"
1.25" x 2" x 32"
- Rigid or Spring Tine Attaching

EXTRA EQUIPMENT

- 3/8" Twisted Shovel
- 2' or 4' Extensions - 2 Bar Units
- 2', 4', or 6' Extensions - 3 Bar Units
- 15" Gauge Wheels, Adjustable
- Quick Coupler Adaptors - Category II & III

MODEL 156 SPECIFICATIONS

NUMBER OF TINES	TINE SPACING	EXTENSION WIDTHS	*APPROX WEIGHT (lbs)	**APPROX HP
2 BAR BASE				
5	12"	2' or 4'	737	50-60
7	12"	2' or 4'	1,001	70-85
11	12"	2' or 4'	1,573	110-130
3 BAR BASE				
7	12"	2', 4', or 6'	1,208	70-85
10	12"	2', 4', or 6'	1,628	100-120

*Approximate weight calculated using Spring Tine Attachment with 32" Tines and no Extensions.
 **Approximate horsepower (HP) is only given as a guide. Extremely hard, soft, hilly, or boggy conditions will change these figures.

FEATURES

FRAME

The Heavy Duty Frame is constructed of structural 4" x 4" steel tubing welded into a unitized one-piece frame. All high stress areas are reinforced to resist bending and twisting.

TINE SPACING

Tines are mounted 24" apart on the 2 Bar units and 36" apart on the 3 Bar units. Then they are staggered from front to rear with a spacing from the center of the unit yielding a 12" pattern.

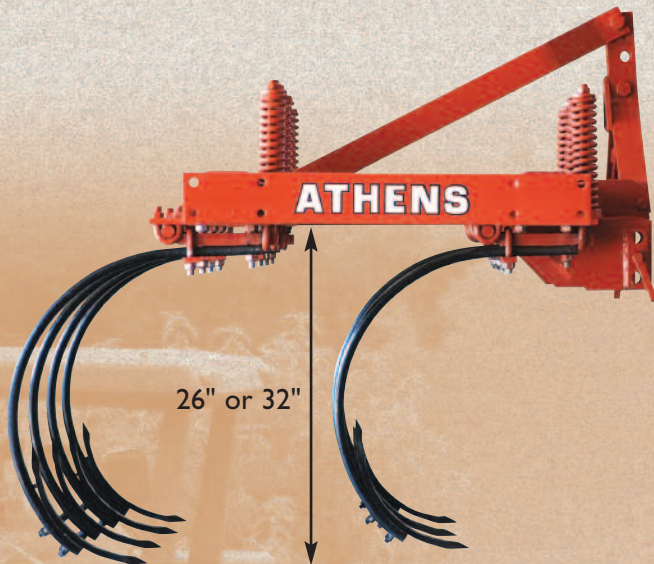

VERTICAL CLEARANCE

The Vertical Clearance between the chisel point and the bottom of the frame is 26" or 32" depending on the tine size.



SPRING TINE PIVOT ASSEMBLIES

Spring Tine Pivot Assemblies feature dual springs made of 1/2" oil tempered steel for strength and durability. The spring mounts are cast with internal and external helicals that match the ends of the springs. As the spring is stressed, the load is distributed evenly out the entire length of the spring to avoid stress concentrations.

THE RIGID TINE PIVOT ASSEMBLIES

Rigid Tine Pivot Assemblies are used where rocks are not a problem. Available on 5' and 7' 2-Bar units only.

Athens Plow Co., Inc. guarantees each piece of equipment against defective materials and workmanship for a period of one year from the date of delivery to the purchaser unless otherwise specified. Athens Plow Co., Inc. reserves the right to make changes and/or improvements in design and construction of parts or machines without notice or obligation.

www.athensplowcompany.com

Athens Plow Company, Inc. • PO Box 609 • Athens, TN 37371-0609