

# ***DS SERIES***

## ***KIOTI VALUE TRACTOR***



  
**KIOTI**<sup>®</sup>  
*run ahead of the pack*



# Exceptional quality and features in the DS series tractors

Keeps you *ahead of the pack*

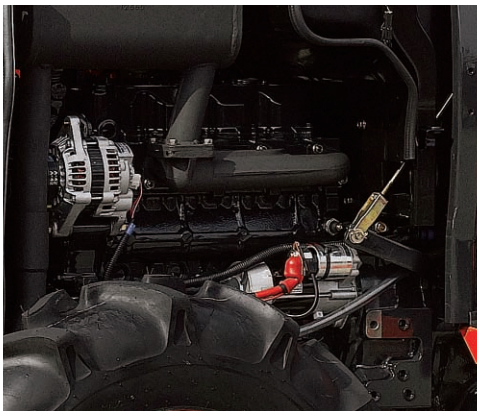
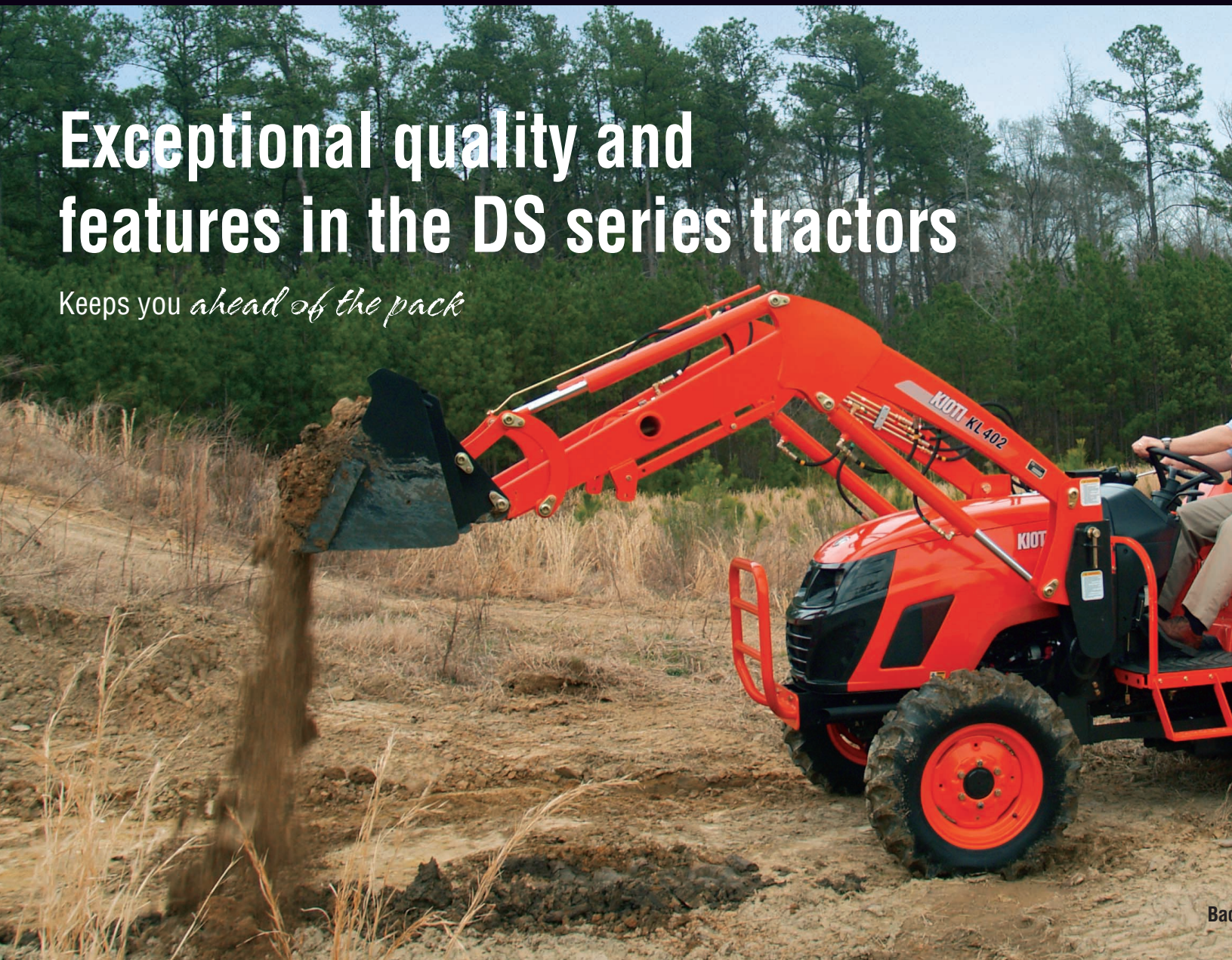

## Environmentally Friendly Engine

The Daedong engine complies with EPA Interim Tier4 standards with low emissions and proven performance and durability.



## Air Filter

The easily accessible air filter cartridge protects the engine from harmful particles and prolongs the life of the engine.



## Shuttle Lever

The DS series shuttle lever provides easy change from forward to reverse. The DS-HS series has a hydraulic clutch pack inside the transmission. You can change your direction with only the shuttle lever and without depressing the clutch. Simply shift the lever in the direction you desire to travel.





Backhoe Model : KB2485 Loader Model : KL402 Tractor Model : DS4510

### **Innovative Design**

The slanted hood design on the DS series tractors ensures the best visibility in its class as well as creating an attractive, sleek profile.

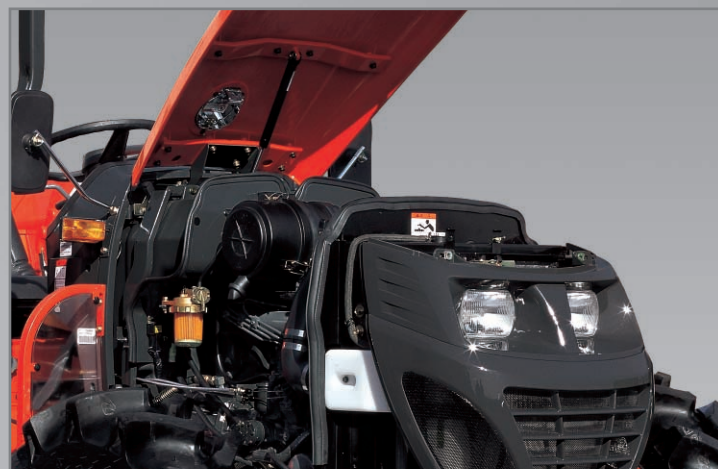

### **One Side Service**

The smart one side service design, lets you service the fuel filter, fuel system, engine oil filter, fill the oil and even change the air filter from the right side of the tractor. You can even check the engine oil level without opening the hood of the tractor!

### **Easy Open Hood**

Easily open the hood with the touch of just one knob.

### **High Flow Hydraulic Pump**

With a high flow hydraulic pump, performing multiple functions with either the backhoe or loader is simple with power to spare.





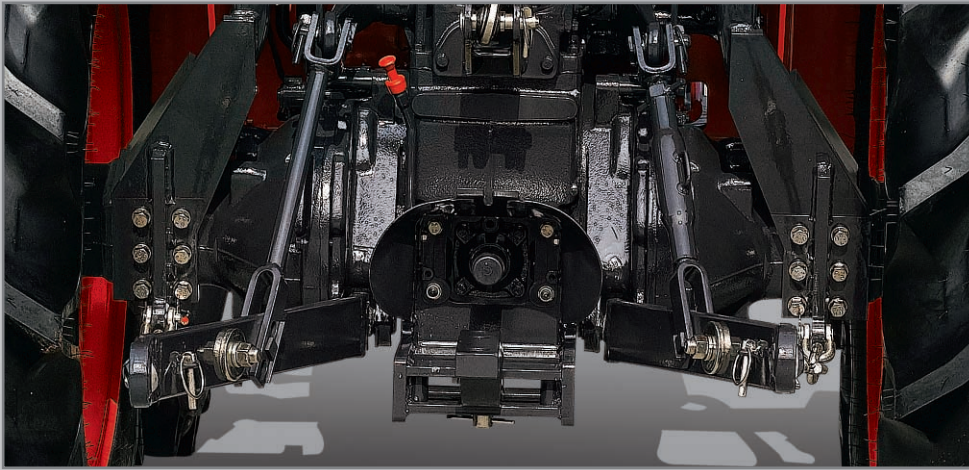

### **Independent PTO**

The electro-hydraulic PTO clutch allows you to turn the PTO ON and OFF with just a simple flip of a switch. A safety start switch prevents starting the tractor while the PTO is engaged. The PTO guard flips up so you can install the implement's drive shaft with ease.

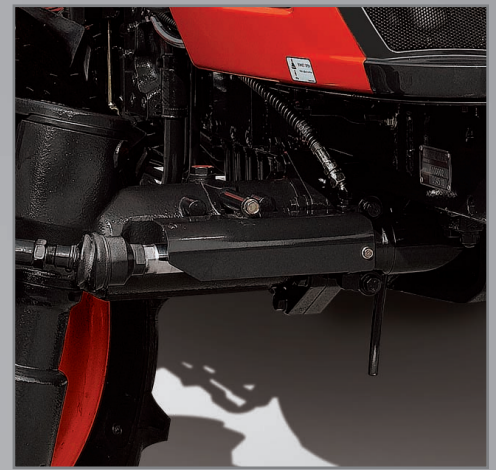

### **Front Axle**

A field proven front axle design ensures durability and strength for loader operations.

### **Lift Capacity**

With a lift of 2,425 lbs., the DS series Cat. 1 three point hitch has power to spare when carrying large implements, such as brush cutters, mowers and blades.

### **Foldable ROPS**

A fold-down roll bar makes it quick and easy to move in low clearance areas.

### **Power Steering**

Responsive, powerful and comfortable steering reduces operator fatigue. The robust power steering system is designed for maneuvering in soft soil and for front loader operation.

### **Heavy Duty Transmission**

The heavy duty design of the DS series transmission adds strength to the tractor chassis and provides excellent draw bar pull.

### **DS Series**

The DS series tractors are ready for any job that demands a durable tractor. An efficient engine, powerful lift capacity, convenient shuttle transmission, and sleek design makes the DS series tractor a great value.





Backhoe Model : KB2485 Tractor Model : DS4510

## Front End Loader

The Kioti KL402 loader is specifically designed for the DS series tractors, providing efficient performance with single joystick control. The Kioti loader is designed to be quickly and easily attached and detached.

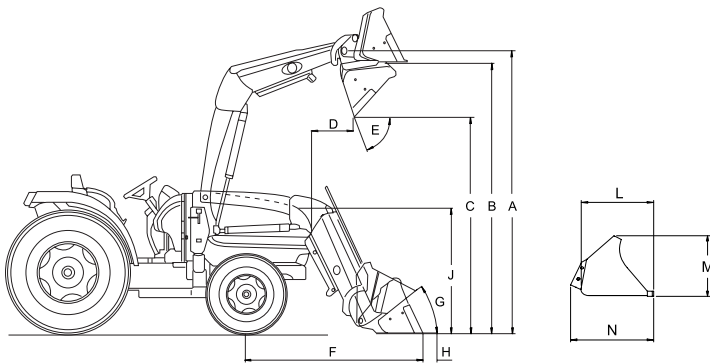

## Loader Specifications

### KL402

A	Maximum lift height to pivot pin	107.8"
B	Maximum lift height under level bucket	105.5"
C	Clearance with bucket dumped	79.9"
D	Reach at maximum lift height	16.1"
E	Maximum dump angle	73°
F	Reach with bucket on ground	73.6"
G	Maximum rollback angle	30°
H	Digging depth	-6.7"
J	Overall height in carry position	52.7"
L	Depth (Horizontal distance)	20.7"
M	Height (Overall vertical height)	22.6"
N	Length (Horizontal distance)	25.9"
	Lift capacity to maximum height at pivot pin	2,761 lbs
	Breakout force at pivot pin	3,727 lbs
	Bucket rollback force at ground line	2,990 lbs (@19.7°)
	Relief valve setting (Loader control valve)	2,556 psi
	Rated flow (Tractor hyd. system)	10 GPM
	Attachment (Bucket size)	66" (QA)

Cycle Times	1,500 rpm	2,000 rpm	2,600 rpm
Raise boom	7.6	5.7	4.5
Lower boom	4.9	4.8	4.7
Dump bucket	2.2	1.9	1.5
Retract bucket	2.3	2.2	2.1

## Backhoe

The subframe-mounted KB2485 backhoe can be easily attached and detached using locking pins and quick-connect hydraulics. The Backhoe's offset subframe design provides a large approach angle for the easiest trailer loading in its class.

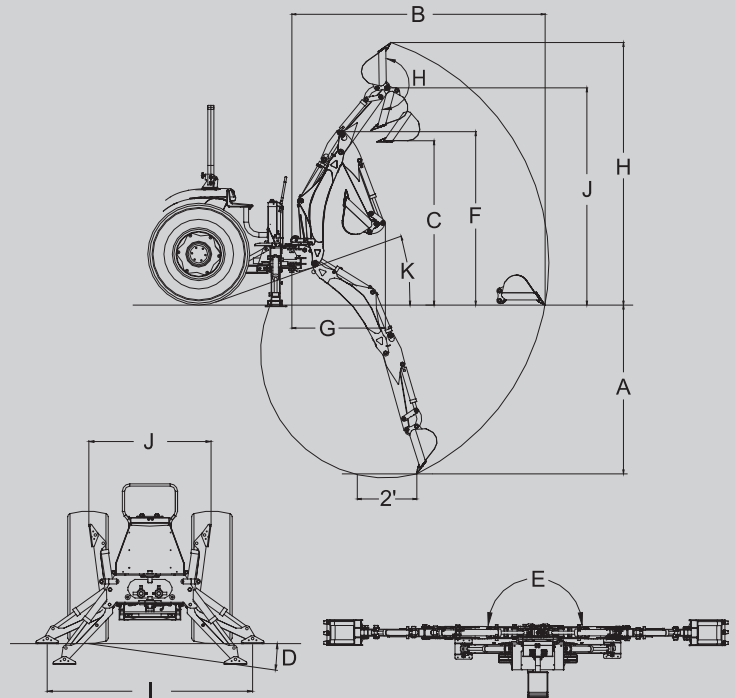

## Backhoe Specifications

### KB2485

A	Digging Depth (two foot flat bottom)	2,400 mm	94.4"
B	Reach from center line of Swing Pivot	3,460mm	136.1"
C	Loading Height (bucket at 60°)	2,040mm	80.3"
D	Maximum Leveling Angle	10°	10°
E	Swing Arc	180°	180°
F	Transport Height (maximum)	2,360mm	92.9"
G	Transport Overhang	1,280mm	50.4"
H	Bucket Rotation	180°	180°
I	Stabilizer Spread (down position)	1,745mm	68.7"
J	Stabilizer Spread (up position)	1,180mm	46.4"
K	Angle of Departure	21°	21°
	Shipping Weight (without bucket)	500Kg	1,102lbs
	Bucket Digging Force	1700Kg	3,748lbs
	Dipperstick Digging Force	1000Kg	2,205lbs
	Operating Pressure	170bar	2,466psi

## Cylinders

Cylinder	Bore DIA mm (inch)	Retracted Length mm (inch)	Stroke mm (inch)	Rod DIA mm (inch)
Boom	70 (2.75)	636 (25.04)	386 (15.20)	40 (1.57)
Bucket	60 (2.36)	630 (24.80)	395 (15.55)	35 (1.38)
Dipperstick	70 (2.75)	708 (27.87)	505 (19.88)	40 (1.57)
Swing	60 (2.36)	398 (15.67)	223 (8.78)	35 (1.38)
Stabilizer	60 (2.36)	446 (17.56)	262 (10.31)	35 (1.38)

## Buckets

Bucket	Teeth Q'TY	Struck Capacity	Heaped Capacity	Shipping Weight
9" Bucket	3	0.73 cu. ft.	0.87 cu. ft.	46 lbs
12" Bucket	3	1.01 cu. ft.	1.24 cu. ft.	56 lbs
16" Bucket	3	1.38 cu. ft.	1.76 cu. ft.	64 lbs
18" Bucket	4	1.56 cu. ft.	2.02 cu. ft.	70 lbs
24" Bucket	5	2.11 cu. ft.	2.82 cu. ft.	94 lbs
36" Bucket	6	2.78 cu. ft.	4.00 cu. ft.	114 lbs

Specifications and design are subject to change without notice.



# Specifications



ISO 9001  
NO:954596



ISO 14001  
NO:771475



OHSAS 18001  
NO:K033008

MODEL		DS4110	DS4110HS	DS4510	DS4510HS
ENGINE					
Model(INT. TIER 4)		4A200LWM		4A220LWM	
Type		4Cyl., In-line Vertical, Water-Cooled 4-Cycle Diesel Engine		4Cyl., In-line Vertical, Water-Cooled 4-Cycle Diesel Engine	
Engine Gross	HP(kW)	41(30.6)		45(33.6)	
PTO	HP(kW)	31.4(23.4)/2600		35.1(26.2)/2600	
Displacement	cu.in.(cc)	121.99(1999)		134.07(2197)	
Rated Revolution	rpm	2,600		2,600	
Fuel tank capacity	u.s.gal(ℓ )	11.9(45)		11.9(45)	
DRIVE TRAIN					
Clutch		Dry Single Stage		Dry Single Stage	
Transmission		Constant Mesh	Synchronized(Hydraulic. Clutch)	Constant Mesh	Synchronized(Hydraulic. Clutch)
Speeds		F8 / R8		F8 / R8	
Differential Lock		Rear Standard		Rear Standard	
Brake		Wet Disc		Wet Disc	
PTO		Hydraulic, Independent		Hydraulic, Independent	
Rear PTO (Standard)	rpm	540		540	
HYDRAULIC SYSTEM					
Pump		Gear(Tandem)		Gear(Tandem)	
Pump Capacity (Max. Flow Rate)	gpm(ℓ /min)	13.18(49.9)		13.18(49.9)	
3-Point Hitch		Cat. I		Cat. I	
Maximum Lift Capacity at 24" aft. of hitch	lbs.(kg)	2,425(1,100)		2,425(1,100)	
Hydraulic Lift Control System		Position Control		Position Control	
Steering		Hydrostatic Power Steering		Hydrostatic Power Steering	
TIRE SIZE					
Front AG.(TURF, INDUSTRIAL)		8-16/6 (27×8.5-15/4, 10-16.5/6)		8-16/6 (27×8.5-15/4, 10-16.5/6)	
Rear AG.(TURF, INDUSTRIAL)		13.6-24/6 (41×14-20/4, 14.9-24/6)		13.6-24/6 (41×14-20/4, 14.9-24/6)	
TRAVELING SPEEDS					
Forward at Rated Engine RPM	mph(km/h)	1.09~15.00(1.75~24.14)		1.09~15.00(1.75~24.14)	
Reverse at Rated Engine RPM	mph(km/h)	1.01~13.83(1.62~22.26)		1.01~13.83(1.62~22.26)	
DIMENSIONS					
Overall Length (includes 3-pt hitch)		in.(mm)	124.7 (3,168)	124.7 (3,168)	
Overall Width (minimum tread)		in.(mm)	62 (1,575)	62 (1,575)	
Overall Height (from top of ROPS)		in.(mm)	99 (2,515)	99 (2,515)	
Wheelbase		in.(mm)	72.8(1,850)	72.8(1,850)	
Min. Ground Clearance		in.(mm)	13.7 (348)	13.7 (348)	
Tread	Front(AG)	in.(mm)	49 (1,245)	49 (1,245)	
	Rear(AG)	in.(mm)	47.6~59.1 (1,209~1,501)	47.6~59.1 (1,209~1,501)	
Min. Turning Radius(with brake)		feet(mm)	9.8(3.0)	9.8(3.0)	
Weight with ROPS and AG Tires		lbs.(kg)	3,527(1,600)	3,538(1,605)	

Specifications and design are subject to change without notice.

## Standard Equipment

- Parking Brake
- Draw Bar
- Foldable Rops with Seat Belt
- Horn • Head Lamp
- 4WD • Power Steering
- Wet Disc Brakes • Independent PTO

## Optional Equipment

- Single&Dual. Remote Hyd. Valve
- Front Suit Case Weight
- Rear Wheel Weight
- Sunshade
- Working Lamp
- 7 Pin Trailer Plug

## Available KIOTI Attachments & Implements

- Front End Loader
- Backhoe
- Tiller
- Mower



### KIOTI Tractor Division

DAEDONG - USA, INC.  
6300 KIOTI Drive, Wendell, NC 27591  
toll free 877-GO-KIOTI • fax 919-374-5001  
web [www.KIOTI.com](http://www.KIOTI.com)



[www.Facebook.com/KiotiTractor](https://www.facebook.com/KiotiTractor)