



Go hard at work or at play –
but go in style!

Enjoy long rides in luxurious comfort, thanks to a sleek ergonomic design and a bold selection of never-before-seen color options, only in the new ARGO LX Series of 8x8 and 6x6 XTVs.

X SERIES



ROYAL
NAUTICA 6x6

ROYAL
NAUTICA 8x8

CRANBERRY
WINE 8x8

SILVER
SHADOW 8x8

CRIMSON
SHADOW 8x8

SUNSET
MAGIC 8x8



Upgraded front and
rear seat cushions



New soft-ride
tire system



High-speed
power pack



Easy entry steps
and handrails



Enhanced lighting package



Versatile entertainment
& communication console

SPECIFICATIONS FOR ARGO LX SERIES 8X8 AND 6X6

Vehicle	8X8 LX	6X6 LX
Engine	Kohler Aegis LH 775	Kohler Command Pro
Engine Warranty	3 year	
Type	4 cycle OHV V-Twin gasoline EFI engine, electronic ignition, full pressure lubrication and oil filter	
Horsepower	30	23
Displacement	747 cc	
Cooling	Liquid Cooled	Air Cooled
Starting	Electric	
Brakes	Hydraulic	
Steering	One-piece, ergonomic handlebar. Steering control features hand brake. For safety and ease of handling, the ARGO steering transmission provides continuous torque to all axles.	
Controls	Right-hand twist grip throttle. Light switch and ignition switch.	
Clutch	Belt-driven, Continuously Variable Transmission (CVT) maximizes engine power to the transmission.	
Transmission	ADMIRAL ⁷	
Drive System	Roller chain drive machined sprockets are spline-fit onto 1 1/4" diameter axles on the 6x6 and 1 3/8" diameter axles on the 8x8 and are protected with triple-sealed greaseable bearings.	
Frame	Formed steel channel construction, welded for high strength and durability. Protected with Bonderite® M-PP 930™ epoxy-acrylic autodeposition coating.	
Body	Vacuum formed High Molecular Weight Polyethylene	
Full Skid Plate	Standard	
Load Capacity ¹	On Land	1,000 lb. (450 kg)
	Rear Compartment	-----
	On Water	900 lb. (410 kg)
Towing Capacity ²	1,800 lb. (816 kg)	1,200 lb. (544 kg)
Seating Capacity ³	On Land	6 persons
	On Water	4 persons
Fuel Capacity	7.1 US gallons (27 litres) See-through polyethylene fuel tank. 8 hrs. operation ⁴	
Speed ⁵	On Land	25 mph (39.5 km/hr)
	On Water ⁶	3 mph (5 km per hour)
Shipping Weight	1,450 lb. (658 kg)	1,150 lb. (522 kg)
Dimensions (L X W X H)	124 x 60 x 47" (3,150 x 1,524 x 1,194 mm)	102 x 58 x 67" (2,591 x 1,473 x 1,702 mm)
Axle Bearing Extensions	Front - Standard, Rear - Standard	
Instrumentation	LCD Digital Gauge Cluster: Speedometer, Odometer, Voltmeter, Hour Meter, Tachometer, Low Oil Pressure and Parking Brake Reminder Lights	
Tires	ARGO AT189 25x12.00-9 NHS	ARGO AT189 24x10.00-8NHS
Ground Pressure	1.7 psi (13.5 kPa) using tires 0.67 psi (4.6 kPa) using tracks	
Ground Clearance	Tires	9.5" (240 mm)
	Tracks	11" (279 mm)
Operating Conditions	All weather, all terrain, -40°F to +104°F (-40°C to +40°C)	



220 Bergey Court, New Hamburg
ON, Canada N3A 2J5
Toll Free: **1-877-274-6288**
Tel: (519) 662-4000
Fax: (519) 662-2421
www.ARGOfxtv.com/LX-8x8
www.ARGOfxtv.com/LX-6x6

- Capacity includes occupants, cargo, outboard motor and fuel, and installed accessories. Max. outboard motor size 7.4 kW (9.9 hp).
- Towing capacity is approximate and depends on type of surface, load on vehicle as well as incline. Max Hitch Tongue Load (when equipped with hitch) 100 lb. (45 kg) for all models
- Subject to rear compartment load capacity limitations.
- Fuel consumption depends on load and operating conditions.
- All speeds are approximate and depend on conditions.
- Always wear approved Personal Floatation Device (PFD) when operating in water or on ice.
- ADMIRAL triple differential steering transmission with dedicated Hi and Low selector; Forward, Neutral, Reverse.

Some vehicle applications shown are for demonstration purposes, originating from third parties and not available from ARG0. In all cases vehicle load limits have been considered. For safety, always wear approved helmets and eye protection. When operating in water, always wear approved Personal Floatation Devices. Always remain seated while in the ARG0. When equipped with tracks, 678-064 Printed in Canada 03/2016

Take on extreme terrain with more comfort at higher speeds as you explore the most fragile terrain with minimal impact. In the new LX Series XTVs, premium finishes and detailing wrap up a full range of smart standard features and a host of specialty accessories to make ARG0 the ideal solution for offroading luxury.

Standard vehicle features:

- ARG0's exclusive tread pattern on large 25" (635 mm) tires
- A robust brushguard fends off impacts from brush, branches and more
- Front-mount 3,500 lb. (1,588 kg) WARN winch
- A built-in bilge pump operated from the dash
- Electronic ignition ensures easy starts in any weather
- Dual USB/12 V power outlets for phones, music players and GPS
- Lower skid plate slides over rocks, stumps and deadfalls
- A new interior lighting package brightly illuminates the passenger areas, cargo areas
- At-a-glance digital gauge cluster
- Upgraded carbon fiber dashboard
- Brake lights

8x8 features:

- Soft-ride system with new ultra-low pressure tires on dual beadlock aluminum rims
- Advanced LS drive train for top speeds up to 25% faster than previous ARG0s
 - ARG0 triple-differential steering transmission
 - Liquid-cooled 30 hp (22 kW) Kohler 748 cc EFI engine
- Long 8x8 wheel base with low center of gravity levels out rough terrain
- Large cargo capacity for up to 1,000 lbs. (450 kg) of passengers and supplies

Trim package features and accessories:

- Ergonomic seating design with upgraded front and rear cushions, adjustable front seat backrest to enjoy long outings with less fatigue; refined silver stitching and custom ARG0 embossing
- LX Series handrails and dual side entry steps
- ARG0 entertainment and communications system
 - Jensen® 4-channel 40 Watt sound system
 - Front and rear marine-duty speakers
 - Bluetooth streaming audio, iOS or Android wireless apps and USB port
- Chrome painted steel details

DIMENSIONS

Dimensions are approximate and dependent on final build specification.

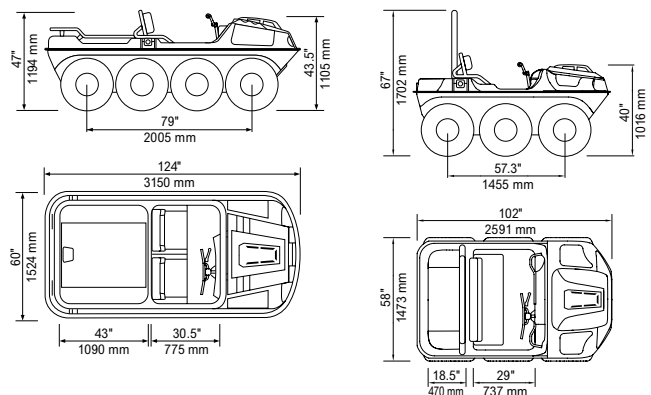

AVAILABLE ARG0 COLORS



Colors are reproduced with great care, but may vary slightly on actual vehicles.

ACCENT COLORS



LX Series 8x8



LX Series 6x6



Safety!
...always in Season!

treadlightly!
ON LAND AND WATER

Proud to be located in
Canada's
Technology
Triangle

MIX
Paper from
responsible sources
FSC® C023070