

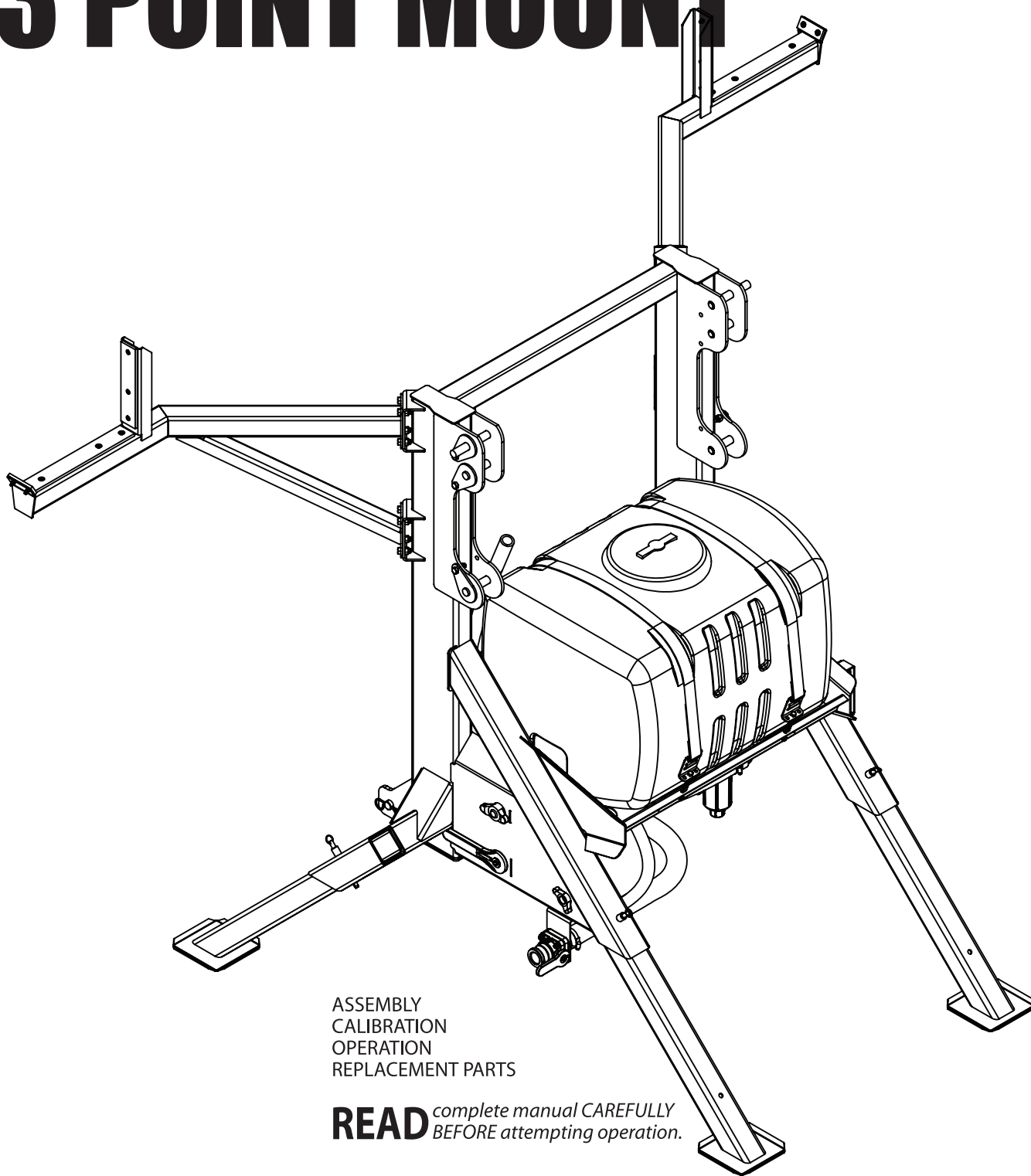

# Demco

## 3 POINT MOUNT



ASSEMBLY  
CALIBRATION  
OPERATION  
REPLACEMENT PARTS

**READ** complete manual CAREFULLY  
BEFORE attempting operation.

*Doing Our Best To Provide You The Best*

OPERATORS MANUAL

Thank you for purchasing a Demco product. We feel you have made a wise choice and hope you are completely satisfied with your new product. If you have any questions regarding the applications of certain solutions or chemicals, contact your chemical supplier and follow chemical manufacturer recommendations as well as all licensing and use restrictions or regulations.

## WARRANTY POLICY & REGISTRATION

Go online to [www.demco-products.com](http://www.demco-products.com) to review Demco warranty policies and register your Demco product.



**WARNING:** TO AVOID PERSONAL INJURY OR PROPERTY DAMAGE, OBSERVE FOLLOWING INSTRUCTIONS:

**Chemicals are dangerous. Know exactly what you're going to do and what is going to happen before attempting to work with these products. Improper selection or use can injure people, animals, plants and soil.**

**Always wear protective clothing such as coveralls, goggles and gloves when working with chemicals or sprayer.**

**Be sure to dispose of all unused chemicals or solutions in a proper and ecologically sound manner.**

## GENERAL INFORMATION

1. Unless otherwise specified, high-strength (grade5) (3 radial-line head markings) hex head bolts are used throughout assembly of this sprayer.
2. Whenever terms “**LEFT**” and “**RIGHT**” are used in this manual it means from a position behind sprayer and facing forward.
3. When placing a parts order, refer to this manual for proper part numbers and place order by **PART NO., DESCRIPTION, and COLOR.**

## Table of Contents

General information.....	2
Safety .....	3
Lighting And Marking .....	4
Safety Sign Locations .....	5
Spray Operation .....	6-8
Before Operation .....	9
During Operation.....	9-10
Following Operation .....	11
Performing Maintenance .....	12
Bolt Torque .....	13
3-Point Boom Mount Assembly & Parts Breakdown (Rear) .....	14
Plumbing Parts Breakdown.....	15-16
Valve Location .....	17
Sprayer Checklist .....	18

## SAFETY

TAKE NOTE! THIS SAFETY ALERT SYMBOL FOUND THROUGHOUT THIS MANUAL IS USED TO CALL YOUR ATTENTION TO INSTRUCTIONS INVOLVING YOUR PERSONAL SAFETY AND THE SAFETY OF OTHERS. FAILURE TO FOLLOW THESE INSTRUCTIONS CAN RESULT IN INJURY OR DEATH.



THIS SYMBOL MEANS

-ATTENTION

-BECOME ALERT

-YOUR SAFETY IS INVOLVED!

### SIGNAL WORDS

Note the use of the following signal words DANGER, WARNING, and CAUTION with the safety messages. The appropriate signal word for each has been selected using the following guidelines:

#### DANGER:

Indicates an imminently hazardous situation that, if not avoided, will result in death or serious injury. This signal word is to be limited to the most extreme situations typically for machine components which, for functional purposes, cannot be guarded.

#### WARNING:

Indicates a potentially hazardous situation that, if not avoided, could result in death or serious injury, and includes hazards that are exposed when guards are removed. It may also be used to alert against unsafe practices.

#### CAUTION:

Indicates a potentially hazardous situation that, if not avoided, may result in minor or moderate injury. It may also be used to alert against unsafe practices.

If you have questions not answered in this manual, require additional copies, or if your manual is damaged, please contact your dealer or Dethmers Mfg. Co., 4010 320th Street, Boyden, IA 51234

ph: (712) 725-2311 Toll Free: 1-800-543-3626 Fax: (712) 725-2380 [www.demco-products.com](http://www.demco-products.com)



# SAFETY...YOU CAN LIVE WITH IT



## EQUIPMENT SAFETY GUIDELINES

Every year many accidents occur which could have been avoided by a few seconds of thought and a more careful approach to handling equipment. You, the operator, can avoid many accidents by observing the following precautions in this section. To avoid personal injury, study the following precautions and insist those working with you, or you yourself, follow them.

In order to provide a better view, certain illustrations in this manual may show an assembly with a safety shield removed. However, equipment should never be operated in this condition. Keep all shields in place. If shield removal becomes necessary for repairs, replace the shield prior to use.

Replace any caution, warning, danger or instruction safety decal that is not readable or is missing. Location of such decals is indicated in this booklet.

Do not attempt to operate this equipment under the influence of alcohol or drugs.

Review the safety instructions with all users annually.

Operator should be a responsible adult. **DO NOT ALLOW PERSONS TO OPERATE OR ASSEMBLE THIS UNIT UNTIL THEY HAVE DEVELOPED A THOROUGH UNDERSTANDING OF THE SAFETY PRECAUTIONS AND HOW IT WORKS.**

To prevent injury or death, use a tractor equipped with a roll over protective system (ROPS). Do not paint over, remove, or deface any safety signs or warning decals on your equipment. Observe all safety signs and practice the instructions on them.

Never exceed the limits of a piece of machinery. If its ability to do a job, or to do so safely is in question- **DON'T TRY IT.**



## LIGHTING AND MARKING

It is the responsibility of the customer to know the lighting and marking requirements of the local highway authorities and to install and maintain the equipment to provide compliance with the regulations. Add extra lights when transporting at night or during periods of limited visibility.

Lighting kits are available from your dealer or from the manufacturer.



## SAFETY SIGN CARE

- Keep safety signs clean and legible at all times.
- Replace safety signs that are missing or have become illegible.
- Replaced parts that displayed a safety sign should also display the current sign.
- Safety signs are available from your distributor, dealer parts department, or the factory.

### **How to install safety signs:**

- Be sure that the installation area is clean and dry.
- Decide on the exact position before you remove the backing paper.
- Remove the smallest portion of the split backing paper.
- Align the decal over the specified area and carefully press the small portion with the exposed sticky backing in place.
- Slowly peel back the remaining paper and carefully smooth the remaining portion of the decal into place.
- Small air pockets can be pierced with a pin and smoothed out using the piece of decal backing paper.



## SAFETY SIGN LOCATIONS

Types of safety sign and locations on equipment are shown in illustration below. Good safety requires that you familiarize yourself with various safety signs, type of warning, and area or particular function related to that area, that requires your SAFETY AWARENESS.

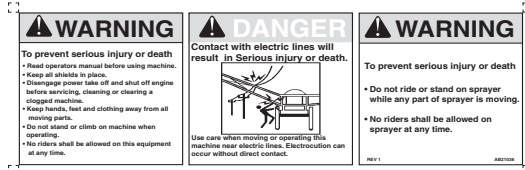
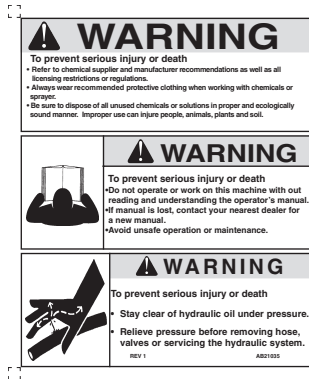
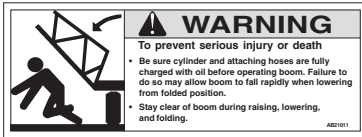
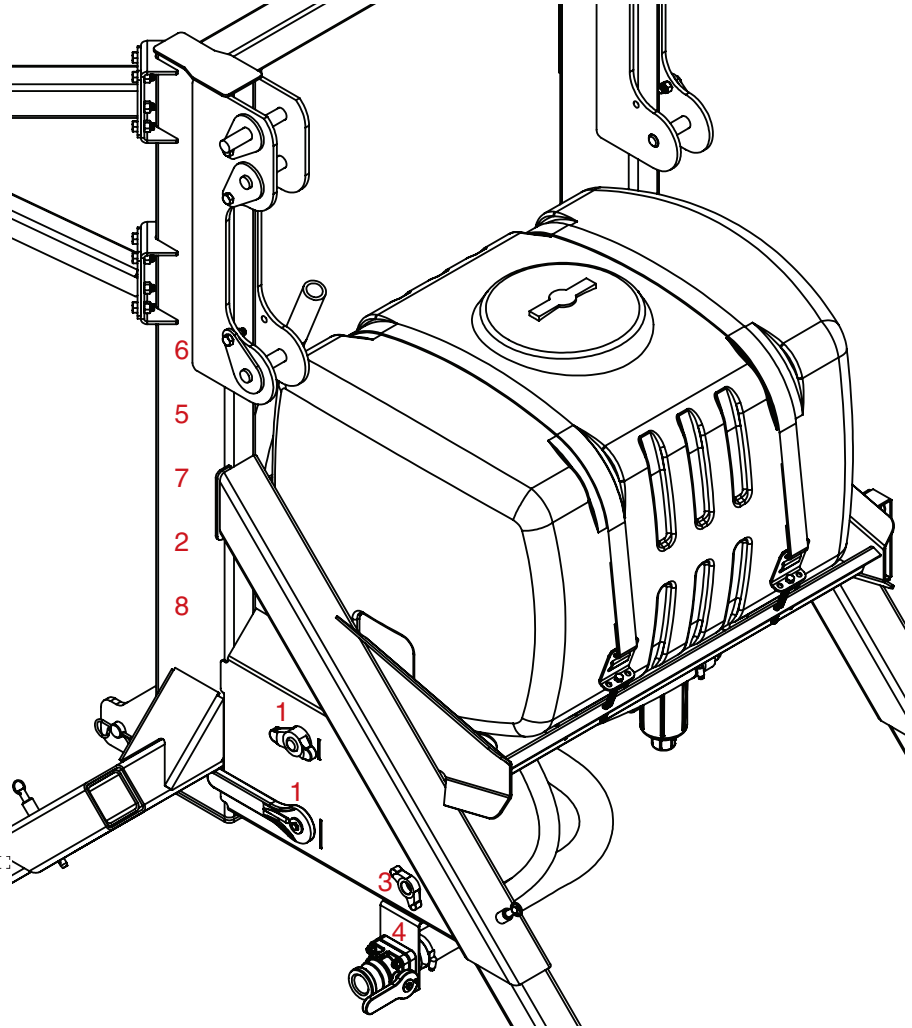
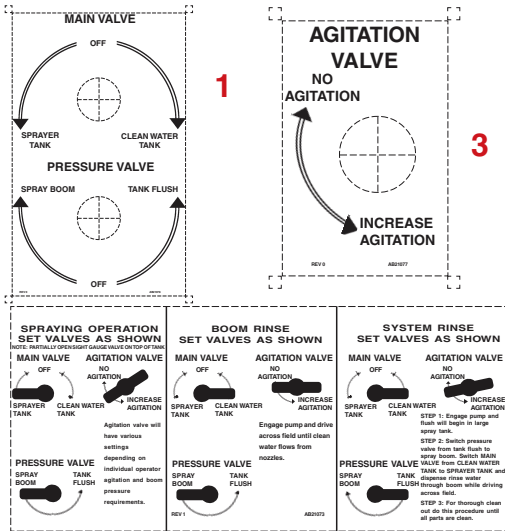

ITEM	PART #	DESCRIPTION	QTY
1	**AB21078	MAIN AND PRESSURE VALVE DIRECTIONAL DECAL	1
2	**AB21073	18 3/4" X 7" VALVE PANEL OPERATION INSTRUCTION DECAL	1
3	**AB21077	DECAL FOR AGITATION VALVE	1
4	**AB21079	DECAL FOR SPRAY TANK	1
5	*AB21011	6 3/8" X 2 3/8" WARNING DECAL FOR BOOM	2
6	*AB21019	5 7/8" X 5 7/8" WARNING DECAL FOR PINCHING HAZARD	2
7	*AB21035	11 7/8" X 3 7/8" THREE PANEL WARNING	1
8	*AB21036	6 7/8" X 5 3/4" TWO PANEL WARNING ONE PANEL DANGER	1

# **SPRAYING OPERATION SET VALVES AS SHOWN**

**NOTE: PARTIALLY OPEN SIGHT GAUGE VALVE ON TOP OF TANK**

## **MAIN VALVE**

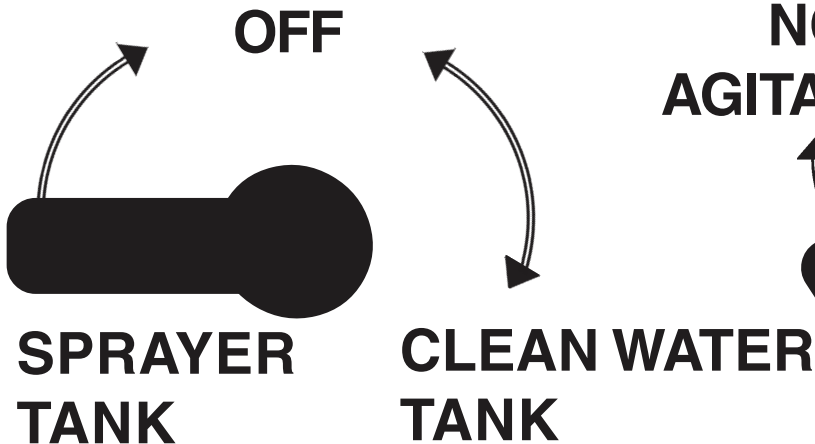

## **AGITATION VALVE**

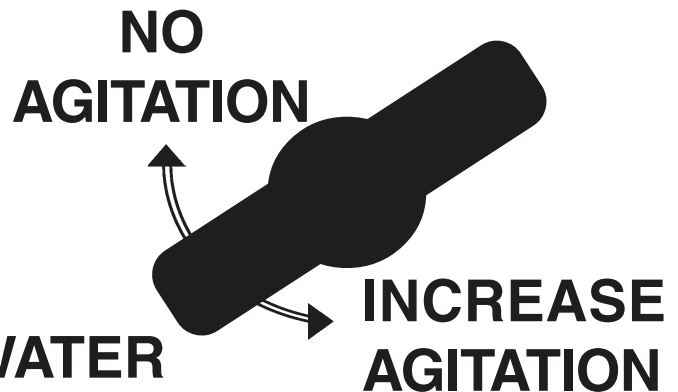

Agitation valve will have various settings depending on individual operator agitation and boom pressure requirements.

## **PRESSURE VALVE**

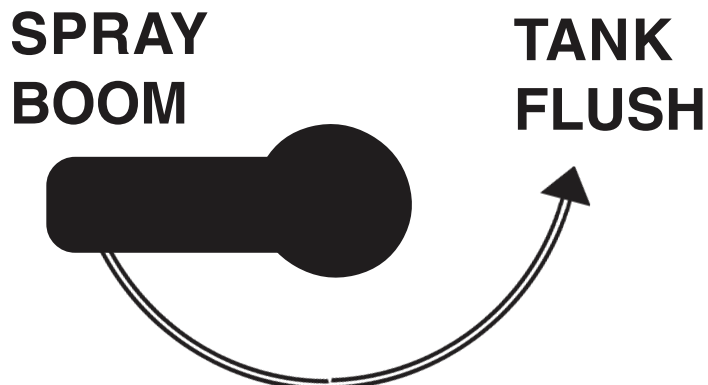

# **BOOM RINSE SET VALVES AS SHOWN**

## **MAIN VALVE**

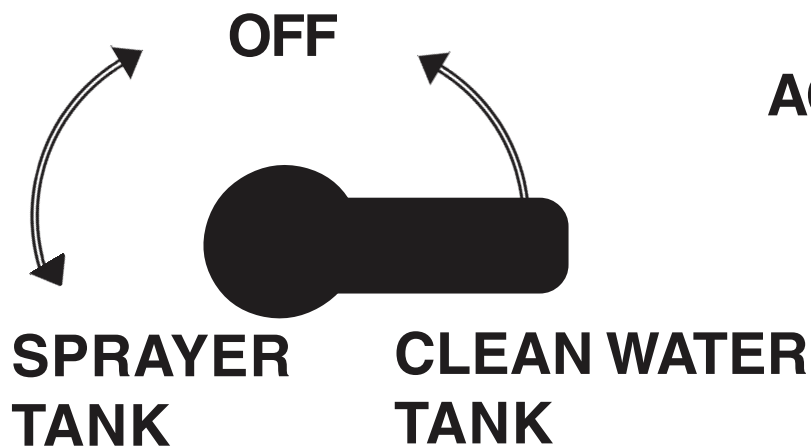

## **AGITATION VALVE**

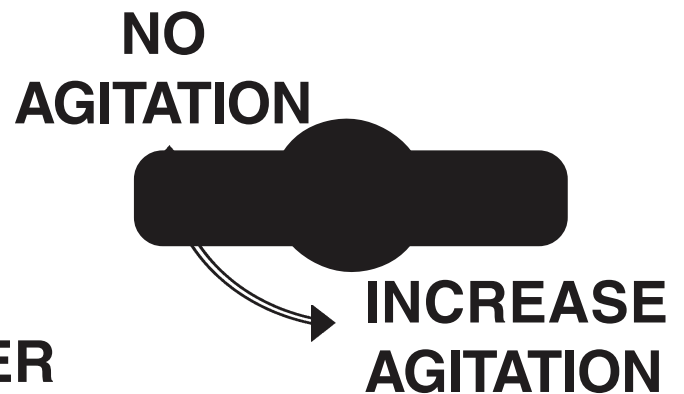

Engage pump and drive across field until clean water flows from nozzles.

## **PRESSURE VALVE**

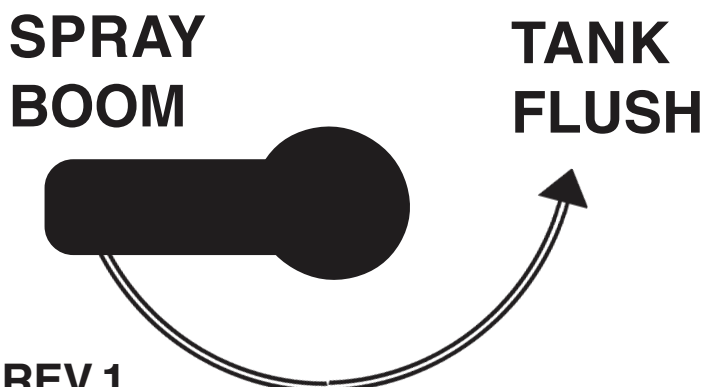

REV 1

AB21073

# SYSTEM RINSE SET VALVES AS SHOWN

## MAIN VALVE

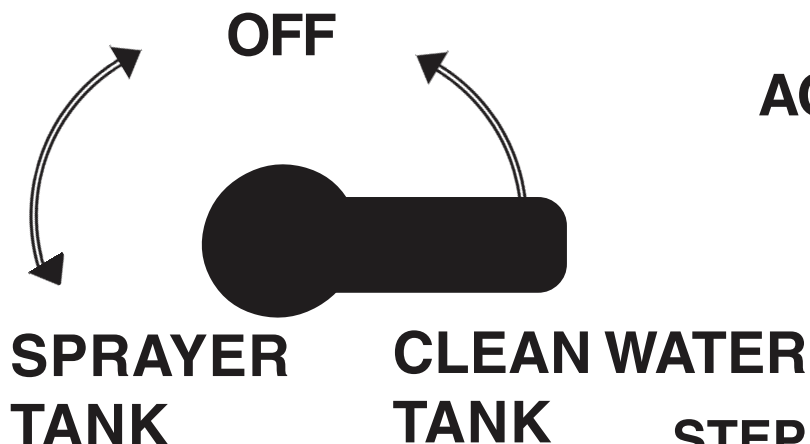

## AGITATION VALVE

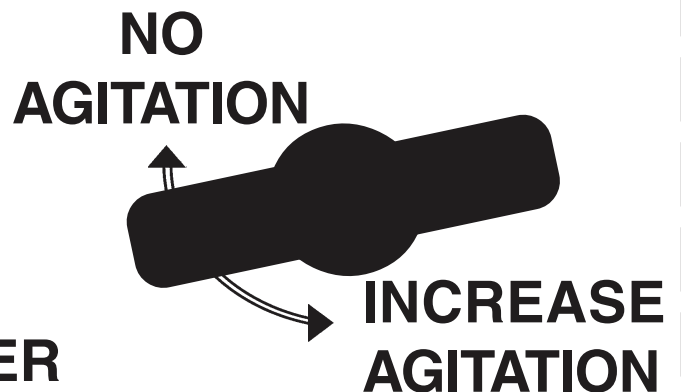

**STEP 1:** Engage pump and flush will begin in large spray tank.

**STEP 2:** Switch pressure valve from tank flush to spray boom. Switch MAIN VALVE from CLEAN WATER TANK to SPRAYER TANK and dispense rinse water through boom while driving across field.

**STEP 3:** For thorough clean out do this procedure until all parts are clean.

## PRESSURE VALVE

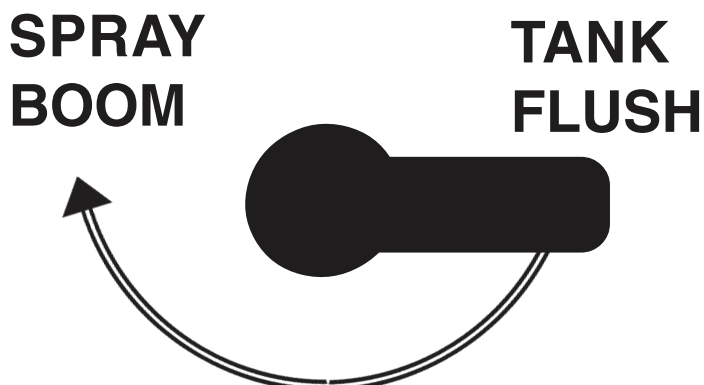





## **BEFORE OPERATION:**

- Carefully study and understand this manual.
- Do not wear loose-fitting clothing which may catch in moving parts.
- Always wear protective clothing and substantial shoes.
- It is recommended that suitable protective hearing and eye protection be worn.
- The operator may come in contact with certain materials which may require specific safety equipment relative to the handling of such materials. (Examples: extremely dusty, molds, fungus, bulk fertilizers, etc.)
- Keep wheel and lug nuts tightened to specified torque.
- Assure that agricultural implement tires are inflated evenly.
- Give the unit a visual inspection for any loose bolts, worn parts, or cracked welds, and make necessary repairs. Follow the maintenance safety instructions included in this manual.
- Be sure there are no tools lying on or in the equipment.
- Do not use the unit until you are sure that the area is clear, especially around children and animals.
- Don't hurry the learning process or take the unit for granted. Ease into it and become familiar with your new equipment.
- Practice operation of your equipment and its attachments. Completely familiarize yourself and other operators with its operation before using.
- Make sure that the brakes are evenly adjusted (if equipped with brakes)
- Use a tractor equipped with Roll Over Protection System (ROPS) and fasten your seat belt prior to starting the engine.
- The manufacturer does not recommend usage of a tractor with the ROPS removed.
- Move the tractor wheels to the widest recommended settings to increase stability.
- Securely attach to towing unit. Use a high strength, appropriately sized hitch pin with a mechanical retainer and attach a safety chain.
- Do not allow anyone to stand between the tongue or hitch and the towing vehicle when backing up to the equipment.



## **DURING OPERATION**

- **SAFETY CHAIN** -If equipment is going to be transported on a public highway, a safety chain should be obtained and installed. Always follow state and local regulations regarding safety chain and auxiliary lighting when towing farm equipment on a public highway. Be sure to check with local law enforcement agencies for your own particular regulations. Only a safety chain (not an elastic or nylon/plastic tow strap) should be used to retain the connection between the towing and towed machines in the event of separation of the primary attaching system.

- Install the safety chain by crossing the chains under the tongue and secure to the draw bar cage, hitch, or bumper frame.
- Beware of bystanders, **PARTICULARLY CHILDREN!** Always look around to make sure that it is safe to start the engine of the towing vehicle or move the unit. This is particularly important with higher noise levels and quiet cabs, as you may not hear people shouting.
- **NO PASSENGERS ALLOWED-** Do not carry passengers anywhere on or in the tractor or equipment.
- Keep hands and clothing clear of moving parts.
- Do not clean, lubricate, or adjust your equipment while it is moving.
- When halting operation, even periodically, set the tractor or towing vehicle brakes, disengage the PTO, shut off the engine, and **remove the ignition key.**
- Be especially observant of the operating area and terrain- watch for holes, rocks, or other hidden hazards. Always inspect the area prior to operation.
  - DO NOT operate near the edge of drop-offs or banks.
  - DO NOT operate on steep slopes as overturn may result.
  - Operate up and down (not across) intermediate slopes. Avoid sudden starts and stops.
- Pick the levellest possible route when transporting across fields. Avoid the edges of ditches, gullies, and steep hillsides.
- Be extra careful when working on inclines.
- Periodically clear the equipment of brush, twigs, or other materials to prevent buildup of dry combustible materials.
- Maneuver the tractor or towing vehicle at safe speeds.
- Avoid overhead wires or other obstacles. Contact with overhead lines could cause serious injury or death.
- Avoid loose fill, rocks, and holes; they can be dangerous for equipment operation or movement.
- Allow for unit length when making turns.
- Do not walk or work under raised components or attachments unless securely positioned and blocked.
- Keep all bystanders, pets, and livestock clear of the work area.
- Operate the towing vehicle from the operators seat only.
- Never stand alongside of unit with engine running or attempt to start engine and/or operate machine while standing alongside of unit.
- Never leave running equipment attachments unattended.
- As a precaution, always recheck the hardware on equipment following every 100 hours of operation. Correct all problems. Follow the maintenance safety procedures.



## FOLLOWING OPERATION

- Following operation, or when unhitching, stop the tractor or towing vehicle, set the brakes, disengage the PTO and all power drives, shut off the engine and **remove the ignition keys**.
- Store the unit in an area away from human activity.
- Do not park equipment where it will be exposed to livestock for long periods of time. Damage and livestock injury could result.
- Do not permit children to play on or around the stored unit.
- Make sure all parked machines are on a hard, level surface and engage all safety devices.
- Wheel chocks may be needed to prevent unit from rolling.



## HIGHWAY AND TRANSPORT OPERATIONS

- Adopt safe driving practices:
  - Keep the brake pedals latched together at all times. **NEVER USE INDEPENDENT BRAKING WITH MACHINE IN TOW, LOSS OF CONTROL AND/OR UPSET OF UNIT CAN RESULT.**

Always drive at a safe speed relative to local conditions and ensure that your speed is low enough for an emergency stop to be safe and secure. Keep speed to a minimum.

- Reduce speed prior to turns to avoid the risk of overturning.
- Always keep the tractor or towing vehicle in gear to provide engine braking when going downhill. Do not coast.
- Do not drink and drive!
- Comply with state and local laws governing highway safety and movement of farm machinery on public roads.
- Use approved accessory lighting flags and necessary warning devices to protect operators of other vehicles on the highway during daylight and nighttime transport. Various safety lights and devices are available from your dealer.
- The use of flashing amber lights is acceptable in most localities. However, some localities prohibit their use. Local laws should be checked for all highway lighting and marking requirements.
- When driving the tractor and equipment on the road under 20 mph (40 kph) at night or during the day, use flashing amber warning lights and a slow moving vehicle (SMV) identification emblem.
- Plan your route to avoid heavy traffic.
- Be a safe and courteous driver. Always yield to oncoming traffic in all situations, including narrow bridges, intersections, etc.
- Be observant of bridge loading ratings. Do not cross bridges rated lower than the gross weight at which you are operating.

- Watch for obstructions overhead and to the side while transporting.
- Always operate equipment in a position to provide maximum visibility at all times. Make allowances for increased length and weight of the equipment when making turns, stopping the unit, etc.



## **PERFORMING MAINTENANCE**

- Good maintenance is your responsibility. Poor maintenance is an invitation to trouble.
- Make sure there is plenty of ventilation. Never operate the engine of the towing vehicle in a closed building. The exhaust fumes may cause asphyxiation.
- Before working on this machine, stop the towing vehicle, set the brakes, disengage the PTO and all power drives, shut off the engine and **remove the ignition keys**.
- Be certain all moving parts and attachments have come to a complete stop before attempting to perform maintenance.
- **Always** use a safety support and block wheels. Never use a jack to support the machine.
- Always use the proper tools or equipment for the job at hand.
- Use extreme caution when making adjustments.
- Follow the torque chart in this manual when tightening bolts and nuts.
- Never use your hands to locate a hydraulic leak on attachments. Use a small piece of cardboard or wood. Hydraulic fluid escaping under pressure can penetrate the skin.
- When disconnecting hydraulic lines, shut off hydraulic supply and relieve all hydraulic pressure.
- Openings in the skin and minor cuts are susceptible to infection from hydraulic fluid. **Without immediate medical treatment, serious infection and reactions can occur.**
- Replace **all shields** and guards after servicing and before moving.
- After servicing, be sure all tools, parts and service equipment are removed.
- Do not allow grease or oil to build up on any step or platform.
- Never replace hex bolts with less than grade five bolts unless otherwise specified.
- Refer to bolt torque chart for head identification marking.
- Where replacement parts are necessary for periodic maintenance and servicing, genuine factory replacement parts must be used to restore your equipment to original specifications. The Manufacturer will not claim responsibility for use of unapproved parts and/or accessories and other damages as a result of their use.
- If equipment has been altered in any way from original design, the manufacturer does not accept any liability for injury or warranty.
- A fire extinguisher and first aid kit should be kept readily accessible while performing maintenance on this equipment.

# BOLT TORQUE

## TORQUE DATA FOR STANDARD NUTS, BOLTS, AND CAPSCREWS.

Tighten all bolts to torques specified in chart unless otherwise noted. Check tightness of bolts periodically, using bolt chart as guide. Replace hardware with same grade bolt.

NOTE: Unless otherwise specified, high-strength Grade 5 hex bolts are used throughout assembly of equipment.



### Torque Specifications

#### Bolt Torque for Standard bolts \*

"A"	GRADE 2		GRADE 5		GRADE 8	
	lb-ft	(N.m)	lb-ft	(N.m)	lb-ft	(N.m)
1/4"	6	(8)	9	(12)	12	(16)
5/16"	10	(13)	18	(25)	25	(35)
3/8"	20	(27)	30	(40)	45	(60)
7/16"	30	(40)	50	(70)	80	(110)
1/2"	45	(60)	75	(100)	115	(155)
9/16"	70	(95)	115	(155)	165	(220)
5/8"	95	(130)	150	(200)	225	(300)
3/4"	165	(225)	290	(390)	400	(540)
7/8"	170	(230)	420	(570)	650	(880)
1"	225	(300)	630	(850)	970	(1310)

#### Bolt Torque for Metric bolts \*

"A"	CLASS 8.8		CLASS 9.8		CLASS 10.9	
	lb-ft	(N.m)	lb-ft	(N.m)	lb-ft	(N.m)
6	9	(13)	10	(14)	13	(17)
7	15	(21)	18	(24)	21	(29)
8	23	(31)	25	(34)	31	(42)
10	45	(61)	50	(68)	61	(83)
12	78	(106)	88	(118)	106	(144)
14	125	(169)	140	(189)	170	(230)
16	194	(263)	216	(293)	263	(357)
18	268	(363)	--	--	364	(493)
20	378	(513)	--	--	515	(689)
22	516	(699)	--	--	702	(952)
24	654	(886)	--	--	890	(1206)

Torque figures indicated are valid for non-greased or non-oiled threads and heads unless otherwise specified. Therefore, do not grease or oil bolts or capscrews unless otherwise specified in this manual. When using locking elements, increase torque values by 5%.

\* GRADE or CLASS value for bolts and capscrews are identified by their head markings.

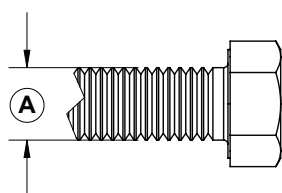

GRADE-2

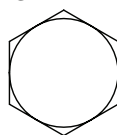

GRADE-5

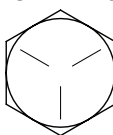

GRADE-8

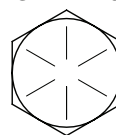

CLASS 8.8

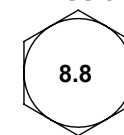

CLASS 9.8

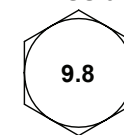

CLASS 10.9



## 3-POINT BOOM MOUNT ASSEMBLY

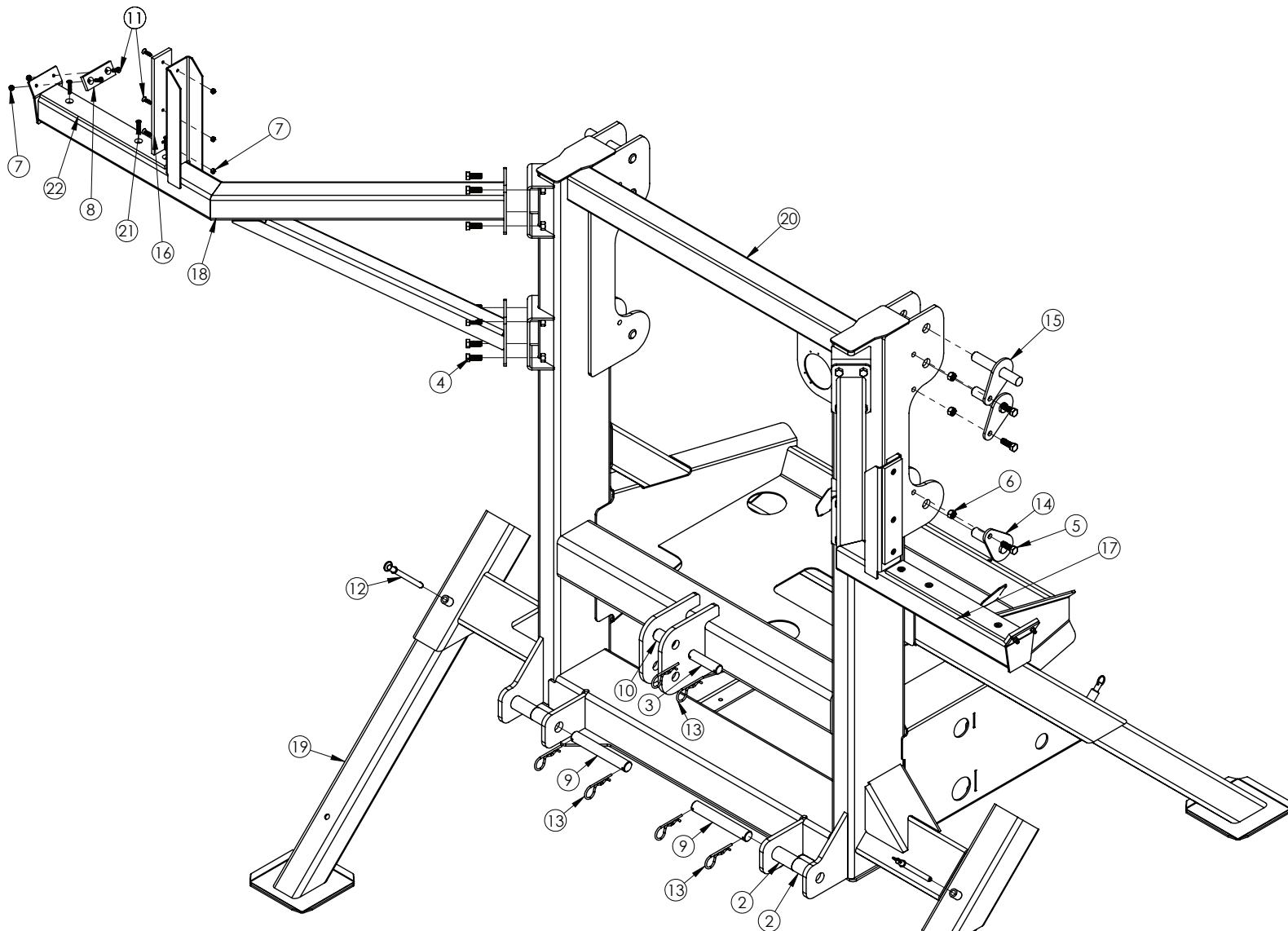

**NOTE: SEE FOAM MARKER OWNERS  
MANUAL FOR PART NUMBERS AND  
PART BREAKDOWN.**

ITEM	PART #	DESCRIPTION	QTY.
1.	00085	.50 FLAT WASHER	4
2.	00328	BUSHING	4
3.	00332	PIN, UPPER	1
4.	00967	BOLT, .50NC X 1.25	16
5.	01254	BOLT, .50NC X 1.50 GR.5 HEX	6
6.	02178	NUT, .50NC LOCK, NYLON INSERT	22
7.	02772	NUT, .25NC LOCK NYLON INSERT	10
8.	02946	PLATE, WEAR	2
9.	05382	PIN, LOWER	2
10.	05383	BUSHING	1
11.	07082	.25NC X 1.00 FLAT HD TORX	10
12.	10260	PIN .5 X 5.00 LONG QUICK-RELEASE RING GRIP	4
13.	11413	HAIR PIN .178 WIRE X 3 3/4	6
14.	11858-95	HEIGHT ADJUST LOCK PIN	4
15.	11859-95	HEIGHT ADJUST LOCK PIN	2
16.	12363	PLATE, WEAR 12"	2
17.	12672-76	LEFT WING REST	1
18.	12673-76	RIGHT WING REST	1
19.	12674-76	LEG ASSEMBLY	4
20.	12675-76	REAR MOUNT F/ FRONT FOLD BOOMS	1
21.	12683	BOLT, .25NC X 1.50 FLAT HD TORX F-POINT	6
22.	13015	WEAR PAD	2

Please order replacement parts by PART NO. and DESCRIPTION.



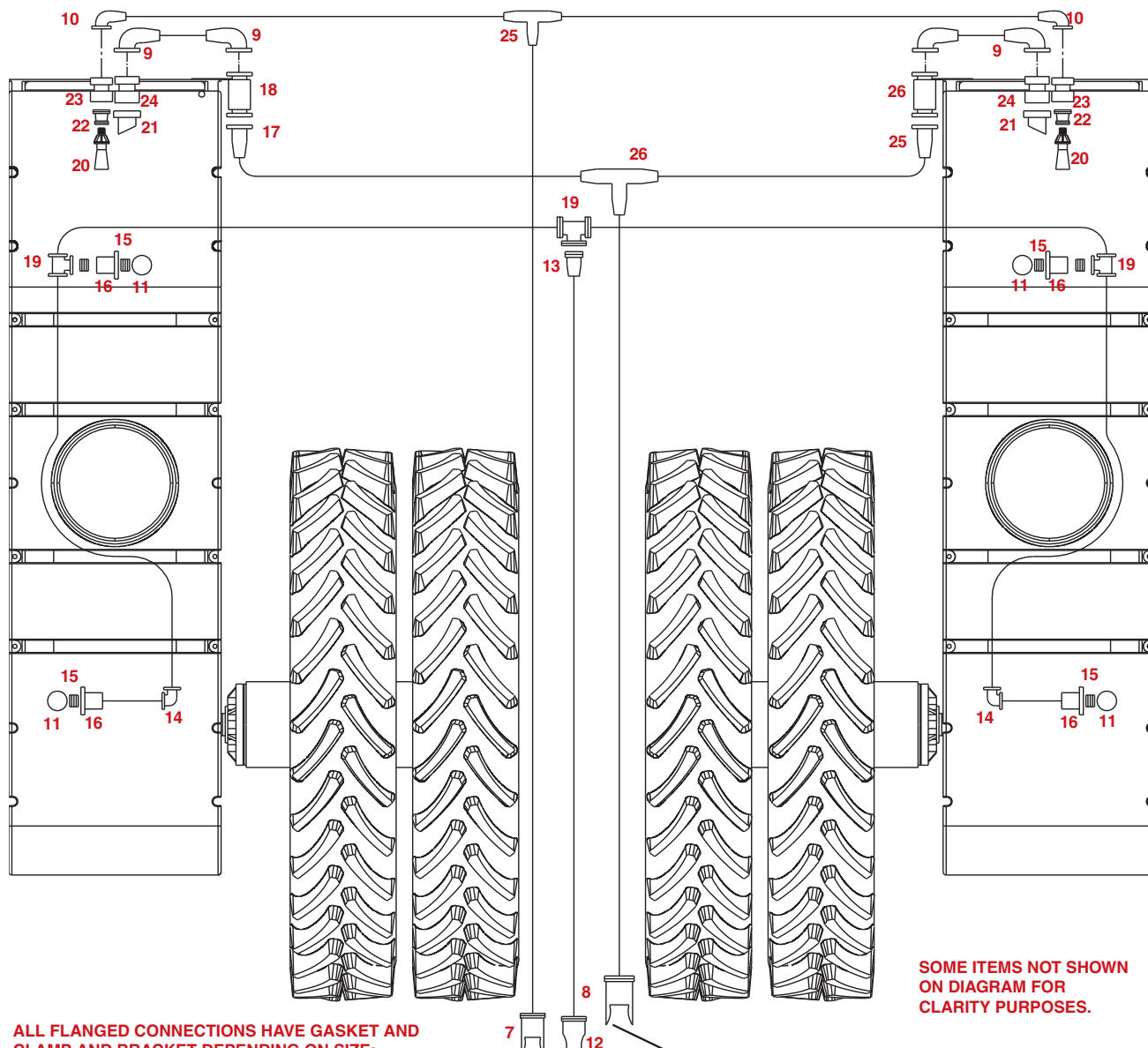

ALL FLANGED CONNECTIONS HAVE GASKET AND CLAMP AND BRACKET DEPENDING ON SIZE:  
(NOT SHOWN ON DIAGRAM)

1"- M100G & 09938  
2"- 112G & 09939  
2" FULL PORT- 200G & 09940

TO AGITATION TO RINSE TO PUMP  
SEE PAGE 19 FOR REAR MOUNT PLUMBING

SOME ITEMS NOT SHOWN ON DIAGRAM FOR CLARITY PURPOSES.

## PLUMBING PARTS BREAKDOWN

ITEM	PART #	DESCRIPTION	QTY.
1.	09938	1" CLAMP	2
2.	09939	1 1/2" CLAMP	6
3.	1010RB	1" SPIRAL AG HOSE	-
4.	112G	1 1/2" GASKET	10
5.	1140RB	1 1/4" SPIRAL AG HOSE	-
6.	340RB	3/4" SPIRAL AG HOSE	-
7.	633C1	1" HOSE ADAPTER	1
8.	633C2020	2" HOSE ADAPTER	1
9.	FEL200 200HB	2" FLG X 2" HB ELBOW	4
10.	FEL100 100HB	1" FLG X 1" HB ELBOW	2
11.	03813	SPRAY BALL	4
12.	633E1	1" QUICK COUPLER	1
13.	A3410	3/4" MPT X 1" HB STR.	1

Please order replacement parts by PART NO. and DESCRIPTION.

ITEM	PART #	DESCRIPTION	QTY.
14.	BEL1034	1" MPT X 3/4" HB ELBOW	2
15.	11067	1" MPT NIPPLE	4
16.	P100DA	1" OUTLET FITTING	4
17.	FA200 200HB	2" GLB X 2" HB STR.	2
18.	MV200CF	BALL VALVE 2" FLG 2 WAY	2
19.	T34F	3/4" FPT X 3/4" HB (2X) TEE	3
20.	09941	JET AGITATOR	2
21.	10267	2" ELBOWED SIPHON TUBE	2
22.	BRB1034	1" MPT X .75 FPT REDUCER	2
23.	FTF100	1" FLG TANK FITTING	2
24.	FTF200	2" FLG TANK FITTING	2
25.	T100	1" TEE HOSE BARB	1
26.	T200	2" TEE HOSE BARB	1

Please order replacement parts by PART NO. and DESCRIPTION.

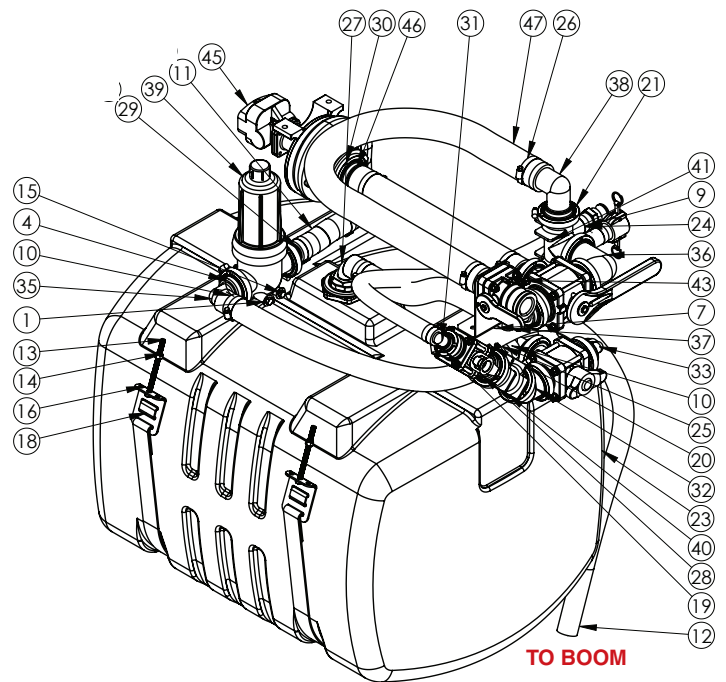
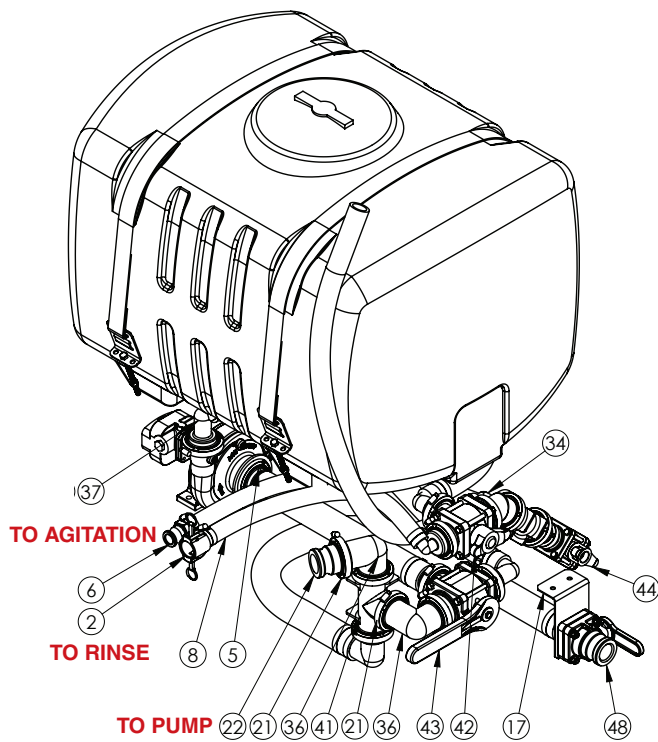

## PLUMBING PARTS BREAKDOWN

ITEM	PART #	DESCRIPTION	QTY.
1.	00059	.375 Flat Washer	2
2.	633C1	Quick Coupler 1" Hose Shank Female	1
3.	100G	Gasket, 1" ID x .25"	2
4.	112G	Gasket, 1 1/2" x .25"	8
5.	200G	Gasket, 2" x .25"	9
6.	633E1	Adapter, 1" HB for Quick Coupler	1
7.	1010RB (21")	1.50" Hose x 21" Tank to Valve	1
8.	1010RB (22")	1" Hose x 22" f/ Rinse Balls	1
9.	1010RB (45")	1" Hose x 45" Agitation	1
10.	1120RB (30")	1.50" Hose x 30" Pump to Valve	1
11.	1120RD (7")	1.50" Hose x 7" Pump to Filter	1
12.	1140RB (48")	1.25" Hose x 48" to Boom	1
13.	01885	Bolt, .375 NC x 5" Hex Full Thread	4
14.	02592	Nut, .375NC Nylon Lock	6
15.	05032	Bolt, .375 NC x 5.50" GR5 Hex	2
16.	05785	Plate, Strap Anchor	4
17.	09804	Quick Refill Bracket f/ Conq.	1
18.	09822	Strap Nylon 1.75 x 82" Black	2
19.	09938	Clamp, 1" f/ Flange Fitting	2
20.	09939	Clamp, 2" f/ Flange Fitting	8
21.	09940	Clamp, 2" f/ Flange Fitting Full Port	9
22.	13031	Adapter 2" FP Flange f/ 2" Quick Coupler	1
23.	13040	SPEC#157 W 1.50 Fitting Assem	1
24.	B16H	Clamp, Gear SS 1" Hose	4
25.	B32H	Clamp, Gear SS f/ 1.50" Hose	6
26.	B44H	Clamp, Gear SS f/ 2" Hose	4
27.	EL112	Fitting, Elbow 1.50" MPT x 1.50" HB	1
28.	FA200 100	Fitting, STR 2" FLG x 1" FLG	1
29.	FA200 150HB	Fitting, STR 2" FLG x 1.50" HB	1
30.	FA220 200HB	Fitting, STR 2" FLG x 2" HB Full Port	2
31.	FEL 100 100HB	Fitting, Elbow 1" FLG x 1" HB	1
32.	FEL200 45	2" Flange 45° Fitting	1
33.	FEL200 100HB	Fitting, Elbow 2" FLG x 1" HB	1
34.	FEL200 125HB	Fitting, Elbow 2" FLG x 1.25" HB	1
35.	FEL200 150HB	Fitting, Elbow 2" FLG x 1.50" HB	2
36.	FEL220	Fitting, Elbow 2" FP FLG x 2" FP FLG	2

Please order replacement parts by PART NO. and DESCRIPTION.

ITEM	PART #	DESCRIPTION	QTY.
37.	FEL220 150HB	Fitting, Elbow 2" FP FLG x 1.50" HB	2
38.	FEL220 200HB	Fitting, Elbow 2" FP x 2" HB	1
39.	FLST 150 50	TeeJet 126 Assembly	1
40.	FT200	Fitting, Tee 2" FLG (3X)	1
41.	FT220	Fitting, Tee 2" FLG (3X) FP	1
42.	FV200BLCF	Valve Ball FL. Port T-Handle 1" FLG x 1" FLG	1
43.	FV220BLCF	Valve Ball 2" FP 3-Way FLG BL	1
44.	MV100CF	Valve Ball FL. Port T-Handle 1" FLG x 1" FLG	1
45.	Pump	Ace Pum fmc 200f hyd 304	1
46.	S2020 (19.50")	2" Hose x 19.50" Main Valve to Pump	1
47.	S2020 (49")	2" Hose x 49" f/ Quick Refill	1
48.	VSFHB 200	Valve Ball 2" Coupler x 2" HB	1

Please order replacement parts by PART NO. and DESCRIPTION.



## VALVE LOCATION

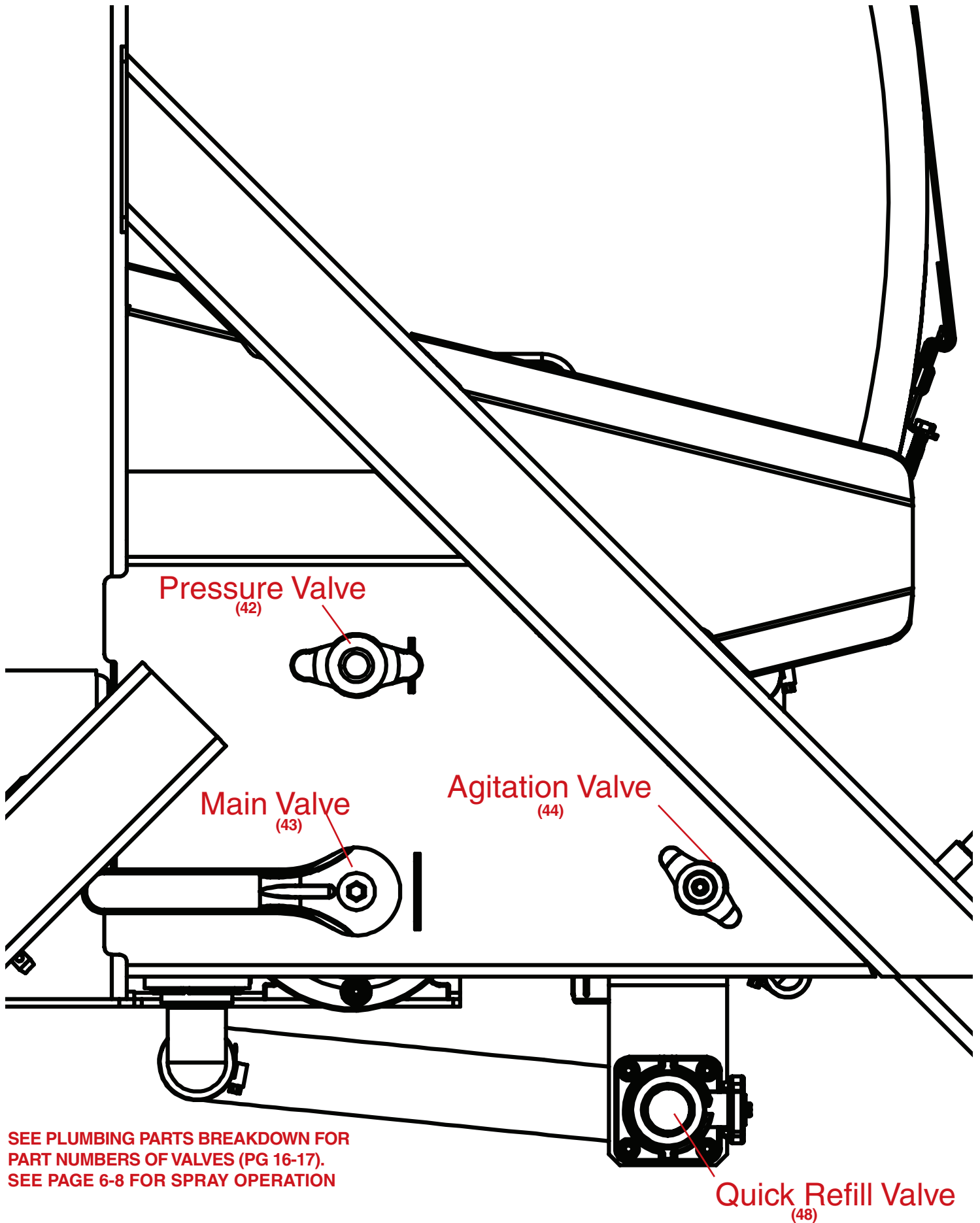

SEE PLUMBING PARTS BREAKDOWN FOR  
PART NUMBERS OF VALVES (PG 16-17).  
SEE PAGE 6-8 FOR SPRAY OPERATION

# SPRAYER CHECKLIST:

Downtime caused by field breakdowns is costly and time consuming. Many breakdowns can be eliminated by periodic equipment maintenance. By spending time reviewing this checklist before seasonal spraying application time and following proper after, season care, you can save time and money later.



## **WARNING:** To Prevent Serious Injury Or Death

- Keep hands, feet, and loose clothing away from rotating parts.
- Wear protective clothing recommended by your chemical and fertilizer manufacturer when working with chemicals.

### Check Before Going To The Field :

#### 1. NOZZLES

Check tip for excessive wear by checking for grooves in or near tip opening. Check nozzle spacing by starting at center and working outwards. Check boom for proper height.

#### 2. HOSES

Check all hoses for worn or soft spots. Be sure all hose clamps are tightened and hoses are not kinked or pinched. Check for leakage in any lines.

#### 3. TANK

Remove and clean agitator orifices. Check orifices for excessive wear by checking for grooves in or near orifice opening. Inspect fitting and grommets to insure they are in good condition.

#### 4. CONTROLS

Check for leakage, plugging, or wear on all valves, fittings, etc. Clean off any build up of foreign material.

#### 5. PUMP

Check to be sure pump turns freely.

#### 6. FRAME

Be sure all bolts are tightened.

#### 7. REPLACEMENT PARTS

Replace all worn or damaged parts.

### After Season Care:

**NOTE:** It is important to wear proper safety equipment when cleaning the sprayer . See your chemical or fertilizer package for this information.

1. After spraying chemicals, run water mixed with cleaners through tank, pump and all hose hookups. If wettable powder dries out in the system, it is very difficult to put back into suspension and can cause malfunction, damage or injury.
2. When cleaned, tank should have all openings closed or covered to keep dirt from entering.
3. Pump should be flushed with soluble oil and pump ports plugged to keep out moisture and air.
4. Disassemble tips and rinse with water or cleaning solution. (Appropriate for chemical sprayed).
5. Clean tip opening with a wooden toothpick. Never use wire or hard object that could distort opening.
6. Dispose of all unused chemicals or solutions in a proper and ecologically sound manner.
7. Water rinse and dry tips before storing.

---

**NOTE:** DEMCO does not and will not make any recommendations concerning application of various chemicals or solutions. These recommendations relate to either amount or procedure of materials applied. If you have any questions regarding application of certain chemicals or solutions, contact your chemical supplier and follow chemical manufacturer recommendations.





4010 320th St., BOYDEN, IA. 51234

PH: (712) 725-2311

FAX: (712) 725-2380

TOLL FREE: 1-800-54DEMCO (1-800-543-3626)

**[www.demco-products.com](http://www.demco-products.com)**

**Go online to [www.demco-products.com](http://www.demco-products.com) for Demco warranty  
policies & product registration.**