



Grain Carts and Wagons



Doing our Best to Provide You the Best

View all Demco Products on the web at: www.demco-products.com

The
“King”
 of
 Wagons

Gravity Flow Wagons



**Shortest turning radius
 in the industry**



Since the day our first gravity flow wagon was built, Demco has earned its reputation as the “King” of gravity flow wagons. Demco earned it by building wagons rugged and reliable.

Take a look. You'll find the Demco wagon loaded with innovative features and qualities that set the pace with farmers throughout North America. Demco incorporates the kind of quality that stands up when the demands get tough.

Features

- NEW Heavy Duty Torsion Bar Suspension on 550, 650 and 750 models provides superior frame to box flexibility, reduces stress and improves handling.
- Large, easy to operate handwheel.
- POSI-FLOW design incorporates 30° side pitch, 40° end pitch.
- 7" x 12" grain viewing windows.
- Center dump chute for pit unloading.
- Light kit consisting of two 4" amber lights and two 4" red lights for added road safety.
- Front mounted ladder has non-slip step with handrail on 550, 650 and 750 models.
- Heavy duty DEMCO running gears with structured tubing for bolsters.
- Heavy duty spindles rated for full capacity.
- 2-wheel brakes are standard on a 450 and 550 model wagon.
- 4-wheel brakes on 650 and 750 model wagons.
- One piece reach pipe for pull through rear hitch design.
- Safety chain.



One piece reach pipe for pull through rear hitch design on 450, 550, 650 and 750 models



365 & 450 - 2.8:1 sprocket ratio door opener



550, 650 & 750 - 3.7:1 sprocket ratio door opener with roller guides and chute light. Door stops at 1/4" increments.

NEW!

NEW!
750
WAGON



550/650 Models



750 Model

Heavy duty torsion bar suspension reduces wagon stress and improves ride and handling. (550 & 650 models - 750 models have Double Torsion Bar)



Ladder has handrails
and non-slip steps
(550, 650 & 750 models only)



Save 550, 650 & 750 Model Gr

valuable harvest time

Optional on 550, 650 and 750 model grain carts



ADJUSTABLE SPOUT

Demco's grain cart is built rugged for heavy loads. The chassis is extra heavy duty to stand up to fields with imperfect terrain when the cart is fully loaded. The Posi-Flow designed box insures hassle-free unloading.

The auger folds forward to provide excellent visibility of the grain flow when unloading. Driven by an automatic over-running slip clutch PTO shaft, the balanced auger and gearbox are protected from high torque start-ups associated with handling high moisture grain.

Features

- 1000 RPM PTO.
- 14" diameter balanced auger with 5/16" flighting and Posi-Lock connection.
- UltraFlyte™ made with 1008/1010 high carbon steel including a thicker outer edge, resulting in up to 50% longer wear and faster conveying.
- Automatic reset "cut-out" clutch with overrunning clutch to protect auger drive and tractor PTO
- Available with hydraulic drive. 15-25 GPM oil flow required, reduces auger speed.
- 30" hydraulic controlled flow gate.
- Auger positioned for operator visibility.
- Auger folds within the width of the box for compact transporting and storage.
- 2 grain viewing windows.
- Welded box construction with silicone sealed seams resists rust and corrosion.
- 7000 lb. drop-leg tongue jack with separate storage position provides tighter turning radius.
- Hand wheel operated clean-out door at bottom of auger for easy post season cleanup.
- Tail, flasher/turn signal lights and halogen auger spotlight for nighttime operation.
- Available with 120" fixed or 120" - 144" adjustable axle tread width.
- Transport width: 12' 9".
- Rear mounted SMV sign is standard.
- Transport safety chain.
- Optional roll top tarp.
- Optional adjustable auger spout.
- Optional ergonomic pendant control.
- Optional weigh scale kit and console with printer port

Convenient Ergonomic Pendant Grip Control (optional)



Model 3060

Model 640



Data Transfer Kit



Line Printer



POSI-DRIVE coupler eliminates noise and shock when engaging

Electronic weigh scale with accurate digital readout



Train Carts

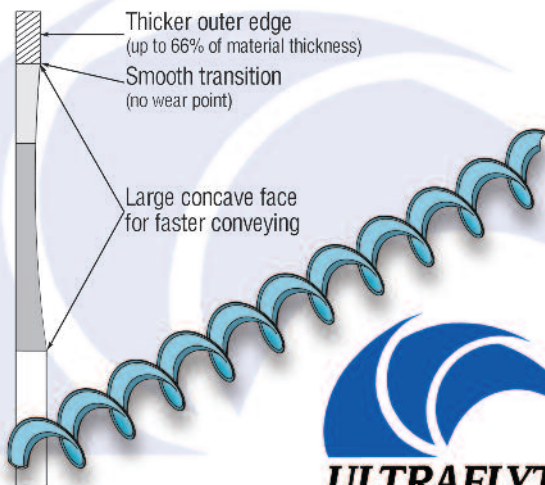

UltraFlyte™ flighting made of 1008/1010 high carbon steel



Hydraulic drive is optional (15-25 GPM oil flow required)



Hand wheel operated clean-out door



Roll up tarp



850, 1050 & 1150 Model C

**Unmatched
harvesting
efficiency**

Newly Designed Slope

improves unloading
and grain flow
for a complete
grain tank cleanout.

Demco's 1150 model unloads in 3 ½ minutes. The 1050 model unloads in 3 minutes. The 850 model unloads in 2 ¼ minutes. Their structure is designed to hold up under extreme field conditions where terrain is less than perfect. The box design insures that the grain flows fast enough to fill the unloading auger and provides speedy, hassle-free unloading.

The 18" auger folds forward for excellent unloading visibility. The auger is balanced and driven by an automatic over-running slip clutch PTO shaft that protects the gearbox from high torque start-ups and heavy high moisture grain.

Features

- 1000 RPM PTO.
- Hydraulic drive 35 - 40 GPM oil flow required, reduces auger speed.
- Automatic reset "cut-out" clutch with overrunning clutch to protect auger drive and tractor PTO
- 18" diameter balanced auger with 3/8" flighting and Posi-Lock connection.
- UltraFlyte™ made with 1008/1010 high carbon steel including a thicker outer edge, resulting in up to 50% longer wear and faster conveying.
- 30" hydraulic controlled flow gate.
- Auger positioned for operator visibility.
- Auger folds within the width of the box for compact transporting and storage.
- Grain viewing window.
- Welded box construction with silicone sealed seams resists rust and corrosion.
- 7000 lb. drop-leg tongue jack with separate storage position provides tighter turning radius.
- Hand wheel operated clean-out door at bottom of auger for easy post season cleanup.
- Tail, flasher/turn signal lights and halogen auger spotlight for nighttime operation.
- Available with 120" fixed or 120" - 144" adjustable axle tread width.
- Transport width with single wheels set on 120" centers: 12' 9"
- Transport safety chain.
- Adjustable auger spout.
- Optional roll top tarp.
- Optional ergonomic pendant control.
- Optional weigh scale kit and console with printer port

Hydraulic drive is optional (35 - 40 GPM oil flow and 2 remote outlets required)

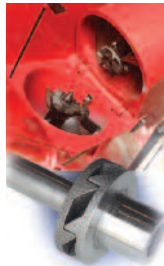

POSI-DRIVE coupler eliminates noise and shock when engaging



Model 3060



Model 640



Data Transfer Kit

Line Printer

Electronic weigh scale with accurate digital readout



**Convenient
Ergonomic
Pendant Grip
Control (optional)**

Grain Carts



Standard on 850, 1050 & 1150 models
Auger spout rotates 100° from side to side. This adjustment allows more precise unloading and easier approach to the target.

35,000 lb. Ductile Iron Hubs

NEW!
1150
GRAIN CART

Demco provides the best unloading visibility because our augers project further forward than any in the grain cart industry.

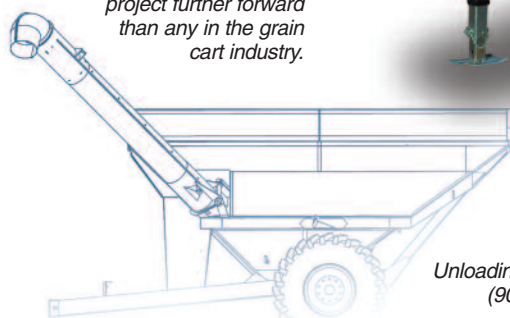

Unloading auger extends out and forward.
(90" ahead of the box)

Thicker outer edge
(up to 66% of material thickness)
Smooth transition
(no wear point)

Large concave face
for faster conveying

UltraFlyte™ flighting made of
1008/1010 high carbon steel



Ground Compaction Comparison

850 Loaded		1050 Loaded		1150 Loaded	
Tire Size		Tire Size		Tire Size	
24.5*32L	80 psi	NA		NA	
30.5*32L	62 psi	30.5*32L	74 psi	900R*32L	54 psi
900R*32L	42 psi	900R*32L	49 psi	1050R*32	47 psi
Tracks	12 psi	Tracks	15 psi	Tracks	10 psi



Optional track ride reduces field compaction by 77% compared to single wheels.

I 400 Model Grain Cart

Demco's I 400 model grain cart is capable of filling a semitrailer in 2.5 minutes. The structure is designed to hold up under extreme field conditions where terrain is less than perfect. The box design insures that the grain flows fast enough to fill the unloading auger and provides speedy, hassle-free unloading.

The 22" auger folds forward for excellent unloading visibility. The auger is balanced and driven by an automatic over-running slip clutch PTO shaft that protects the gearbox from high torque start-ups and heavy high moisture grain.



Oscillating inline duals minimize frame stress and field scuffing

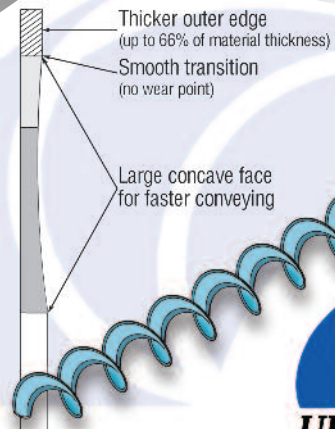

UltraFlyte™ flighting made of
1008/1010 high carbon steel





End delivery
distributes more
efficient flow.

Auger spout rotates 100° from side
to side. This adjustment allows more
precise unloading and easier
approach to the target.



Convenient
Ergonomic
Pendant Grip
Control (standard)



I 400 Model Grain Cart

Features

- Available with singles, tracks, or oscillating duals
- Modular box construction with silicone sealed seams
- 22" diameter computer balanced discharge auger with Posi-Drive connection
- Adjustable spout with end delivery for even flow unloading
- UltraFlyte™ made with 1008/1010 high carbon steel including a thicker outer edge, resulting in up to 50% longer wear and faster conveying.
- Forward positioned auger for optimum in-cab visibility
- Adjustable austempered cast hitch, fits category 4 or 5 hammerstrap tractor drawbar
- 30" hydraulic controlled flow gate
- Hydraulic drive drag auger (35 - 40 GPM, 2200 psi requires 2 remote tractor outlets)
- 1000 RPM PTO, 1.75"-20 spline - for unloading auger
- Pendant grip control & hydraulic block - 1 remote outlet performs 3 cart functions (auger fold, adjustable spout & auger flow gate)
- Automatic reset "cut-out" clutch with overrunning clutch to protect auger drive and tractor PTO
- Tail, flasher/turn signal lights and halogen auger spotlight for nighttime operation
- Weigh scale kit and console with printer port
- Grain viewing windows
- Transport safety chain.
- Optional roll top tarp.



POSI-DRIVE coupler eliminates noise and shock when engaging



Model 3060



Model 640



Line Printer

NOTES ON HYDRAULICS

A standard grain cart requires three hydraulic remotes:

Pendant Control manages slide gate, folding auger and adjustable spout and requires one hydraulic remote.

35 - 40 GPM oil flow is required for hydraulic drive drag auger (requires two hydraulic remotes).



Hydraulic orbit motor for driving horizontal auger eliminates belts and pulleys

Ground Compaction Comparison

1400 Loaded

Tire Size

76*50	50 psi
520*38 Duals	63 psi
Tracks	12 psi



Electronic weigh scale with accurate digital readout

Grain Cart Specifications

	Model 550	Model 650	Model 750	Model 850	Model 1050	Model 1150
Capacity	500 Bushels	650 Bushels	750 Bushels	850 Bushels	1000+ Bushels	1100+ Bushels
Balanced Auger Size	14"	14"	14"	18"	18"	18"
Unloading Time	2.5 min.	3 min.	3.5 min.	2 1/4 min.	3 min.	3 1/2 min.
Spindle Size	3 1/2"	4 1/2"	4 1/2"	4 1/2"	4 1/2"	5 1/2"
Tractor HP Required	125 +	150 +	150 +	175 +	175 +	175 +
Hub Size	10 Bolt - 11.25"	10 Bolt - 13.19"	10 Bolt - 13.19"	10 Bolt - 13.19"	10 Bolt - 13.19"	10 Bolt - 13.19"
Tread Width (Standard)	120"	120"	120"	120"	120"	147"
Tread Width (Optional)	120-144"	120-144"	120-144"	120-144"	120-144"	NA
Tongue Frame	4" X 8"	4" X 10"	4" X 10"	4" X 10"	4" X 10"	4" X 10"
Tongue Weight - (Empty)	1,060 lbs.	1,190 lbs.	1,240 lbs.	1,000 lbs.	1,120 lbs.	1,160 lbs.
Tongue Weight - (Loaded)	2,300 lbs.	2,600 lbs.	2,900 lbs.	3,800 lbs.	4,600 lbs.	NA
Roll Top Tarp	Optional	Optional	Optional	Optional	Optional	Optional
Scale	Optional	Optional	Optional	Optional	Optional	Optional
Weight/Wheels & Tires	7,000 lbs.	7,560 lbs.	8,220 lbs.	10,490 lbs.	11,600 lbs.	14,000 lbs.

Physical Size

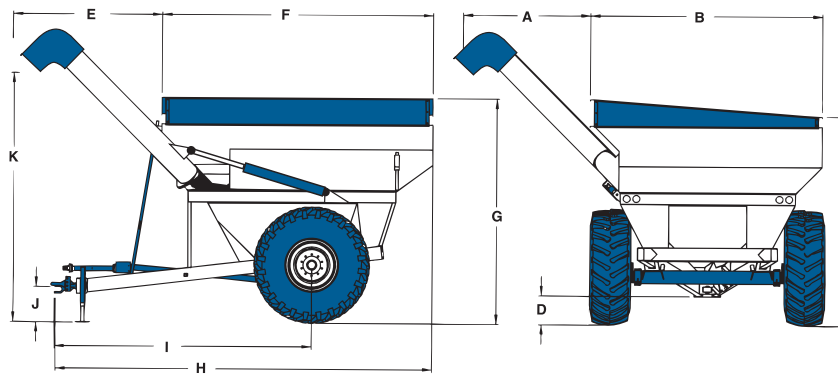

A Auger Extends to Side	7' 7"	7' 7"	7' 7"	9' 5"	9' 5"	9' 5"
B Box Width (Transport Width)	11' 11"	11' 11"	11' 11"	12'	13' 3"	14' 5"
C Height, Low Side	9' 7"	10' 11"	11' 1"	11'	11' 7"	11' 5"
D Axle Ground Clearance	18"	18"	18"	17"	17"	16 1/2"
E Auger Extends to Front	7' 1"	7' 1"	7' 1"	7' 6"	7' 6"	7' 6"
F Box Length	14'	14'	14'	20' 1"	20' 1"	20' 1"
G Box Height (High Side)	10' 3"	11' 9"	12' 6"	12'	12' 9"	12' 9"
H Total Length	20'	20'	20'	25' 11"	25' 11"	25' 11"
I Axle to Tongue Length	13' 6"	13' 6"	13' 6"	15' 3"	15' 3"	15' 3"
J Drawbar/Tongue Height	22"	22"	22"	18"	18"	18"
K Auger Clearance Height	14'	14'	14'	14' 9"	14' 9"	14' 9"

Some dimensions may vary due to tire sizes.

Grain Wagon Specifications

	Model 365	Model 450	Model 550	Model 650	Model 750
Capacity	365 Bushels	450 Bushels	550 Bushels	650 Bushels	750 Bushels
Approximate Weight - (Empty) W/22.5 Tires	3,620 lbs.	4,360 lbs.	5,972 lbs.	6,500 lbs.	7,100 lbs.
Box Width	7' 11"	8' 1"	9' 6"	9' 6"	9' 6"
Box Length	12'	14'	16'	16'	16'
Over All Height W/22.5 Tires	9' 5"	9' 8"	9' 6"	10' 4"	11' 1"
Unloading Time	50 Seconds	55 Seconds	70 Seconds	85 Seconds	95 Seconds
Spindle Size	2 3/4"	3"	3"	3 1/2"	3 1/2"
Hub Size	8 Bolt - 6"	8 Bolt - 6"	8 Bolt - 6"	10 Bolt - 8.71"	10 Bolt - 8.71"
Turning Diameter	31' 8"	35' 9"	37'	37'	37'
Roll Top Tarp	Optional	Optional	Optional	Optional	Optional
Fenders	NA	NA	Optional	Optional	Optional
Door Opening	40"	48"	60"	60"	60"

Grain Cart Specifications

Model 1400

Capacity	1400 Bushels W/Duals	76 X 50 Singles	Tracks
Balanced Auger Size	22"	22"	22"
Unloading Time	2.5 min.	2.5 min.	2.5 min.
Spindle Size	3 1/2"	5 1/2"	-
Tractor HP Required	275	275	275
Hub Size	10 Bolt 13.19"	10 Bolt 13.19"	-
Width Of Tire/Track	144"	158"	152"
Tongue Frame	4"x10"	4"x10"	4"x10"
Tongue Weight - (Empty)	2,500 lbs.	2,500 lbs.	2,500 lbs.
Tongue Weight - (Loaded)	6,000 lbs.	6,000 lbs.	6,000 lbs.
Roll Top Tarp	Optional	Optional	Optional
Scale	Standard	Standard	Standard
Weight/Wheels & Tires	17,200 lbs.	-	-

Physical Size

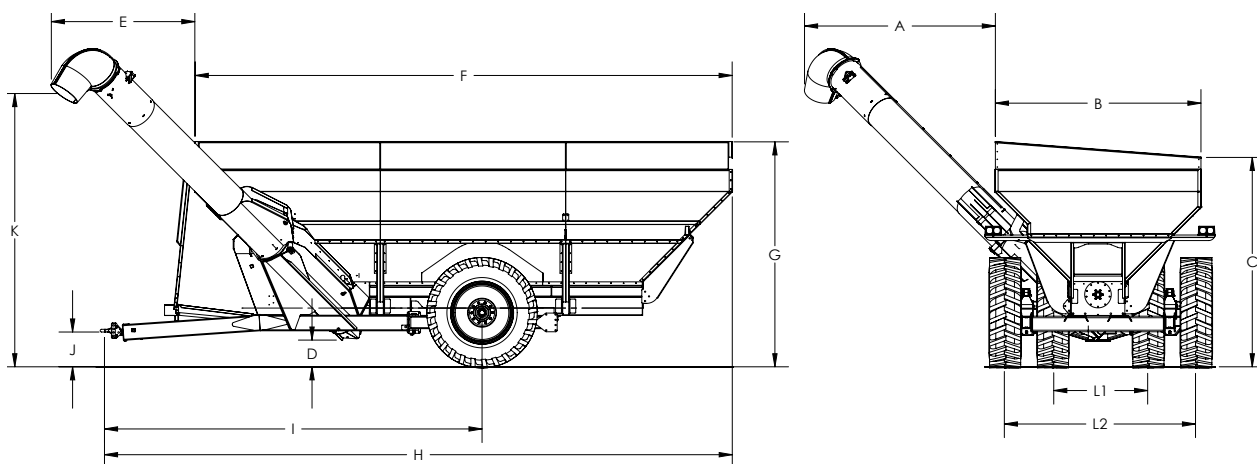

A Auger Extends to Side	10' 2"
B Box Width (Transport Width)	11'
C Height, Low Side	11' 2"
D Axle Ground Clearance	17"
E Auger Extends to Front	7' 8"
F Box Length	28' 9"
G Box Height (High Side)	11' 11"
H Total Length	33' 1"
I Axle to Tongue Length	20' 2"
J Drawbar/Tongue Height	21"
K Auger Clearance Height	14' 6"
L Tread Width	60" inner duals 120" outer duals

Some dimensions may vary due to tire sizes.

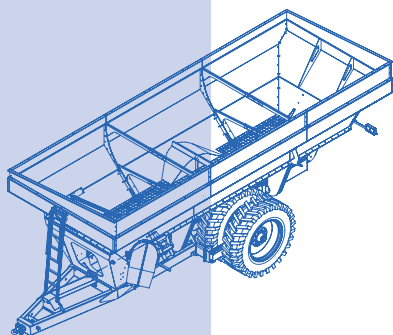

Demco

P.O. Box 189 • 4010 320th Street • Boyden, Iowa 51234
 Phone: 1-800-543-3626 • Fax: 1-800-845-6420
 View all Demco Products on the web at: www.demco-products.com

DOING OUR BEST TO PROVIDE YOU THE BEST