

Round and Square Bale Wrappers

## RW – SW Series



[www.kuhn.com](http://www.kuhn.com)



**Invest in Quality®**



# KUHN BALE WRAPPER

## BALES WRAPPED TO PERFECTION!

### TOP QUALITY BALE WRAPPING

Every step in the wrapping process has to be coordinated, taking in account crop conditions, field conditions and weather forecasts as well as crop handling and storage. Perfectly wrapped bales combined with high output and outstanding durability make KUHN wrappers a profitable investment.

### UNMATCHED RELIABILITY

KUHN brings cost efficient, ecological and ergonomic bale wrapping solutions with a complete range of reliable round and square bale wrappers. KUHN wrappers are designed to perform under all circumstances.

### KEEPING AHEAD WITH NEW INNOVATIONS

KUHN continually strives to improve its round and square bale wrappers with new innovations like: IntelliWrap, AutoLoad, Autoswitch and e-Twin technology.

## WRAPPERS

### RW/SW Series

#### in brief



Model	Round Bales	Square Bales
RW 1110	4 x 5 (1.22 x 1.5 m)	•
RW 1410	4 x 5 (1.22 x 1.5 m)	•
RW 1610	4 x 5 (1.22 x 1.5 m)	•
SW 1114	5 x 5 (1.5 x 1.5 m)	2 x 3 (.61 x .92 m) & 3 x 3 (.92 x .92 m)
SW 1614	5 x 5 (1.5 x 1.5 m)	2 x 3 (.61 x .92 m) & 3 x 3 (.92 x .92 m)
SW 4014	5 x 5 (1.5 x 1.22 m)	2 x 3 (.61 x .92 m), 3 x 3 (.92 x .92 m), 3 x 4 (1.22 x .92 m), 4 x 4 (1.22 x 1.22 m)





# FAST AND RELIABLE WRAPPING

KUHN bale wrappers' unique features make them stand out from the competition. The pre-stretchers, film cutters, wrapping table and low-profile chassis design make KUHN bale wrappers simple, easy-to-use, fast and efficient.

## FILM CUTTERS

Once the desired number of film layers have been applied, the film is then held firmly and cut. On the turntable wrapper models, a spring-loaded or hydraulic high-grip film cutter holds and cuts the film automatically without the need for extra controls. On KUHN satellite wrappers, the well-known "scissor-type" cutters hold and cut the film. Due to its design, the film is caught across the full width. The film is held with a clamp, gathered into one solid rope and then cut before the bale is unloaded. The clamp firmly holds the film ready for the next bale.



## ROUND TURNTABLE

The KUHN round bale turntable wrappers are equipped with two rollers and four wide-spaced belts. This design provides a deep and stable cradle for the bale on the wrapping turntable. The two large bale support rollers provide more stability and guidance. The four wide-spaced belts provide maximum traction and even rotation for the bale. Even bale rotation is vital to ensure the optimal film overlap for conservation and crop quality during storage.

## SQUARE TURNTABLE

The KUHN large square bale turntable wrappers are equipped with two pairs of steel rollers with a ribbed profile. This profile ensures maximum bale traction, even bale rotation and proper film overlap. Two large bale support rollers provide additional stability and guidance. Round bales can also be wrapped with these wrappers.



## CONTROL SYSTEMS

Two different control systems are available dependent on model, and driver preferences:

**- The manual version (M)** is controlled with cable levers, and comes standard with the bale-and-wrap counter and autostop. The bale-and-wrap counter counts the film layers and total number of wrapped bales. The autostop function will automatically stop the wrapping table/satellite once the total number of film layers have been applied. This transforms a manually controlled wrapper into a semi-automatically controlled wrapper.

**- The computer-controlled version (C)** uses a control box that provides all the information and features for a fully automatic wrapping process. The integrated joystick automatically steers bale discharge, among other direct functions. A remote control system is available too for certain wrappers. (see specifications page)

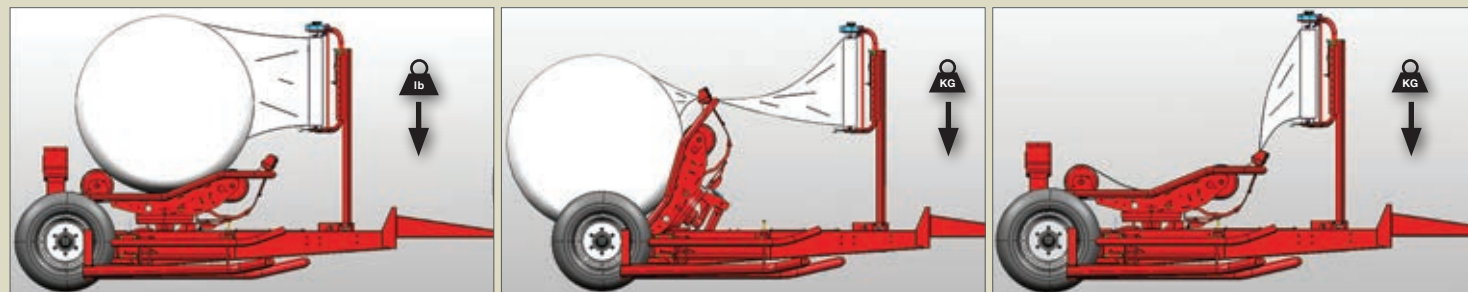

## LOW-PROFILE CHASSIS DESIGN

The KUHN trailed turntable wrappers have a unique low-profile design ideal for stability when loading, wrapping or unloading a bale. The rear axle position results in a low table height eliminating the need for an active fall damper. There is constant weight transfer to the tractor, that prevents up-and-down movements of the drawbar and prevents tractor wheel slippage when driving uphill with a bale on the table or loading arm. The bale can be dropped on the go for maximum output!

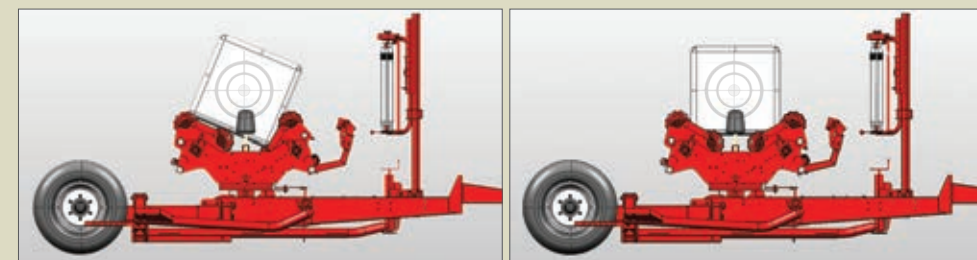
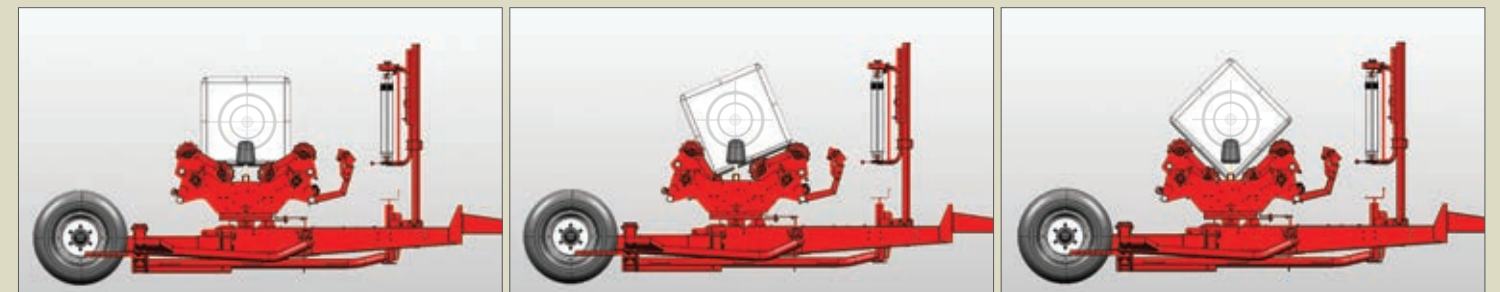

## SQUARE TURNTABLE MODELS

The two pairs of adjustable rollers ensures even bale rotation and optimal wrapping whatever the bale size.



**PRE-STRETCHERS**

The standard pre-stretchers which hold a 30" (750 mm) roll, are made of aluminum to avoid build-up of tack from the film. Both outer ends of the aluminium rollers are cone-shaped to maintain the optimum width of the film and reduce the risk of film tear. The special ribbed profile of the aluminum rollers keeps air and water away from the film. The location of the pre-stretchers makes it very easy to change the film rolls. The standard pre-stretch of 70% is reached by a low-maintenance and low noise gear transmission.



# e-Twin TECHNOLOGY



Besides a standard single stretch, KUHN introduces the all-new RW 10 series with patented\* e-Twin system for excellent, cost efficient, fast wrapping. The innovative e-Twin technology enables wrapping via an unique combined pre-stretcher design with patented film distribution to save 50% on wrapping time and further film savings. The conical pre-stretch rollers have been positioned in such a way that the two 30" (750 mm) film wraps with 2/3 overlap are glued together providing a double layer before they leave the pre-stretcher unit. Optional on some of the wrappers is the auto filmlayer correct kit. The correct kit detects an empty or torn film roll and adjusts the required amount of table rotations to cover the bale with the required amount of layers.

**UNIQUE ADVANTAGES OF e-Twin:**

- Save 50% wrapping time
- Further film saving achieved by increased pre stretch ratio
- Tighter wrapped bales increases the airtightness and so quality of feed
- Extreme tear resistance under all circumstances
- Available on manual and computer version with joystick

RW-10 series e-Twin, the next step in top quality, cost efficient, ecologic and ergonomic bale wrapping.



**CURIOS HOW KUHN e-Twin TECHNOLOGY MAKES YOUR WRAPPING BUSINESS MORE PRODUCTIVE AND COST EFFICIENT?**

Calculate your yearly savings by using our e-Twin calculator found at [www.KuhnNorthAmerica.com](http://www.KuhnNorthAmerica.com) > Services & Support > Tools and Mobile Applications > e-Twin Calculator

\*patent or patent pending in one or more countries



Bale Information		Wrapping Information	
Bale diameter (mm)	150	Number of bales	5
Bale width (mm)	420	Film per roll (%)	1000
Bales per year	2000	Price per film roll	75
		Single wrap (prestretch (%))	70
		Prestretch (prestretch (%))	60
		Tractor size	25
		Labour cost	50

e-Twin calculator

# 3-POINT MOUNTED, ROUND BALE WRAPPER

The RW 1110 is ideal for "wrap and stack" operations in the field or in the yard. Wrapping at the storage place means a minimum risk of film damage. A well-suited combination for a one-man wrapping operation.

The RW 1110 is capable of wrapping heavy bales up to 2,645 pounds (1,200 kg) due to its reinforced large main frame, standard for all static wrappers. The low mounted four-belt turntable ensures a gentle bale discharge so there is no need for an active fall damper. The low mounted height also allows easy replacement of the film rolls. For a firm cut and hold of the film, even in wet conditions, the wrapper is provided with a spring-loaded high grip film cutter. For even more convenience, the RW 1110 is quick hitch compatible.

Optional on the RW 1110 are extra wide support legs for increased stability during free-standing operation. Furthermore an optional four-roll film magazine is available.



**TWO MODELS AVAILABLE: MANUAL CONTROL (M VERSION) OR COMPUTER CONTROL WITH STANDARD RF REMOTE CONTROL (C VERSION)**

The RW 1110 M version is controlled with two cable levers and comes standard with a bale and wrap counter and autostop. The bale- and wrap counter helps the operator by counting film layers and total number of wrapped bales. The autostop function will automatically stop the wrapping table after the total number of film layers are applied. This turns a manually controlled wrapper into a semi-automatically controlled wrapper.

The RW 1110 C version is equipped with a computer system. This easy-to-use, automatically controlled computer system, with integrated joystick, uses an operator friendly user interface in line with the AT-10 controlled balers. The wrapper can be operated from a loader with the standard RF remote control with "high distance shutdown", while using a power pack or second tractor for the oil and power supply.

The trailer kit option, available for KUHN RW 1110 wrappers, provides simplicity and faster transport for stationary wrappers. This kit allows the machine to be used as a self-contained wrapping unit or attached to a tractor, providing flexibility to match your unique needs. The standard engine platform makes it easy to add an optional KUHN power pack (HPU 114) for a completely self-contained machine.

**e-Twin TECHNOLOGY**

The RW 1110 can be equipped with the innovative patented e-Twin pre-stretcher. With e-Twin technology, the wrapping time is reduced with 50% compared to a single pre-stretch wrapper and therefore no downtime in the wrap and stack process.





# TRAILED, SELF-LOADING ROUND BALE WRAPPER

The mid-range RW 1410 is the most versatile self-loading round bale wrapper. The manual version (M) is controlled with three cable levers and comes standard with a bale and wrap counter and autostop. The computer controlled version (C) uses a monitor with an integrated joystick that provides all the information and possibilities for automatic operation of the entire wrapping process. Automatic stop at the end of film/film tear comes standard.



The right-hand wheel can be folded inward for road transport. Left-hand side optional.



The RW 1410 will lift bales up to 5' (150 cm) in diameter and 2,200 pounds (1,000 kg), due to its unique low-profile chassis design with wide-track wheels. The new design of the RW 1410 has a wrapping table with four belts, stronger frame and high grip film cutter for optimal results.

Options available for the RW 1410 model are a bale turner, allowing the bale to be discharged on to its flat end, RF remote control and a filmroll holder for four rolls. The RW 1410 can also be equipped with the innovative patented e-Twin pre-stretcher.



Limited transport width due to adjustable wheel positions.

# TRAILED SELF-LOADING ROUND BALE WRAPPER

The professional RW 1610 round bale wrapper is ideal for those wrapping operations where high capacity and high efficiency are required. Due to its strong design with low table height and standard large wheels located at the rear, there is no need for an active fall damper. This saves extra process steps and the bale can be unloaded on the go. The RW 1610 is equipped as standard with a high grip film cutter and filmroll holder for two rolls.

The RW 1610 can be operated via the three levers cable control **(M)** or computer control box **(C)**.

The RW 1610 is capable of loading the heaviest bales (up to 2,645 lbs (1,200 kg) thanks to a rugged designed main frame, adjustable loading arm and 4 belt wrapping table. Constant weight transfer towards the tractor avoids slippage in hilly circumstances. In addition, the KUHN RW 1610 can load and carry a second bale in the loading arm during wrapping. The C model, with integrated AutoLoad function has increased overall loading, wrapping capacity and efficiency. The patented\* AutoLoad function enables the operator to fully concentrate on the driving process, while the wrapping process is automatically started once the bale has been detected on the loading arm. Picking up a second bale with the loading arm, during the wrapping process for transport, is fully automated.

The bale turner, RF remote control, and filmroll holder for four additional rolls are optional on the RW 1610. Similar to the RW 1410, the RW 1610 can be equipped with the innovative patented e-Twin pre-stretcher.



\*patent or patent pending in one or more countries



# 3-POINT MOUNTED LARGE SQUARE AND ROUND BALE WRAPPER

The SW 1114 is a 3-point mounted, quick hitch compatible bale wrapper that can wrap large square bales and round bales up to 2,645 lbs (1,200 kg). The large, strong main frame has two pairs of steel rollers that provide a deep cradle for the bale and even rotation to ensure proper film overlap. The bale can be gently discharged because of the low mounted turntable.



In addition, the SW 1114 can be equipped with extra wide support legs for increased stability during free-standing operation. One of the other options is a film roll magazine for four film rolls.

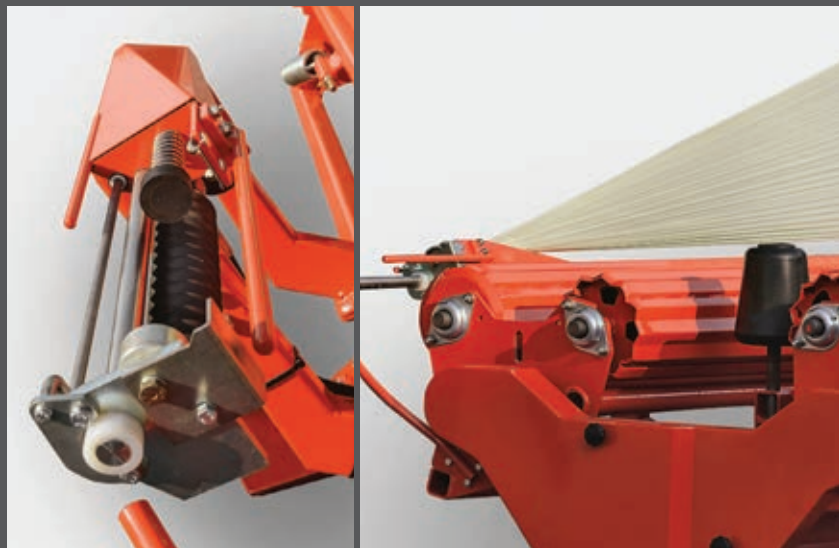

A hydraulic, high-grip film cutter allows you to adjust the cutting moment independent of the table tipping position, resulting in the shortest possible end-string. It has a long stroke to help accommodate various bale lengths and ensures a firm hold and a clean cut of the film in various weather conditions.



## 3-POINT MOUNTED LARGE SQUARE AND ROUND BALE WRAPPER

The SW 1114 Manual version (**M**) is controlled in the tractor cab with two cable levers. These levers can also be mounted onto the wrapper near the pre-stretcher. The manual version comes standard with a bale and wrap counter and autostop. This turns a manually controlled wrapper into a semi-automatically controlled wrapper.

The SW 1114 Computer version (**C**) with standard RF remote control can be operated from a loader while using a power pack or second tractor for the oil- and power supply. This creates a one-man operation for loading, wrapping and stacking. Wrapping at the storage site means a minimum risk of film damage. The C version is standard fitted with automatic stop at the end of film/film tear, integrated bale and wrap counter, play/pause function and 90° loading position.



With standard RF remote control with "high distance shutdown", the wrapper can be operated from the loader while using a KUH N power pack (HPU 114) or second tractor for the oil and power supply towards the wrapper.

The low table height allows the bale to be gently tipped off to prevent film damage.







SW 1614

## TRAILED SELF-LOADING ROUND AND LARGE SQUARE BALE WRAPPER

The SW 1614 is a hybrid bale wrapper that can wrap large square bales 2x3 or 3x3 (80x60-90 cm) up to 6' (180 cm) in length, and round bales up to 5' (150 cm) in diameter. The two pairs of adjustable steel rollers provide a deep cradle for the bale and even rotation to ensure proper film overlap. The hydraulic high grip film cutter has a long stroke to help accommodate various bale lengths. It also ensures a firm hold and a clean cut of the film in various weather conditions. The automatic parallel loading arm, with standard round bale kit, ensures gentle, on-the-move bale loading in all weather conditions. Due to its unique low-profile chassis design with wide track wheels a second bale can be carried during wrapping to increase overall efficiency.



The SW 1614 can be equipped with two different control systems. The manual version (M) is controlled with cable levers and equipped as standard with bale-and-wrap counter and autostop. This turns a manually controlled wrapper into a semi-automatically controlled wrapper.

The enhanced SW 1614 Computer controlled version (C) with integrated patented AutoLoad function has increased overall efficiency and loading and wrapping capacity. The automatically controlled computer system with integrated joystick is standard equipped with automatic stop at the end of film/film tear, and play/pause function. The RF remote control with high distance safety control is optional.

Available options are a film roll magazine for four rolls of stretch film, hydraulic wheel turning kit and an additional counter weight in order to lift up to 2,200 pound (1,000 kg) round bales.



Integrated AutoLoad function SW 1614 C

The low table height allows the bale to be gently tipped off to prevent film damage.

For road transport the wheels can be folded inward to reduce the transport width. Hydraulic folding is optional.

SW 4014

# TRUE WRAPPING INTELLIGENCE

KUHN introduces a true innovation in bale wrapping with the SW 4014. This versatile self-loading square- and round bale wrapper features a unique patented\* AutoLoad function for nonstop fully automatic wrapping.



### NON-STOP WRAPPING WITH AUTOLOAD\*

The innovative AutoLoad function provides non-stop, fully automatic loading, wrapping and unloading of square- and round bales without interference from the driver. AutoLoad detects approaching bales, automatically scans the length of the bale and sets the loading arms into pre-load position, resulting in accurate loading, wrapping and unloading of the bale on the go. This leads to increased overall capacity and creates a more ergonomic and stress-free working environment during a long working day.

### HOW DOES IT WORK?

AutoLoad function is based on Category II Laser technology. First the laser sensor, situated inside the top cover at the front side of the machine, is scanning the area ahead of the bale wrapper. In addition, a wheel sensor is placed on the left wheel which measures the speed and distance toward the bale.

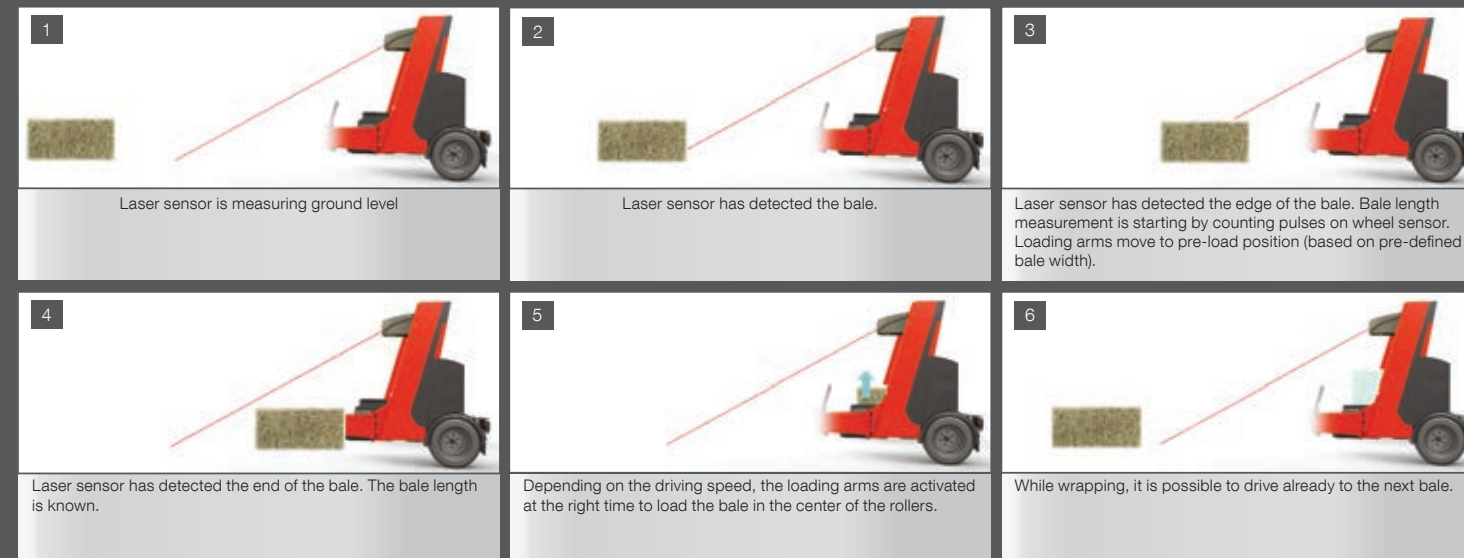

In case bales are dropped in ditches, under fences or even in corners of the field, the SW 4014 AutoLoad still allows you to load bales manually, forwards and backwards.

\* AutoLoad parameters: 1) Square bale length must be between 29 1/2 and 79 inches. 2) Driving speed must be constant and between 0.25 and max. 2.5 mph during scanning and loading.



Alongside the innovative AutoLoad function, more additional features are provided which makes this versatile self-loading wrapper like no other bale wrapper in the market.

**OUTSTANDING STABILITY**

Thanks to its solid design, with incorporated hydraulic sliding frame, an extreme wide track is achieved for outstanding stability of the machine. This unique "drive through" operation enables easy loading of the bale and excellent visibility of the wrapping process. The SW 4014 has an operational width of 13' (4 m) in the field and only 8' (2.5 m) during transport.



The wrapper folds from its 8' (2.5 m) transport position into 13' (4 m) wide field position.

To prevent film damage during transport, the SW 4014 is fitted with large wheel covers. 19,0/45x17 wide wheels are optional.



**OPTIMAL VERSATILITY**

The SW 4014 is capable of wrapping large square and round bales up to 3,307 pounds (1,500 kg). Wrapping of round bales is possible without any additional equipment or mechanical adjustments. All predefined bale dimensions can easily be selected via the monitor.

**EXCEPTIONAL BALE HANDLING**

The smart design of the SW 4014 guarantees easy (un)loading of the bales, front- and backwards, even when dropped in hard-to-reach locations. All bales are being (un)loaded without the risk of damaging or soil contamination because of the two patented\* pair of steel rollers.

\*Patent or patent pending in one or more countries

**EXCELLENT WRAPPING**

The positioning of the patented\* shorter top rollers allow the film roll holders to be positioned as low as possible. As a result, the film is wrapped closer to the center of the bale with less wrinkling, ensuring an optimum oxygen barrier for excellent silage quality.



Greater management and control of the wrapping process can be achieved by our unique IntelliWrap™. IntelliWrap uses sophisticated electronics and hydraulics to monitor the wrapping process and continuously controls the film overlap, allowing total flexibility. Depending on local circumstances, crop conditions and storage periods the amount of film layers (4, 5, 6, 7, 8, 9...) can simply be adjusted. An excellent distribution of the film around the bale and precise overlap of the film provides maximum efficiency and increased silage quality.

\* Patent or patent pending in one or more countries

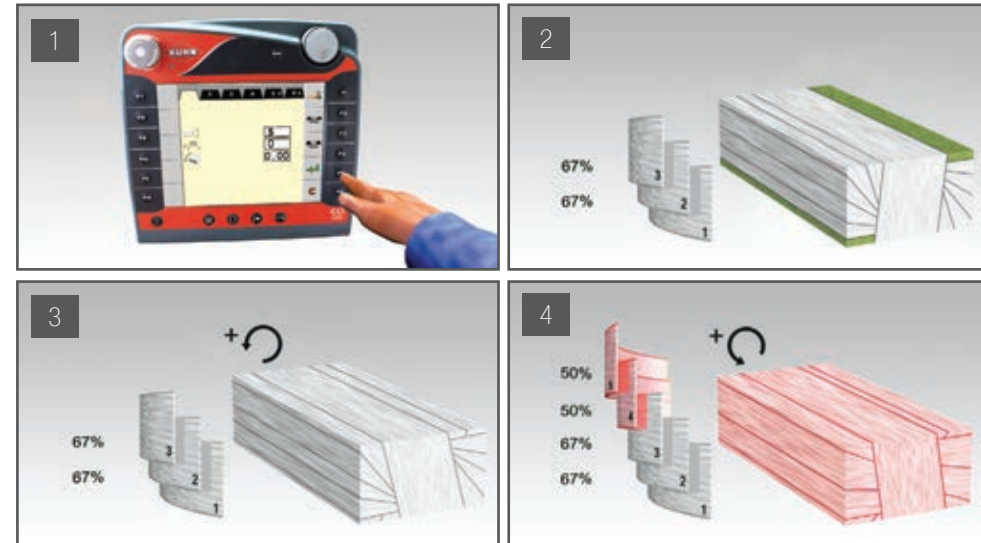

1. Selection of five film layers
2. The bale is covered with three layers and 67% overlap
3. Increasing of the bale rotational speed
4. Final two layers with 50% overlap

**FUEL SAVINGS**

The SW 4014 can be operated with a broad range of tractors because of a limited oil flow requirement (11 gallons/min. (40 liters/min.) maximum of 16 gallons/min. (60 liters/min.). As an option, the wrapper can be equipped with a PTO driven oil supply for optimal wrapping capacity. The tractor can run at lower engine rpm for significant fuel savings. Further fuel savings can be achieved by running on 540E / 750 rpm PTO speed. In addition, the PTO driven oil supply is a closed system and there is no risk of oil contamination from different tractors and less chance of dirt in the system.



**MAINTENANCE AND ACCESSIBILITY**

The large side doors of the SW 4014 provide excellent accessibility for maintenance. Furthermore you can open the top cover and side doors without the need of tools. The SW 4014 can be equipped with an optional LED work light to have a better view on the wrapping process in the dark.





# ALWAYS IN CONTROL

The SW 4014 is ISOBUS compatible. ISOBUS compatible tractors will therefore not require a separate control box for the wrapper. Alternatively, the VT 50 or CCI 200 monitor can be used with tractors that are not ISOBUS compatible. Operator settings, such as selecting pre-defined bale dimensions and switching from transport into field mode, are accessed via the monitor. Information, such as wrapping process overview and number of bales, is also provided.

## CCI 200

The ISOBUS compatible CCI 200 monitor has a large 8.5" (21.6 cm) color screen with outstanding clarity. Wrapping adjustments can be made via the touch screen or by use of the intuitive, large, soft touch keys. The CCI 200 monitor can also be used with other ISOBUS compatible machines on the market.



## VT 50

The KUHN ISOBUS VT 50 monitor has a 5.7" (14.5 cm) color screen with outstanding clarity. Adjustments can be done easily by the touch screen and the large soft-touch keys on the sides. The VT 50 monitor can be used specifically with the KUHN ISOBUS machines only.

## WORKING CONVENIENCE

To provide optimal working convenience, the SW 4014 has a smart feature that enables you to choose (automatic) unloading of bales in a selected position. You can choose to unload the bale with the knots on top for easier loosening of the twine and also quicker access to your feed after unwrapping the bale. Or if required, you can unload on the short side for easy transport.



## Model Specifications

	RW 1110 M	RW 1110 E-TWIN M	RW 1110 C	RW 1110 E-TWIN C
<b>DIMENSIONS</b>				
Bale Size – Width x Diameter	4' (1.2 m) x 3'-5' (.9 m – 1.5 m)			
Maximum Bale Weight	2,645 lbs. (1,200 kg)			
Loading System	External			
Wrapping Table	4 Belts + 2 Rollers			
Bale Support Roller	2 Adjustable Rollers			
Control	<b>(M)</b> Manual 3-Lever Cable Controlled		<b>(C)</b> Computer Controlled w/ Joystick	
Automatic Stop by End of Film/Tear	–		Standard	
RF Remote Control (Rechargeable)	–		Standard	
Fully Automatic Film Cutter	NEW: Sure Grip as Standard			
Film Pre-Stretcher	Standard 30" Optional Kit for 20"	1 Pre-Stretcher With two 30" Dispensers	Standard 30" Optional Kit for 20"	1 Pre-Stretcher With two 30" Dispensers
Pre-Stretch Ratio	Approx. 70% Standard Optional 60%	90% Std (Factory Set) – 70% Possible With Included Gear Set – Opt 60%	Approx. 70% Standard Optional 60%	90% Standard (Factory Set) – 70% Possible With Included Gear Set – Optional 60%
Required Tractor Hydraulic Connections	1 SA with Free Return or 1 DA			
Output and Pressure Required	7 GPM at 2,200 PSI			
Transport Width	7'10" (2.4 m)			
Machine Approximate Net Weight	1,985 lbs. (900 kg)			



### Model Specifications

	RW 1410 M	RW 1410 E-TWIN M	RW 1410 C	RW 1410 E-TWIN C
<b>DIMENSIONS</b>				
Bale Size – Width x Diameter	4' (1.2 m) x 3'-5' (.9 m – 1.5 m)			
Maximum Bale Weight	2,200 lbs. (998 kg)			
Loading System	Loading Arm			
Wrapping Table	4 Belts + 2 Rollers			
Bale Support Roller	2 Adjustable Rollers			
Control	<b>(M)</b> Manual 3-Lever Cable Controlled		<b>(C)</b> Computer Controlled w/ Joystick	
Semi-Auto Operation of <b>(M)</b> Version by Bale and Wrap Counter and Automatic Table Stop	Standard		–	
Automatic Stop by End of Film/Tear	–	Standard	Standard When Rolls Empty	
RF Remote Control (Rechargeable)	–	Optional		
Fully Automatic Film Cutter	Standard			
Film Pre-Stretcher	Standard 30" (76 cm) Option Kit 20" (51 cm)	1 Pre-Stretcher with two 30" (76 cm) Dispensers	Standard 30" (76 cm) Option Kit 20" (51 cm)	1 Pre-Stretcher With two 30" (76 cm) Dispensers
Pre-Stretch Ratio	Approx. 70% Standard Optional 60%	90% Std (Factory Set) – 70% Possible With Included Gear Set – Opt 60%	Approx. 70% Standard Optional 60%	90% Standard (Factory Set) – 70% Possible With Included Gear Set – Optional 60%
Required Tractor Hydraulic Connections	1 SA with Free Return or 1 DA			
Output and Pressure Required	7 GPM at 2,200 PSI			
Road Lights	Optional			
Tires	10.0/80-12			
Ability to Turn Wheels Inside for Road Trans	Right-Side Swivels, Left-Side Fixed			
Transport Width	8'11" (2.7 m)			
Machine Approximate Net Weight	2,200 lbs. (998 kg)			

### Model Specifications

	RW 1610 M	RW 1610 E-TWIN M	RW 1610 C	RW 1610 E-TWIN C
<b>DIMENSIONS</b>				
Bale Size – Width x Diameter	4' (1.2 m) x 3'-5' (.9 m – 1.5 m)			
Maximum Bale Weight	2,200 lbs. (998 kg) – Optional 2,650 lbs. (295 kg)			
Loading System	Loading Arm		Standard AutoLoad	
Ability to Carry Second Bale on Loading Arm	Standard			
Wrapping Table	4 Belts + 2 Rollers			
Bale Support Roller	2 Adjustable Rollers			
Control	<b>(M)</b> Manual 3-Lever Controlled		<b>(C)</b> Computer Controlled w/ Joystick	
Semi-Auto Operation of <b>(M)</b> Version by Bale and Wrap Counter and Automatic Table Stop	Standard		–	
Automatic Stop by End of Film/Tear	–	Standard	Standard When Rolls Empty	
RF Remote Control (Rechargeable)	–	Optional		
Fully Automatic Film Cutter	Standard			
Film Pre-Stretcher	Standard 30" (76 cm) Option Kit 20" (51 cm)	1 Pre-Stretcher With two 30" (76 cm) Dispensers	Standard 30" (76 cm) Option Kit 20" (51 cm)	1 Pre-Stretcher With two 30" (76 cm) Dispensers
Pre-Stretch Ratio	Approx. 70% Standard Optional 60%	90% Standard (Factory Set) – 70% Possible With Included Gear Set – Optional 60%	Approx. 70% Standard Optional 60%	90% Standard (Factory Set) – 70% Possible With Included Gear Set – Optional 60%
Required Tractor Hydraulic Connections	1 SA With Free Return or 1 DA			
Output and Pressure Required	7 GPM at 2,200 PSI			
Road Lights	Standard			
Tires	Standard 15.0/55-17			
Transport Width	8'10" (2.7 m)			
Machine Approximate Net Weight	3,285 lbs. (1,490 kg)			

### Model Specifications

	SW 1114 M	SW 1114 C	SW 1614 M	SW 1614 C
<b>DIMENSIONS</b>				
Large Square Bale Size (W x H x L)	2 x 3, or 3 x 3 (.6 x .9 m or .9 x .9 m) Bales up to 6' (1.8 m) Long			
Round Bale Width	4'-5' x 3'-5' (1.2-1.5 m x .9-1.5 m)			
Maximum Bale Weight	2,650 lbs. (1,202 kg)	Standard: 1,770 lbs. (803 kg) Optional: 2,200 lbs. (998 kg)		
Loading System	Non Self-Loading		Parallel Loading Arm	Standard AutoLoad
Ability to Wrap Round Bales	Standard			
Wrapping Table	Adjustable Twin Roller Pair Configuration			
Bale Support Roller	2 Adjustable Rollers			
Control	<b>(M)</b> Manual 2 Lever	<b>(C)</b> Computer	<b>(M)</b> Manual 3 Lever/Cable	<b>(C)</b> Computer
Automatic Stop by End of Film/Tear	–	Standard	–	Standard
RF Remote Control (Rechargeable)	–	Standard	Standard	Optional
Fully-Automatic Film Cutter	Standard Hydraulic			
Pre-Stretcher	Standard 30" (76 cm) – Optional 20" (51 cm)			
Pre-Stretcher Ratio	Standard 70% – Optional 60%			
Required Tractor Hydraulic Connection	1 SA with Free Return		1 SA with Free Return or 1 DA	
Output and Pressure Required	7 GPM at 2,220 PSI			
Approximate Machine Net Weight	2,250 lbs. (1,021 kg)		3,375 lbs. (1,531 kg)	
Transport Width	9'5" (2.9 m)			
Road Lights and Signaling	Optional With Trailer Kit			

### Model Specifications

	SW 4014
<b>DIMENSIONS</b>	
Large Square Bale Size (W x H x L)	2 x 3, 3 x 3, 3 x 4 or 4 x 4 (.6 x .9 m, .9 x .9 m .9 x 1.2 m or 1.2 x 1.2 m) Bales up to 6'6" (2 m) Long
Round Bale Width	4'-4'10" (1.2-1.5 m)
Maximum Bale Diameter	3'-4'7" (.9 m-1.4 m)
Maximum Bale Weight	3,300 lbs. (1,500 kg)
Attachment	Cat. 2 Swivel Headstock
Loading System	Twin Roller Arms
Bale Alignment Adjustment	Hydraulically Shift Wrapper for Proper Alignment with Bale
Ability to Wrap Round Bales	Standard
Wrapping Table	Electronic Controlled 2 x 2 Roller Pair
Electronic Monitor	VT 50 Touch Screen Color, CCI-100 Touch Screen ISOBUS Color or No Monitor
ISOBUS Wrapper Table With IntelliWrap®	Standard
Automatic Stop by End of Film/Tear	Optional
Satellite Arm	Twin Satellite Arm
Kit for 1/2 Table Speed for One Pre-Stretcher	Standard on Monitor (Activated Automatically if Equipped with Optional Film Break Sensor)
Pre-Stretcher	Standard 30" (76 cm)
Pre-Stretcher Ratio	Standard 60% – Optional 70%
Required Tractor Hydraulic Connection	1 SA with ¾" (1.9 cm) Free Return
Output and Pressure Required	Standard 11-16 GPM at 2,600 PSI
PTO Driven Hydraulics	Optional
Bale Auto-Leveling	Standard
Tires	Standard 15.0/55-17 – Optional 19.0/45-17
Approximate Machine Net Weight	6,220 lbs. (3,003 kg)
Overall Length Without PTO Driven Hydraulics	15'5" (4.7 m)
Overall Length with PTO Driven Hydraulics	17' (5.1 m)
Transport Width	8'2" (2.5 m)
Road Lights and Signaling	Standard



# COMPLEMENTARY PRODUCTS

## MORE PRODUCTS TO MEET YOUR NEEDS

With over 700 models of equipment, we have the most complete implement line in the industry. Whether you have a small or large operation, we have a broad range of models and options to help fit your diverse needs.



- 1. Mowers
- 2. Mower Conditioners
- 3. Tedders
- 4. Balers
- 5. TMR Mixers
- 6. Manure Spreaders

For more information about your nearest KUHN dealer and other KUHN products, visit our website at

[www.kuhn.com](http://www.kuhn.com)



Visit our YouTube channel to watch our latest product videos.



Your KUHN dealer

### KUHN NORTH AMERICA, INC.

Corporate Headquarters  
1501 West Seventh Avenue - Brodhead, WI 53520

Information given in this document is only for informational purposes and is non-contractual. Our machines are in compliance with North American safety standards. In our literature, and for improved illustration of certain details, some safety devices may not be in operating position. When operating these machines, these devices must be operated in accordance with the requirements indicated in the operator's manuals and assembly manuals. We reserve the right to change any designs, specifications or materials listed without further notice. Machines and equipment in this document can be covered by at least one patent and/or registered design. Trademarks cited in this document may be registered in one or several countries.

Find us on   