

Automatic

Grain Mills

ATG6020

Features

- Flip-open hopper
- Heavy-duty PTO with shear bolt
- High carbon steel rolls
- Fatigue proof shafts
- Maximum capacity, versatility, and transportability
- One roll turns faster to prevent plugging and increase capacity



Roll Configuration	Dry Corn	High Moisture Corn	Soybeans	Milo	Small Grains
4	6300 bsh/hr	5900 bsh/hr			
6.5	4050 bsh/hr	3600 bsh/hr	3420 bsh/hr	3525 bsh/hr	1760 bsh/hr
8	3510 bsh/hr	3120 bsh/hr	2760 bsh/hr	3165 bsh/hr	2370 bsh/hr
10	2970 bsh/hr	2640 bsh/hr	2340 bsh/hr	2820 bsh/hr	2115 bsh/hr

Specifications

Roll Size: 14"x 54"

Weight: 5500 lbs

With Swing Auger: 5995 lbs

Horsepower: 180

PTO RPM: 1000

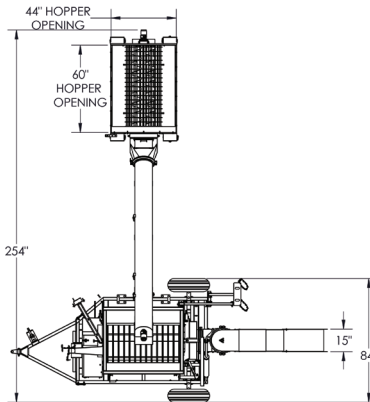

ATG6020 SWING UNDER INTAKE

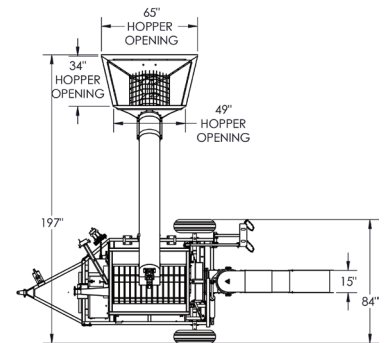

ATG6020 STANDARD INTAKE

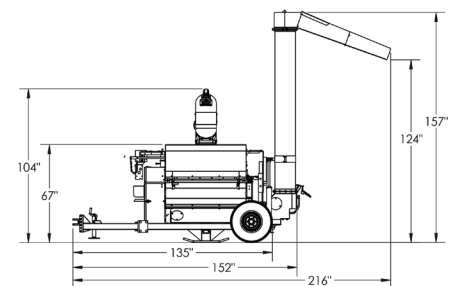
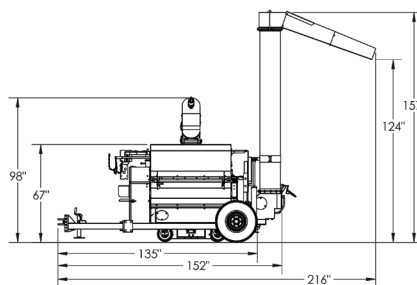

Email: info@automaticag.com
 800-336-4336 • automaticag.com