

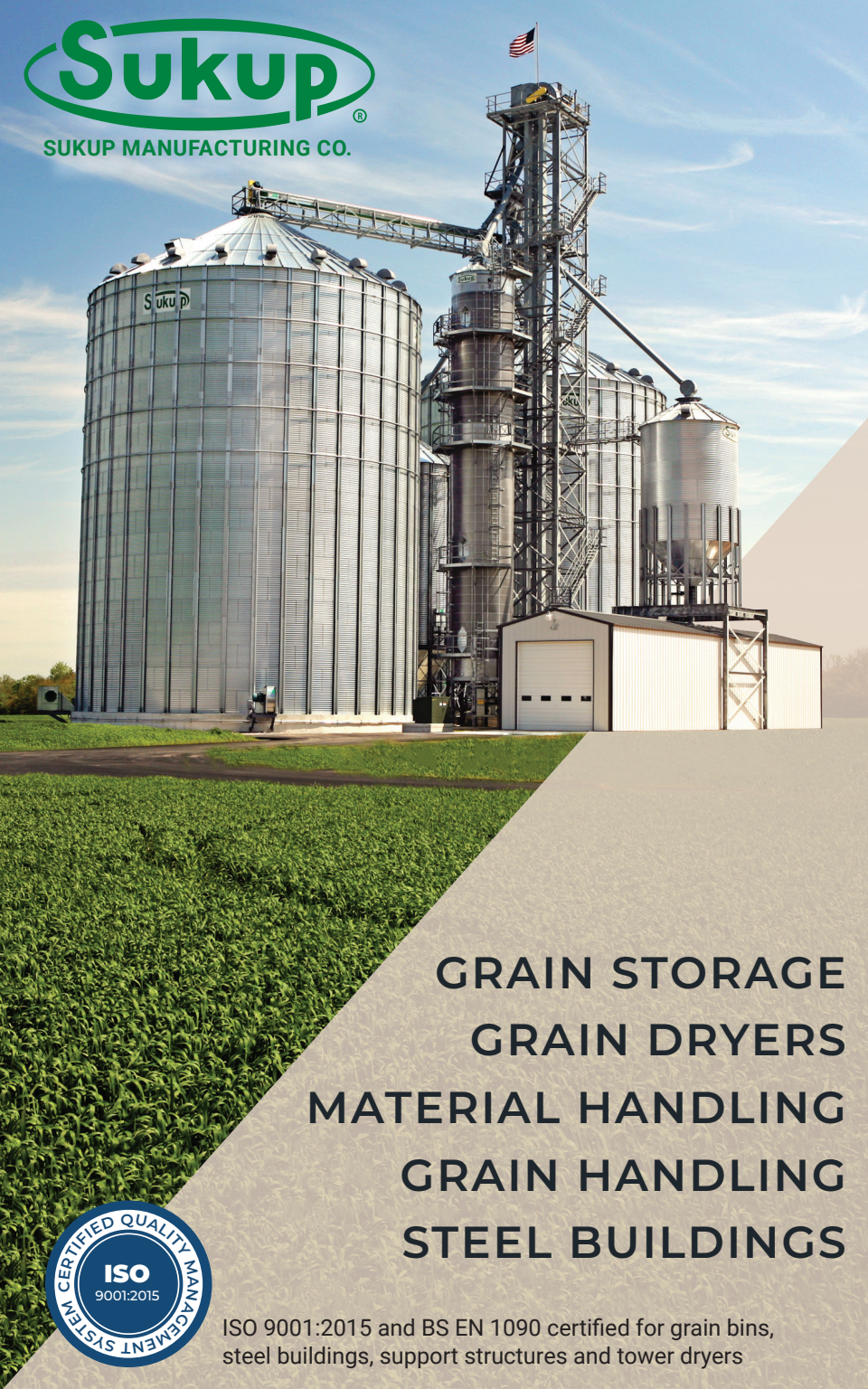

SUKUP MANUFACTURING CO.



**GRAIN STORAGE
GRAIN DRYERS
MATERIAL HANDLING
GRAIN HANDLING
STEEL BUILDINGS**



ISO 9001:2015 and BS EN 1090 certified for grain bins, steel buildings, support structures and tower dryers

GRAIN STORAGE



- G115 Roof & Restraint Anchor**
- SAE Grade 8.0 Hardware with 1000 Hour Plating**
- SuperShield® Coating**
- BS EN 1090 and ISO 9001:2015 certified**
- Superwave® Floor Supports**

A BIN TO FIT EVERY NEED

Sukup Grain Bins were the first with a 5,000 lb. peak load roof standard with a 40 psf snow load. They feature precision-engineered 4" wide corrugated high-strength 50,000 psi yield strength, 70,000 psi tensile strength galvanized steel sidewall sheets to provide better vertical load carrying capacity. Our advanced roll-forming equipment produces the best fitting bins in the industry.



FARM BINS
Stiffened and Non-Stiffened

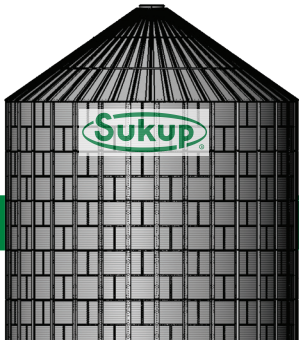

HOPPER BINS
Medium and Heavy Duty

COMMERCIAL BINS
Up to 2.25 Million Bushels



STEEL BUILDINGS

IAS AC472 & ISO 9001:2015 Certified

STRENGTH
Steel buildings generally withstand higher winds and loads than wood.

CLEAR SPAN
Steel buildings can clear span greater distances than wood.

DURABILITY
Steel buildings outlast wood buildings and are completely recyclable.

INSIDE CLEARANCE
Rigid frame rafter design provides a greater inside clearance.

ELEMENTAL RESISTANCE
Safe from termites, rotting, mold, drying out, shrinking, or warping.

COLORS
Choose from twelve exterior and trim coated colors.

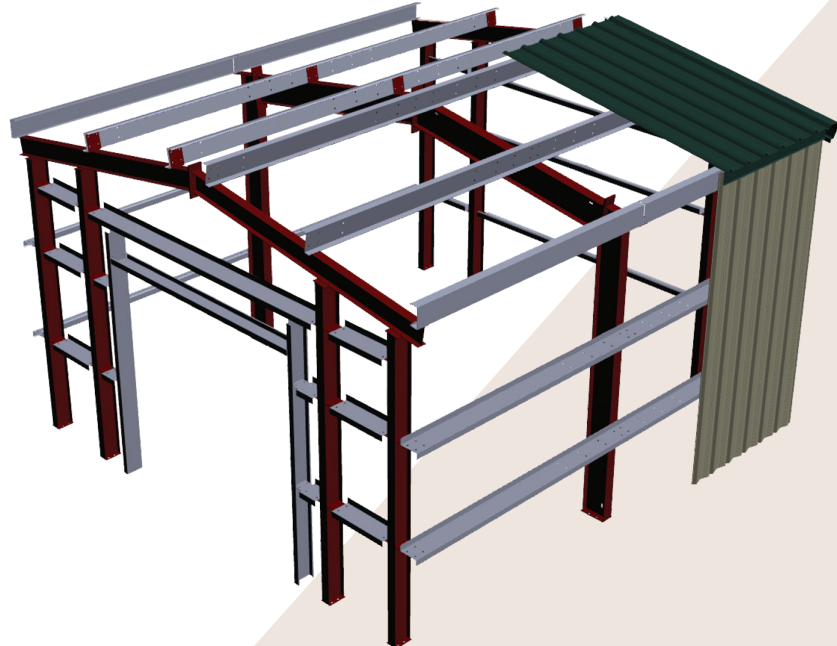

DESIGNED FOR YOU. BUILT TO LAST.

The clear span design of a Sukup Steel Building allows you to customize your building to fit your specific requirements. Whether you need an agricultural building to house livestock, materials, or large machinery, or you are looking for an industrial or commercial structure, you can have it with a Sukup Steel Building.

Sukup's rigid frame structure creates open space to fold out your planter and check the row units, space for storage or machinery, and much more. Sukup buildings are also the most customizable on the market.

GRAIN DRYERS

THE BEST DRYER FOR YOU

Sukup has a variety of dryers to help you dry grain more efficiently. Choose from Mixed-Flow, Cross-Flow, or Tower Dryers. Each dryer comes standard with the award-winning QuadraTouch Pro™ control system and optional remote access.

QUADRATOUCH PRO™

- Standard on all Sukup dryers
- Identifies fault or problem prompting on screen aid
- Ethernet interface for easy plug and play drying

REMOTE ACCESS

GSM & MySukup

- Provides monitoring and limited control of QuadraTouch Pro™ dryers
- "Multi-site functionality - manage multiple dryers from one single account"

TOWER DRYERS

- Vacuum cooling
- Small footprint area
- Grain exchangers
- Stainless steel parts

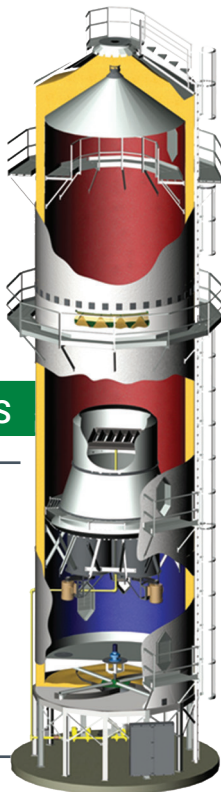

CROSS-FLOW DRYERS

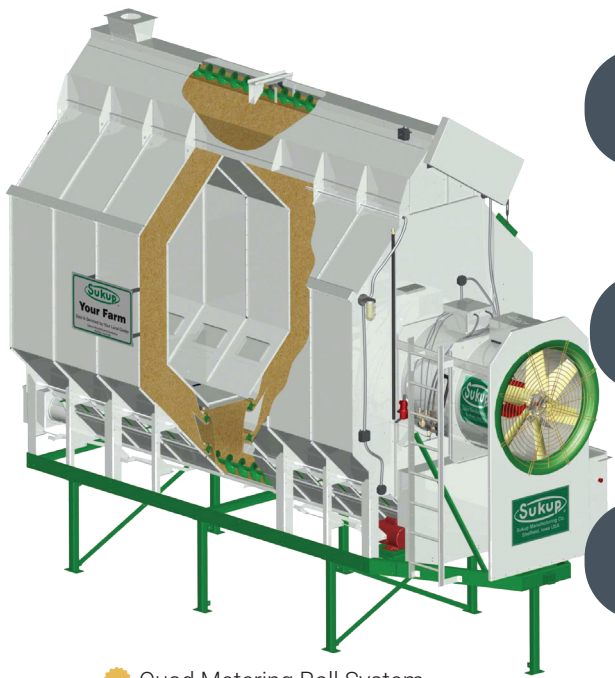

SINGLE FAN

- Full heat drying
- Batch mode

TWO-FAN

- Staged dryer temps
- Plenum split units

CENTRIFUGAL

- Heat/Vacuum cool
- Full heat mode

Quad Metering Roll System
Patent No. 5,992,044

MIXED-FLOW DRYERS

Patent No. 10,378,820

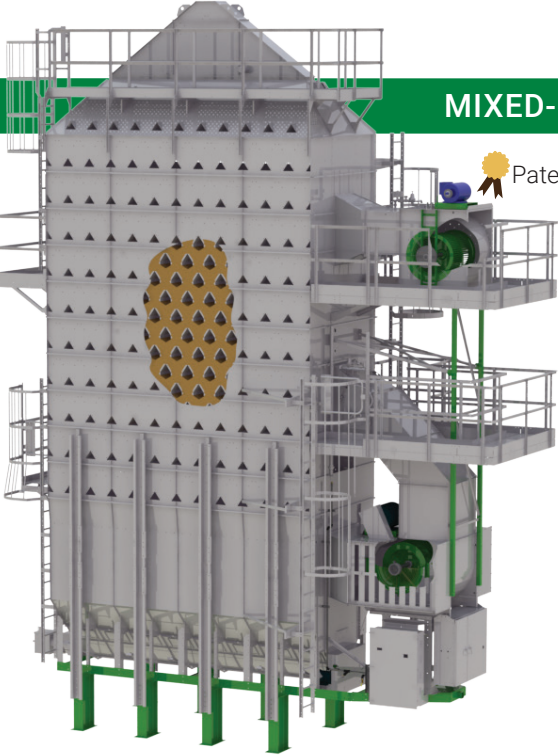

- Minimal seasonal cleaning
- Long grain retention time
- Vacuum cooling
- Single conveyor unload
- Adjustable exiting grain temp

STACKED AXIAL

- Full heat
- Heat/Pressure cool

STACKED CENTRIFUGAL

- Heat/Vacuum cool
- Quieter than axial

STACKED HYBRID

- Lower horsepower
- Vacuum cooling

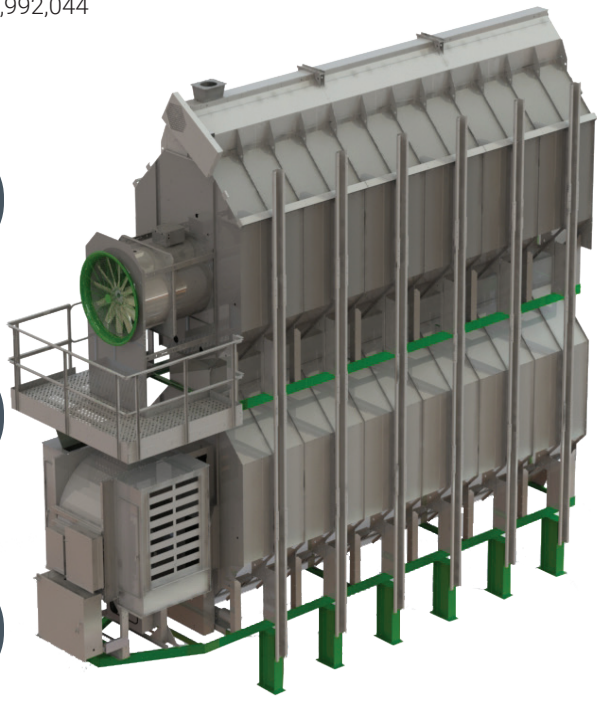

MATERIAL & GRAIN HANDLING

MOVING GRAIN FROM FIELD TO MARKET

Sukup's first product in 1963 was a stirring machine designed to speed up the process of drying grain and preventing spoilage. Since then, Sukup has developed advanced material and grain handling products designed to manage your grain. Our product lines include:

GRAIN HANDLING: axial fans and heaters, centrifugal fans and heaters, stirring machines, unloading equipment, bin floors and supports, grain spreaders, and Airway® Tubes.

MATERIAL HANDLING: bucket elevators, conveyors, sub-structures, and commercial zero-entry sweeps.



CONVEYORS

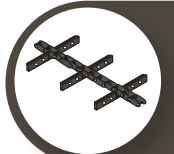

DRAG

- Gentle on grain
- Galvanized construction and replaceable liners for long life
- Dodge drive and bearings

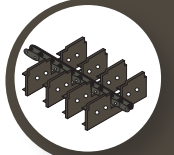

HY-FLIGHT

- Replaceable AR (abrasion resistant) bottom and side liner extends life
- Bearing, sprocket, & shaft can be removed as one assembly
- Adjustable bypass hopper

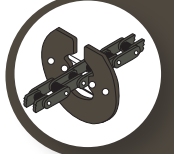

DOUBLE RUN

- Extremely gentle on grain
- Longer life span than augers
- Compact design and smooth quiet operation
- Head drive or tail drive available

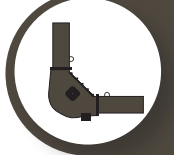

CHAIN LOOP

- Blend grain easily in all-in-one system
- Handles wet and dry grain
- Can be designed for future expansion
- Less horsepower and maintenance than pneumatic systems

FANS & HEATERS

Axial

- Maximum airflow at lower static pressures
- Exclusive built-in venturi increases airflow
- Heaters ignite quickly and burn efficiently

Centrifugal

- Higher static pressures
- High, low, and super low temp heaters
- Huck bolt fan design for added strength

SUPPORT TOWERS

- Eliminate need for guy wires
- Provides support for elevator legs
- Hot dipped galvanized finish

CATWALKS

- Welded tubular side construction
- Hot dipped galvanized finish
- Four different series: SD, HD, XHD, XTD

SUB-STRUCTURES

- Hopper bin support structures used for truck load outs
- Provides 15' of vertical clearance
- Hot dipped galvanized steel construction

BUCKET ELEVATORS

- Low impact head design reduces damage to grain
- Large head service platform
- Flexible liner options to meet specific needs
- Patented squaring plates & alignment pins for ease and accuracy in construction
- Welded head and boot frames for solid strength

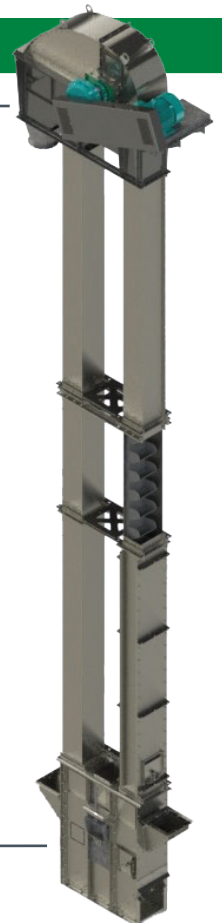

 Squaring Plates
Patent No. 8,668,079

BIN UNLOADING EQUIPMENT

PADDLE SWEEPWAY

 Patent Pending

Open flow through head design utilizes center and intermediate sumps with bars to prevent sumps from plugging

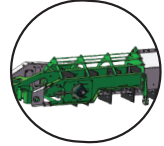

U-TROUGH POWER SWEEP

Sump on opposite side of gearbox allows for cleaner sweeping on backside of bin

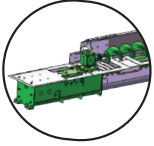

COMMERCIAL SWEEP Paddle

The zero-entry control system allows for automatic or manual operation saving you time and money

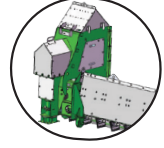

SWEEPWAY® POWER SWEEP

 Patent Pending

More safely advances into the grain and removes it without needing to enter the bin

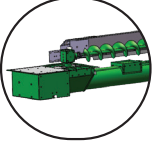

BIN FLOORS & SUPPORTS

Sukup floors will accommodate most drying or storage needs and are ideal for flush floor aeration applications.

- Floors**
- Super Hawk Cut™, Perforated, Heavy Duty Perforated

- Supports**
- Superwave, Super Supports, Flat Top Support, Z-post



Family-owned and operated company with three generations active in the business

More than 55 years manufacturing products that make agriculture more efficient, profitable, and safe



We stand behind our equipment
It's our family name on every product

Hold more than 80 patents and 26 AE50 Awards, proof that our products set the standard for **innovation**



Integrated technology makes our products smarter, with an eye towards the future of farming

Full-line manufacturer with a solution to meet the needs of your agriculture operation



Knowledgeable and experienced staff to answer your questions and provide world class customer service

Giving back is inGRAINED® at Sukup, both locally and worldwide with the Sukup Safe T Home®



SUKUP MANUFACTURING CO. | WWW.SUKUP.COM

Box 677 | 1555 255th St. | Sheffield, IA 50475 | 641.892.4222 | info@sukup.com

FOLLOW US ON



@SukupMFG

UNITED STATES DISTRIBUTION CENTERS

ARCOLA, IL

AURORA, NE

CAMERON, MO

DEFIANCE, OH

JONESBORO, AR

WATERTOWN, SD

INTERNATIONAL DISTRIBUTION CENTERS

DENMARK

L1117-022022CE

©2022 Sukup Manufacturing Co.