



## UML/EX UML/EX/VT

Mulcher with fixed teeth rotor for excavators having a weight between 14 and 20 t.

**Standard equipment:** 63 cc hydraulic piston motor with anticavitation valve, flow control system valve, hydraulic hood.  
110/45 cc variable torque hydraulic motor for the **UML/EX/VT**.

**Options:** custom made attachment plate with pins, diverter valve, rotor equipped with tooth type "C/HD" or "D".

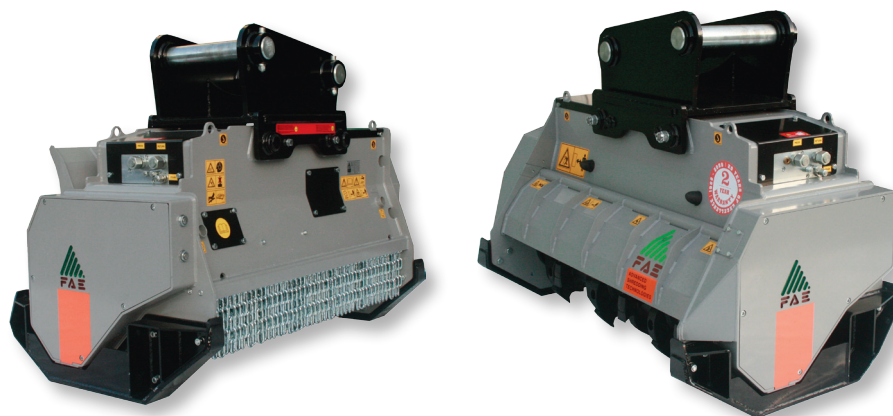

### UML/EX

Model	Power HP	Requirements		Excavator weight t.	Working width inches	Weight lbs	Grinding diameter inches (max)	Teeth q.ty/type C+C/SS
	Min - Max	Flow gal/min Min - Max	Pressure PSI Min - Max					
UML/EX 100	90 - 100	30 - 37	3000 - 5000	14 - 20	43	2160	8	20+2
UML/EX 125	90 - 100	30 - 37	3000 - 5000	14 - 20	53	2392	8	26+2
UML/EX 150	100 - 120	30 - 37	3000 - 5000	14 - 20	62	2612	8	32+2

### UML/EX/VT Hydraulic motor with variable torque

Model	Power HP	Requirements		Excavator weight t.	Working width inches	Weight lbs	Grinding diameter inches (max)	Teeth q.ty/type C+C/SS
	Min - Max	Flow gal/min Min - Max	Pressure PSI Min - Max					
UML/EX/VT 100	90 - 100	32 - 47	3200 - 5000	14 - 20	43	2310	8	20+2
UML/EX/VT 125	90 - 100	32 - 47	3200 - 5000	14 - 20	53	2513	8	26+2
UML/EX/VT 150	100 - 120	32 - 47	3200 - 5000	14 - 20	62	2734	8	32+2

Data refers to the machine without options.



Tooth type C (standard)

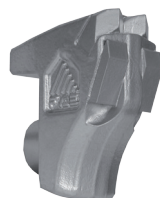

Tooth type C/HD (option)



Tooth type D COBRA (option)



Tooth type C/SS (side scraper)