



FML/SSL

Mulcher with swinging hammers rotor for skid steer loaders between 75 and 120 HP equipped with a high flow kit.

Standard equipment: 63 cc hydraulic piston motor with double relief valve with anticavitation and brake function, hydraulic hood, adjustable skids, working pressure control gauge, hydraulic hoses, pushing frame.

Options: diverter valve, oil cooler kit.



FML/SSL

Model	Power HP	Requirements		Working width Inches	Overall width Inches	Weight lbs	Grinding diameter Inches (max)	Hammers q.ty/type FMM
	Min - Max	Flow gal/min Min - Max	Pressure Bar Min - Max					
FML/SSL 125	75 - 110	33 - 40	200 - 350	53	66	2557	8	20
FML/SSL 150	75 - 110	33 - 40	200 - 350	62	74	2778	8	24
FML/SSL 175	85 - 120	33 - 40	230 - 350	72	83	2976	8	28

Data refers to the machine without options.

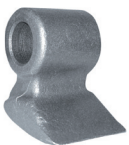

Hammer type FMM