



## FML/ST

Forestry mulcher with swinging hammers rotor for tractors between 50 and 110 HP.

**Standard equipment:** PTO driveshaft, gearbox with freewheel, hydraulic rear hood.

**Options:** hydraulic top link, push frame.

**Notes:** For the correct usage, creeper gear transmission and reversible driving console are recommended.

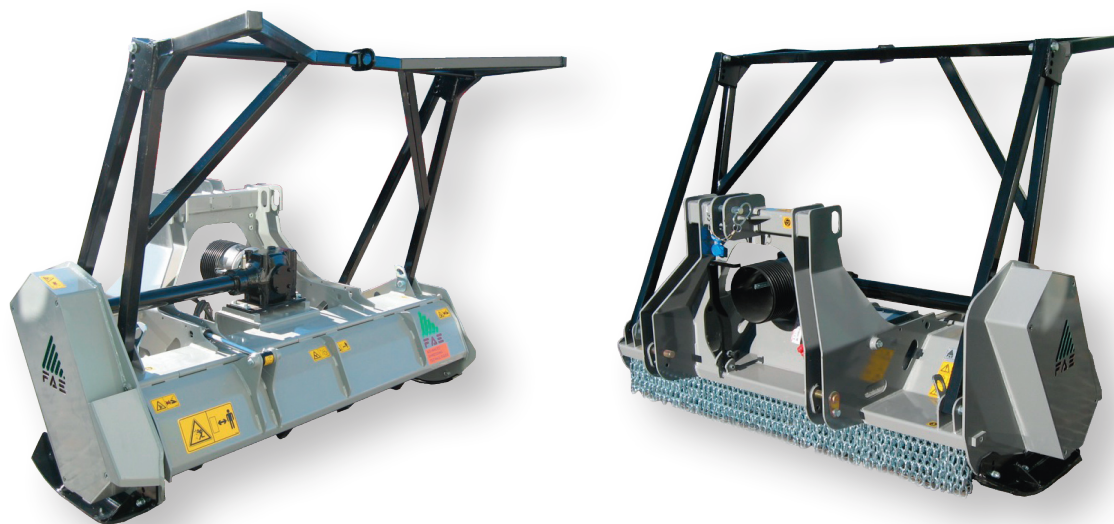

## FML/ST

Model	Tractor HP		PTO rpm	Working width inches	Overall width inches	Weight lbs	Grinding diameter inches (max)	Teeth q.ty/type FMM
	min	max						
FML/ST 125	50	100	540 o 1000	52	64	1808	8	20
FML/ST 150	60	110	540 o 1000	62	72	1951	8	24
FML/ST 175	70	110	540 o 1000	71	81	2094	8	28
FML/ST 200	80	110	540 o 1000	81	93	2238	8	32

*Data refers to the machine without options.*

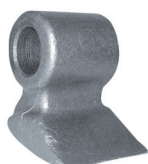

Hammer Type FMM