

MOLBOARD GATE INSTALL

ITEM NO.	Part Config	Description	Config	QTY.
1	035MG248	ASMBLY_SIDE_GATE_MOLDBOARD_MG30S		1
2	035MG252	WLDMNT_LUGGING_GATE_MOLDBOARD_MG30S		1
3	DYL66288	1.25" x 6.25" HITCH PIN		1

***SET CYLINDER RETRACT PRESSURE TO FULL SYSTEM PRESSURE**
***SET CYLINDER EXTEND PRESSURE TO 1500 PSI**

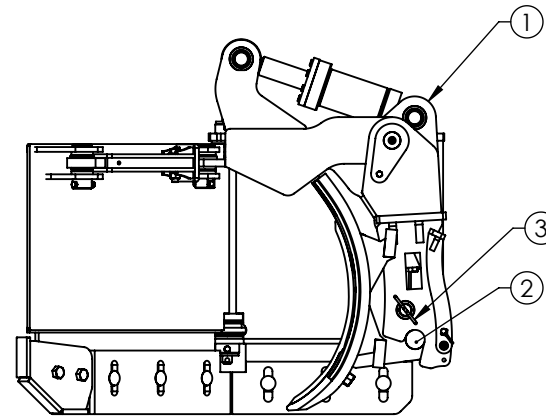
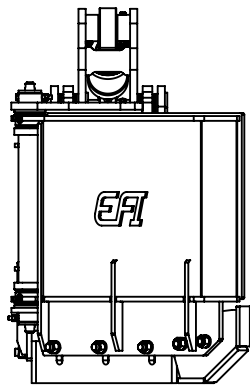
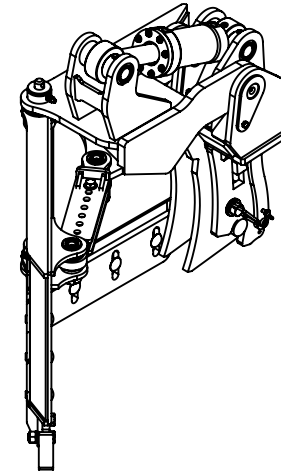
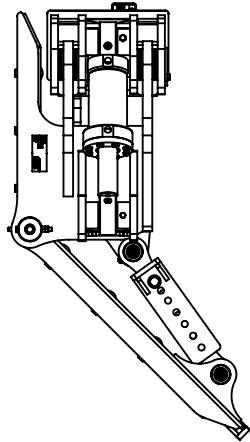

NOTICE OF CONFIDENTIALITY:
 INFORMATION INCLUDED IN THIS
 DRAWING IS PROPRIETARY, AND
 IS NOT TO BE REPRODUCED,
 DISTRIBUTED, OR DISCLOSED
 EXCEPT AS SPECIALLY
 AUTHORIZED IN WRITING BY
 ELLIS FABRICATIONS INC.

UNLESS NOTED OTHERWISE TOLERANCES ARE AS FOLLOWS: LINEAR : $\pm 1/16$ < 10'-0" HOLE CENTERS : $\pm .005$ " : $\pm 1/8$ < 20'-0" FORMING : $\pm .030$ " : $\pm 1/4$ > 20'-0" ANGULAR : $\pm .5$ " ***DO NOT SCALE DRAWING / DIMENSIONS ARE IN INCHES***		SCALE: 1:20 DATE: 30/06/2015 DWN: RRG	ELLIS FABRICATIONS INC. Box 1338, Red Deer, Alberta, T4N-7B6 DWG TITLE: ASMBLY_GATE_MOLDBOARD__MG30S	
WEIGHT: 3496.87 lbs	MATERIAL: WELDMENT	CHK: CHK	EFI SERIES: _MG30	EFI PRODUCT: MG Gate.Moldboard
CADD FILE: Z:\Design\Vault Files\Moldboard Gate\CAT 160M2 MOLDBOARD GATE\INSTALLATION DRAWING\		APPD: MAKE	EFI	CONFIG:
DATE PLOTTED:		SHEET 1 OF 3	PART NO: 035MG247	DWG NO: 035MG247-A

EXPLODED
VIEW

ITEM NO.	Part Config	Description	Config	QTY.
1	035MG248	ASMBLY_SIDE_GATE_MOLDBOARD__MG30S		1
2	035MG252	WLDMNT_LUGGING_GATE_MOLDBOARD__MG30S		1
3	DYL66288	1.25" x 6.25" HITCH PIN		1

***SET CYLINDER RETRACT PRESSURE TO FULL SYSTEM PRESSURE**
***SET CYLINDER EXTEND PRESSURE TO 1500 PSI**

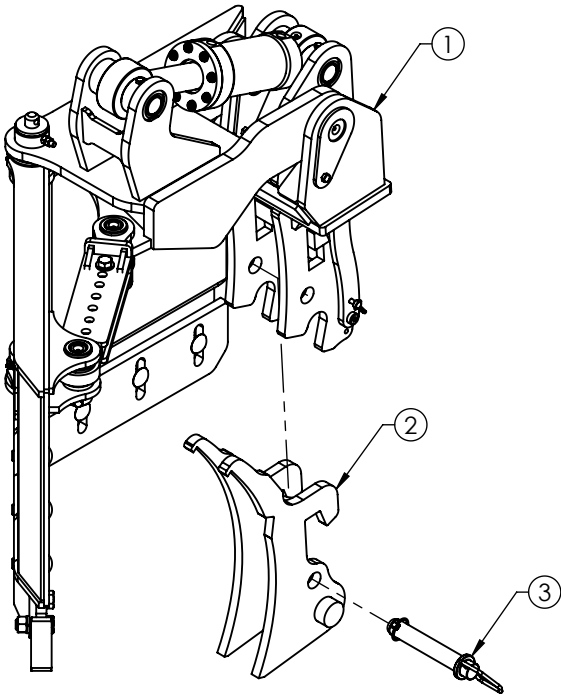
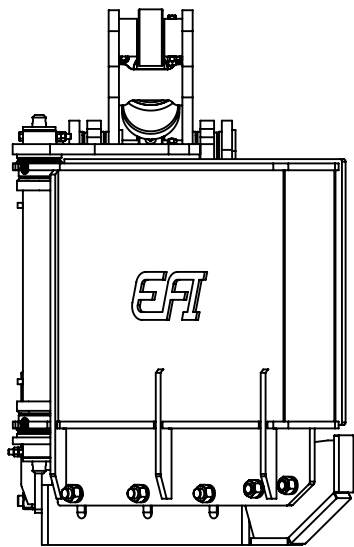

NOTICE OF CONFIDENTIALITY:
INFORMATION INCLUDED IN THIS
DRAWING IS PROPRIETARY, AND
IS NOT TO BE REPRODUCED,
DISTRIBUTED, OR DISCLOSED
EXCEPT AS SPECIALLY
AUTHORIZED IN WRITING BY
ELLIS FABRICATIONS INC.

UNLESS NOTED OTHERWISE TOLERANCES ARE AS FOLLOWS: LINEAR : $\pm 1/16$ < 10'-0" HOLE CENTERS : $\pm .005$ " : $\pm 1/8$ < 20'-0" FORMING : $\pm .030$ " : $\pm 1/4$ > 20'-0" ANGULAR : $\pm .5$ "		SCALE: 1:14	ELLIS FABRICATIONS INC. Box 1338, Red Deer, Alberta, T4N-7B6	
DO NOT SCALE DRAWING / DIMENSIONS ARE IN INCHES		DATE: 30/06/2015		
WEIGHT: 3496.87 lbs	MATERIAL: WELDMENT	CHK: CHK	DWG TITLE: ASMBLY_GATE_MOLDBOARD__MG30S	
CADD FILE: Z:\Design\Vault Files\Moldboard Gate\CAT 160M2 MOLDBOARD GATE\INSTALLATION DRAWING\		APPR: RRG	EFI SERIES: _MG30	EFI PRODUCT: MG Gate.Moldboard
DATE PLOTTED:		MAKE: EFI	CONFIG:	
SHEET 2 OF 3		PART NO: 035MG247	DWG NO: 035MG247-A	REV A

LUGGING WLDMNT INSTALL

ITEM NO.	Part Config	Description	Config	QTY.
2	035MG252	WLDMNT_LUGGING_GATE_MOLDBOARD__MG30S		1

LUG WILL HOOK OVER TOP OF MOLDBOARD
TO SET HEIGHT

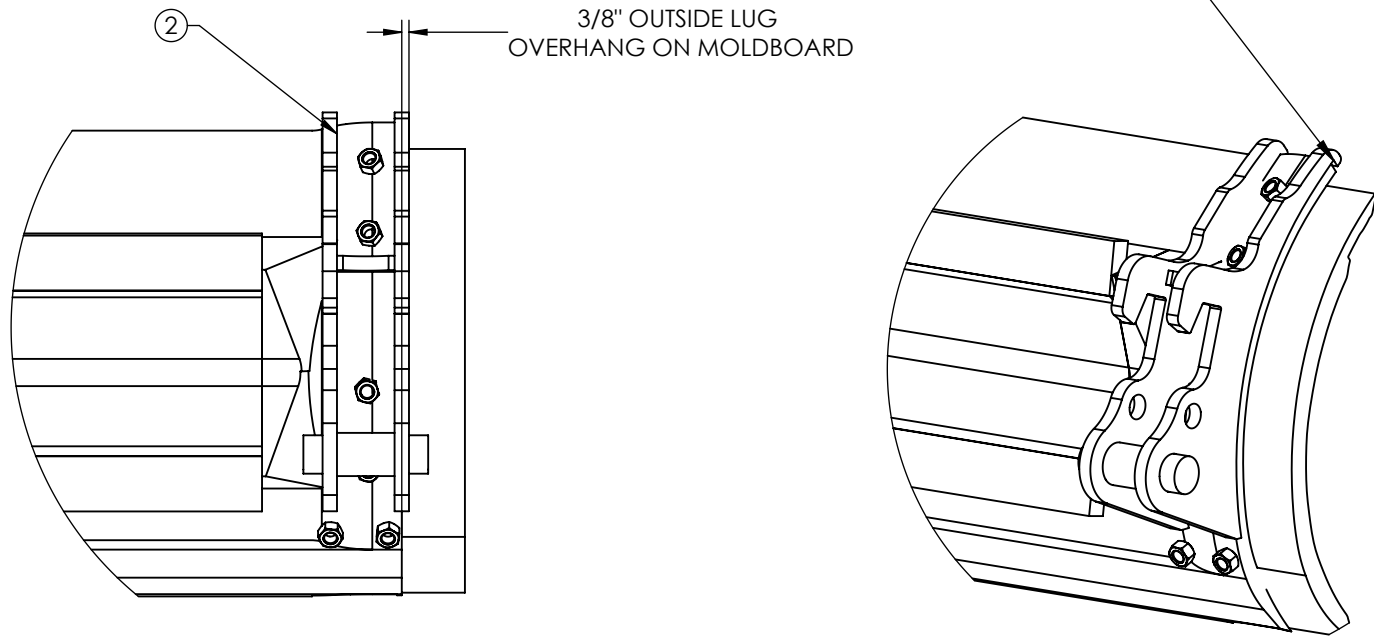

NOTICE OF CONFIDENTIALITY:
INFORMATION INCLUDED IN THIS
DRAWING IS PROPRIETARY, AND
IS NOT TO BE REPRODUCED,
DISTRIBUTED, OR DISCLOSED
EXCEPT AS SPECIALLY
AUTHORIZED IN WRITING BY
ELLIS FABRICATIONS INC.

UNLESS NOTED OTHERWISE TOLERANCES ARE AS FOLLOWS: LINEAR : $\pm 1/16$ < 10'-0" HOLE CENTERS : $\pm .005$ " : $\pm 1/8$ < 20'-0" FORMING : $\pm .030$ " : $\pm 1/4$ > 20'-0" ANGULAR : $\pm .5$ " ***DO NOT SCALE DRAWING / DIMENSIONS ARE IN INCHES***		SCALE: 1:14 DATE: 30/06/2015 DWN: RRG	ELLIS FABRICATIONS INC. Box 1338, Red Deer, Alberta, T4N-7B6	
WEIGHT: 3496.87 lbs	MATERIAL: WELDMNT	CHK: CHK	EFI SERIES: _MG30	EFI PRODUCT: MG Gate.Moldboard
CADD FILE: Z:\Design\Vault Files\Moldboard Gate\CAT 160M2 MOLDBOARD GATE INSTALLATION.DWG\		APPR: [blank]	MAKE: EFI	CONFIG: [blank]
DATE PLOTTED: [blank]		SHEET 3 OF 3	PART NO: 035MG247	DWG NO: 035MG247-A
				REV A